

PROFILE SUBMITTED
 PLOTTED CHECKED
 NOTE BOOK BAW NOTED
 NO. STRUCTURE NOTATIONS CHRD

F.A.I. RTE.	SECTION	COUNTY	TOTAL SHEETS	SHEET NO.
94	88+60 (SB I-57) TO STA. 1313+00 (SB RYAN)	COOK	764	584
126+91 (SB FORD)	ILLINOIS FED. AID PROJECT			
FED. ROAD DIST. NO. (1516.1, 1717, & 1818) R-5				62593

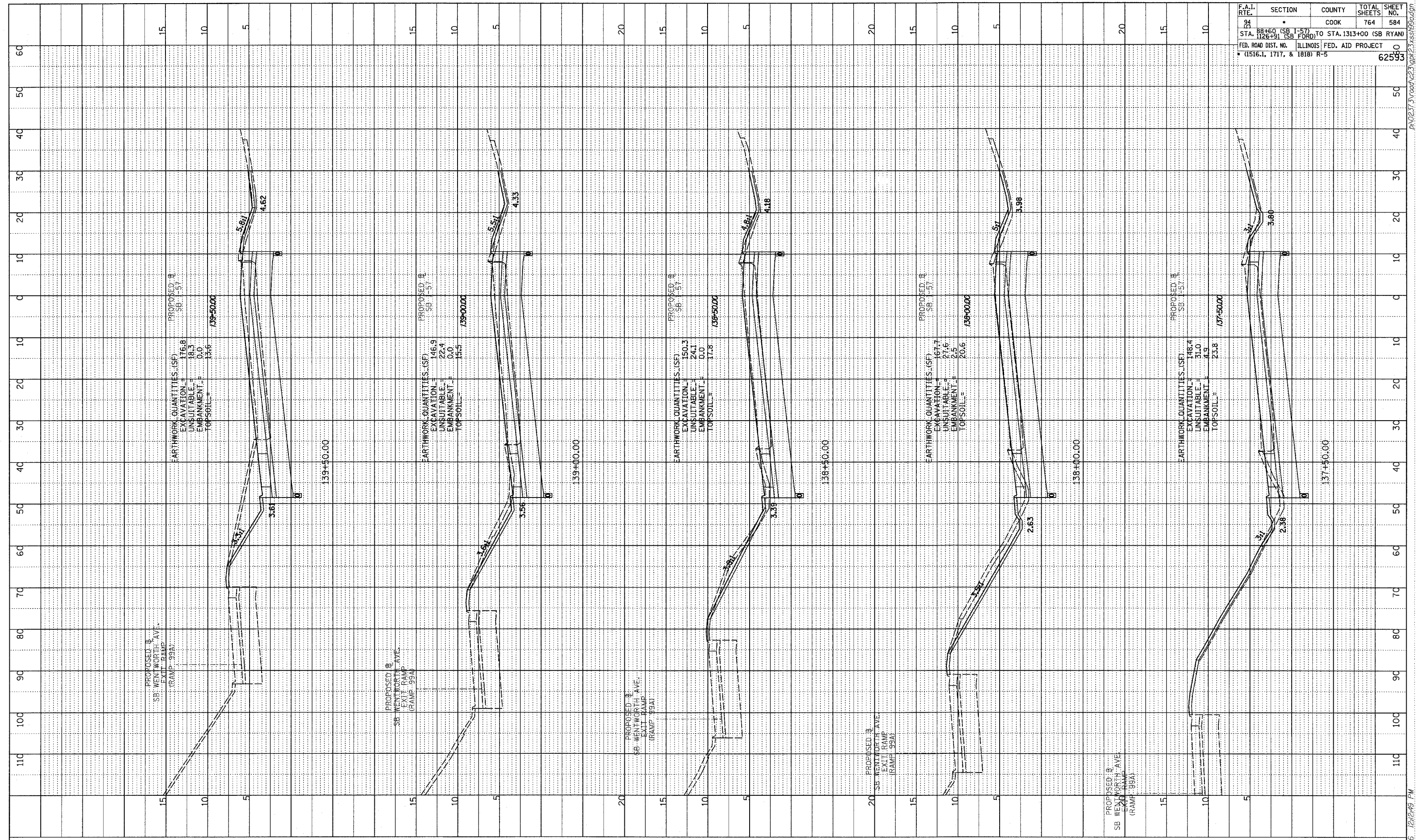

TYLIN INTERNATIONAL

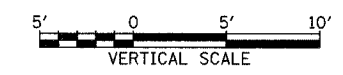
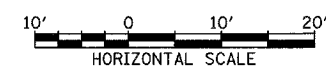

I-57 SOUTHBOUND
 STA. 137+50 TO STA. 139+50

02/21/2006 12:49 PM P:\0231\road\23\gpk2\3\ss19\9a.dgn