

PROFILE SURVEYED
 PLOTTED CHECKED
 NOTE BOOK DRAWN BY
 NO. STRUCTURE NOTATIONS OTHER

F.A.I. RTE.	SECTION	COUNTY	TOTAL SHEETS	SHEET NO.
94	88+60 (SB I-57) TO STA. 1126+91 (SB FORD)	COOK	764	587
FED. ROAD DIST. NO. ILLINOIS FED. AID PROJECT				
* (1516.1, 1717, & 1818) R-5				
				62593

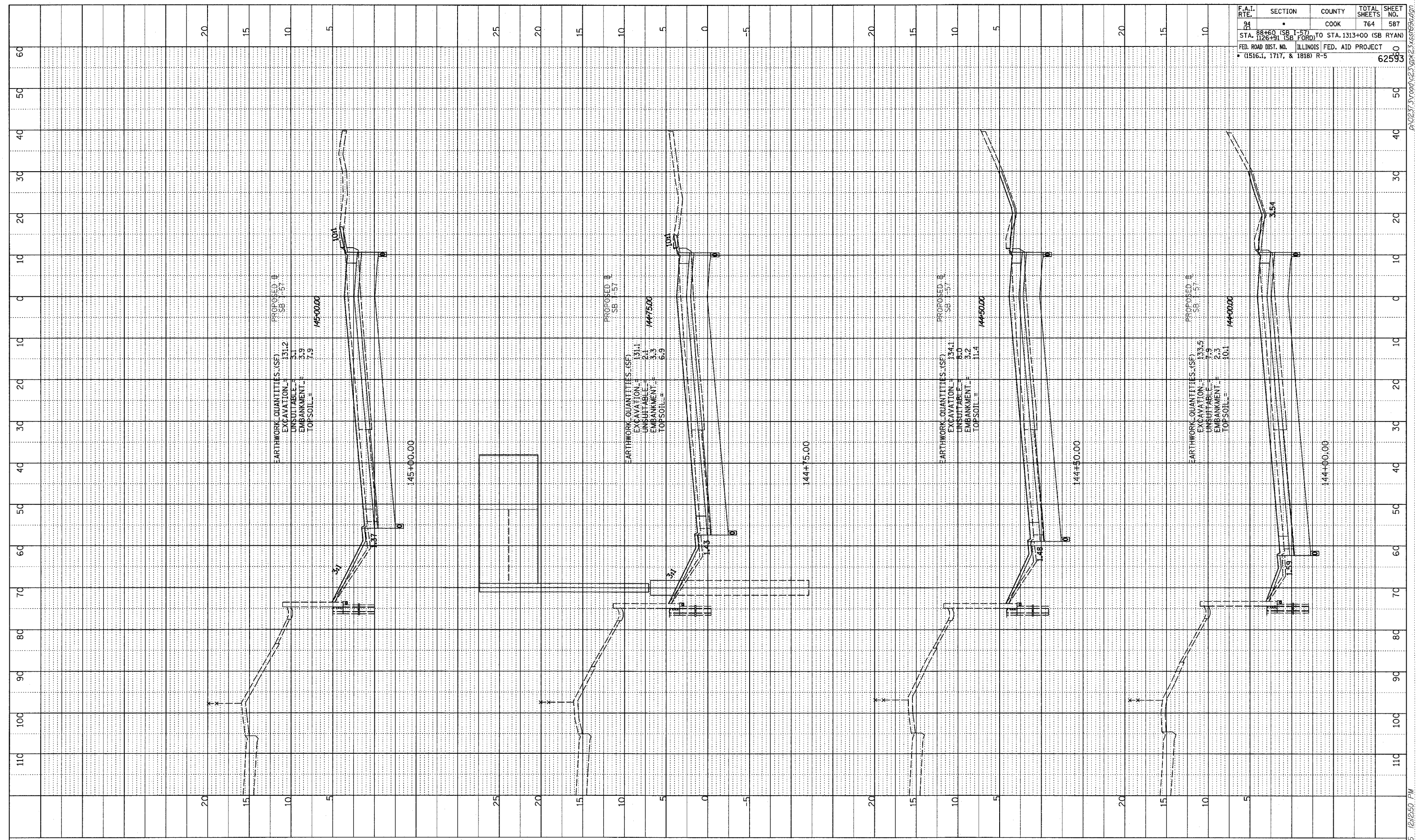

TYLIN INTERNATIONAL

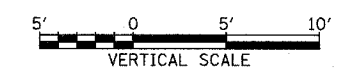
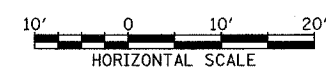

I-57 SOUTHBOUND
 STA. 144+00 TO STA. 145+00

02/27/2006 12:22:50 PM