

DATE: _____
 PROFILE SUBMITTED: _____
 PLOTTED: _____
 NOTE BOOK: _____
 NO. _____
 STRUCTURE NOTATIONS CHFD

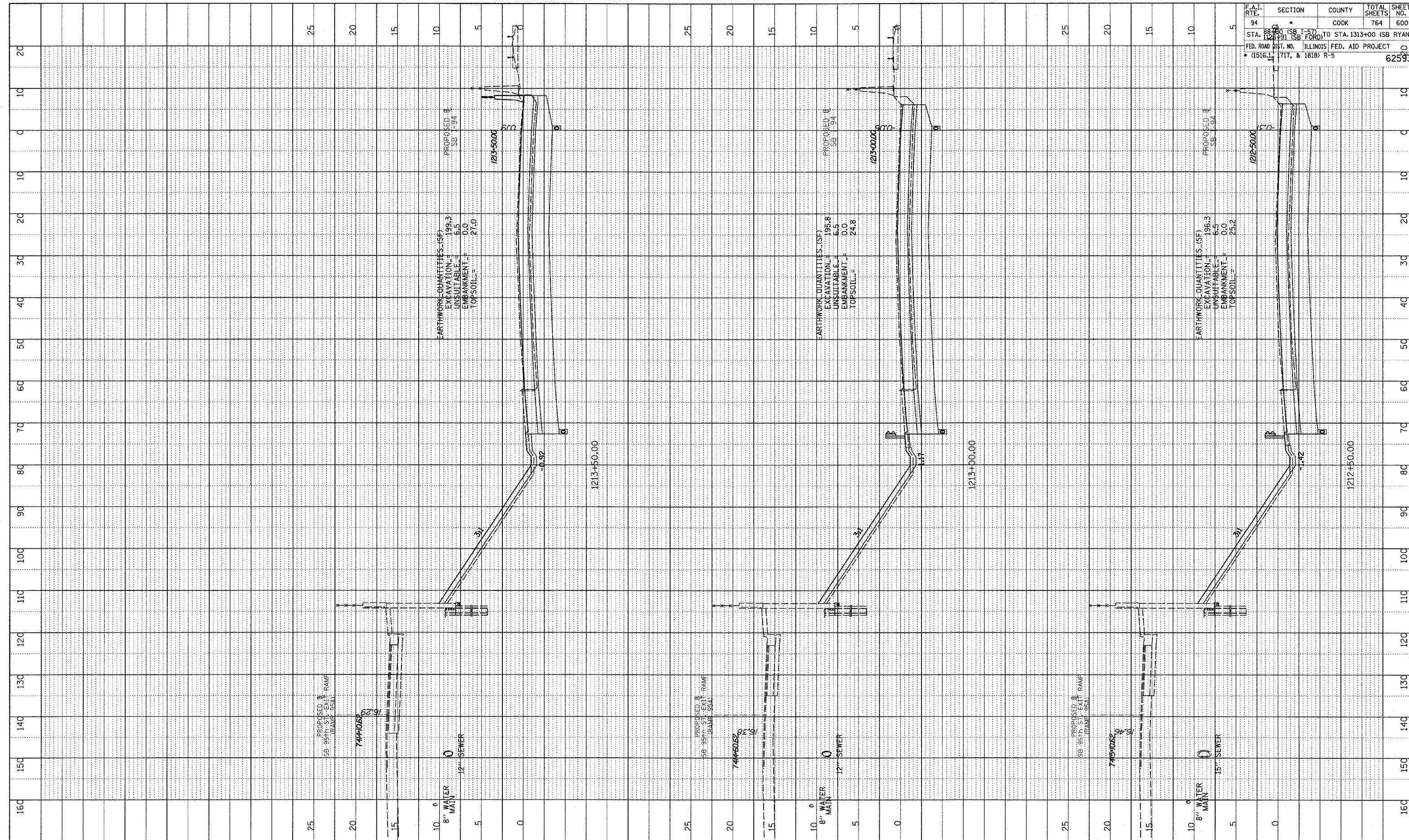

F.A.I. RTE.	SECTION	COUNTY	TOTAL SHEETS	SHEET NO.
94	1717, & 1818	COOK	764	600

STA. 1212+50 (SB FORD) TO STA. 1313+00 (SB RYAN)
 FED. ROAD DIST. NO. ILLINOIS FED. AID PROJECT
 (1516, 1717, & 1818) R-5

02/21/2006 12:30:27 PM

TYLIN INTERNATIONAL

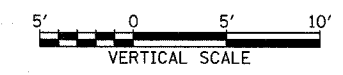
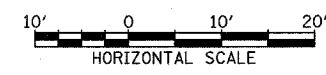

I-94 SOUTHBOUND (DAN RYAN EXPWY)
 STA. 1212+50 TO STA. 1213+50