

PROFILE SURVEYED DATE
 PLOTTED BY
 NOTE BOOK NO. DATE
 STRUCTURE NOTATION CHKD

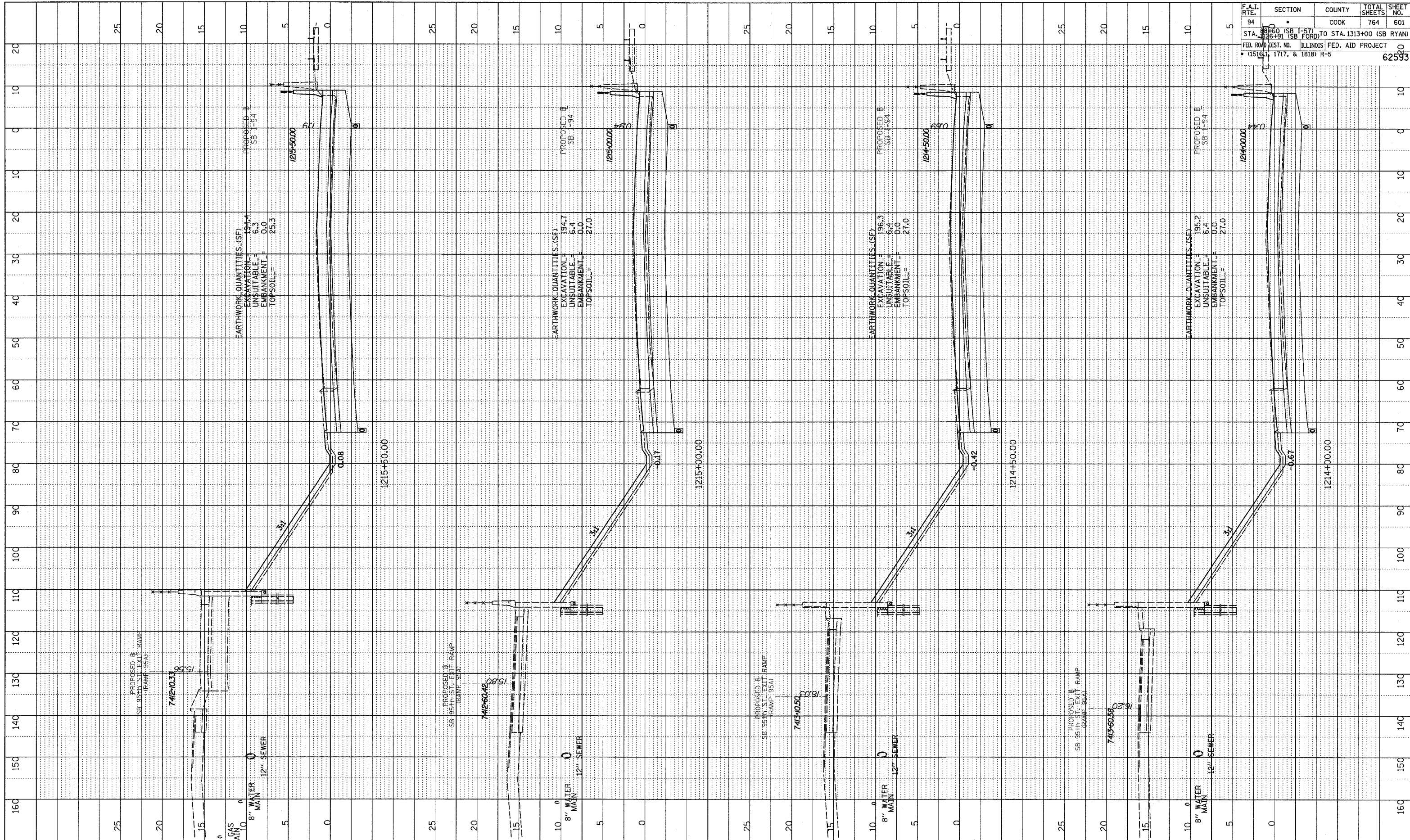

F.A.I. RTE.	SECTION	COUNTY	TOTAL SHEETS	SHEET NO.
94	1214+00 (SB FORD) TO STA. 1313+00 (SB RYAN)	COOK	764	601
FED. ROAD DIST. NO. ILLINOIS FED. AID PROJECT				
• (1516), 1717, & 1818) R-5				
				62593

TYLIN INTERNATIONAL

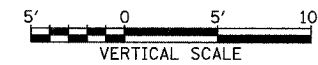

I-94 SOUTHBOUND (DAN RYAN EXPWY)
 STA. 1214+00 TO STA. 1215+50

02/21/2006 12:50:3 PM