

PROFILE SURVEYED  
 PLOTTED  
 CHECKED  
 DATE  
 NOTE BOOK  
 E.A.M. NOTED  
 NO. \_\_\_\_\_  
 STRUCTURE NOTATIONS: CPWD

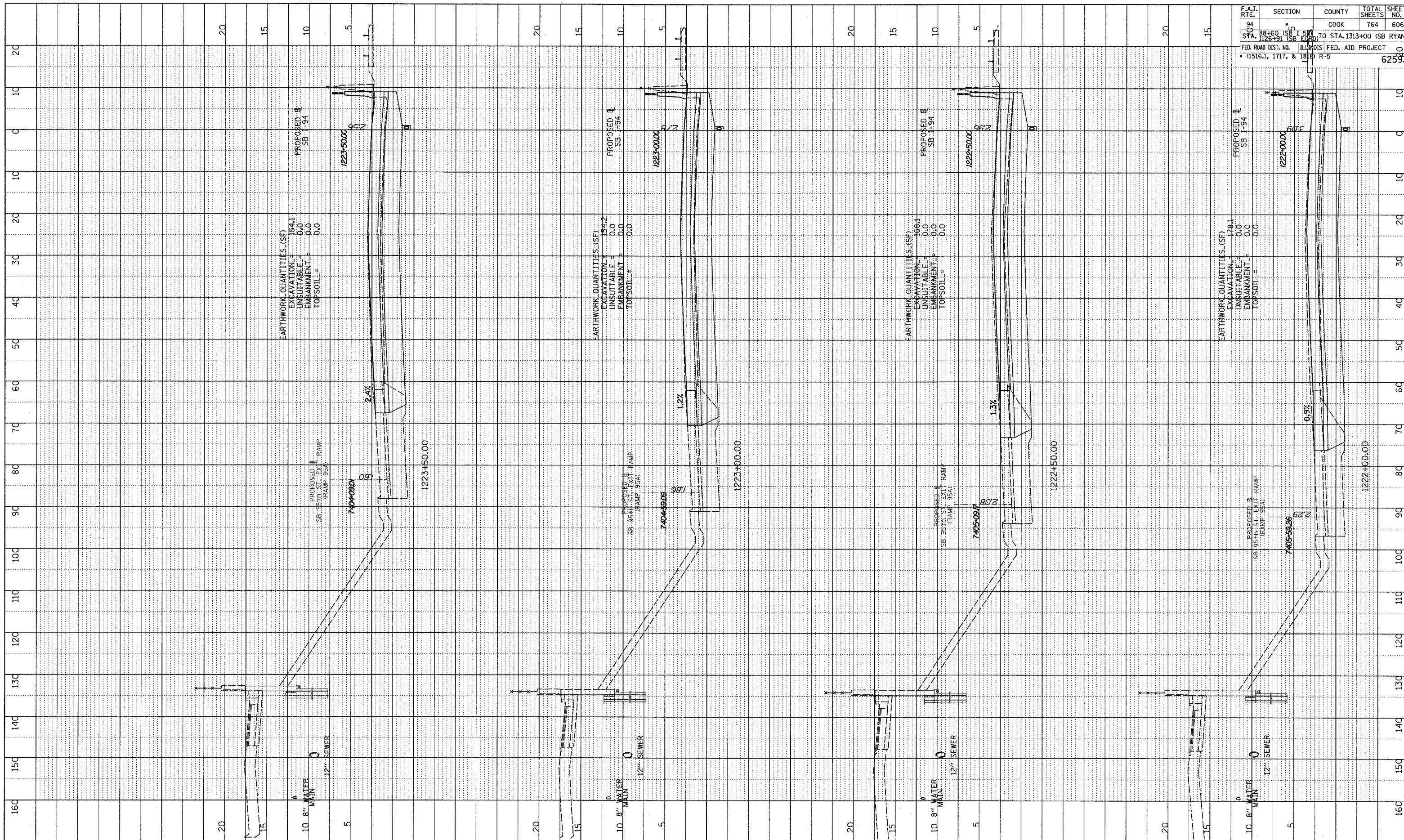

F.A.I. RTE.	SECTION	COUNTY	TOTAL SHEETS	SHEET NO.
94	88+60 (SB) TO STA. 1313+00 (SB RYAN)	COOK	764	606
STA. 1222+91 (SB) TO STA. 1223+00 (SB RYAN)				
FED. ROAD DIST. NO. ILLINOIS FED. AID PROJECT				
• (1516.1, 1717, & 1818) R-5				
				62593

TYLIN INTERNATIONAL

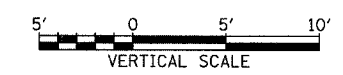
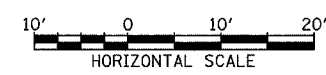

I-94 SOUTHBOUND (DAN RYAN EXPWY)  
 STA. 1222+00 TO STA. 1223+50

02/27/2006 12:30:05 PM P:\02313\road\023\gpk23\ss\95a.dgn