

PROFILE SURVEYED _____
 PLOTTED CHECKED _____
 NOTE BOOK _____
 NO. _____
 STRUCTURE NOTATION CHRG _____

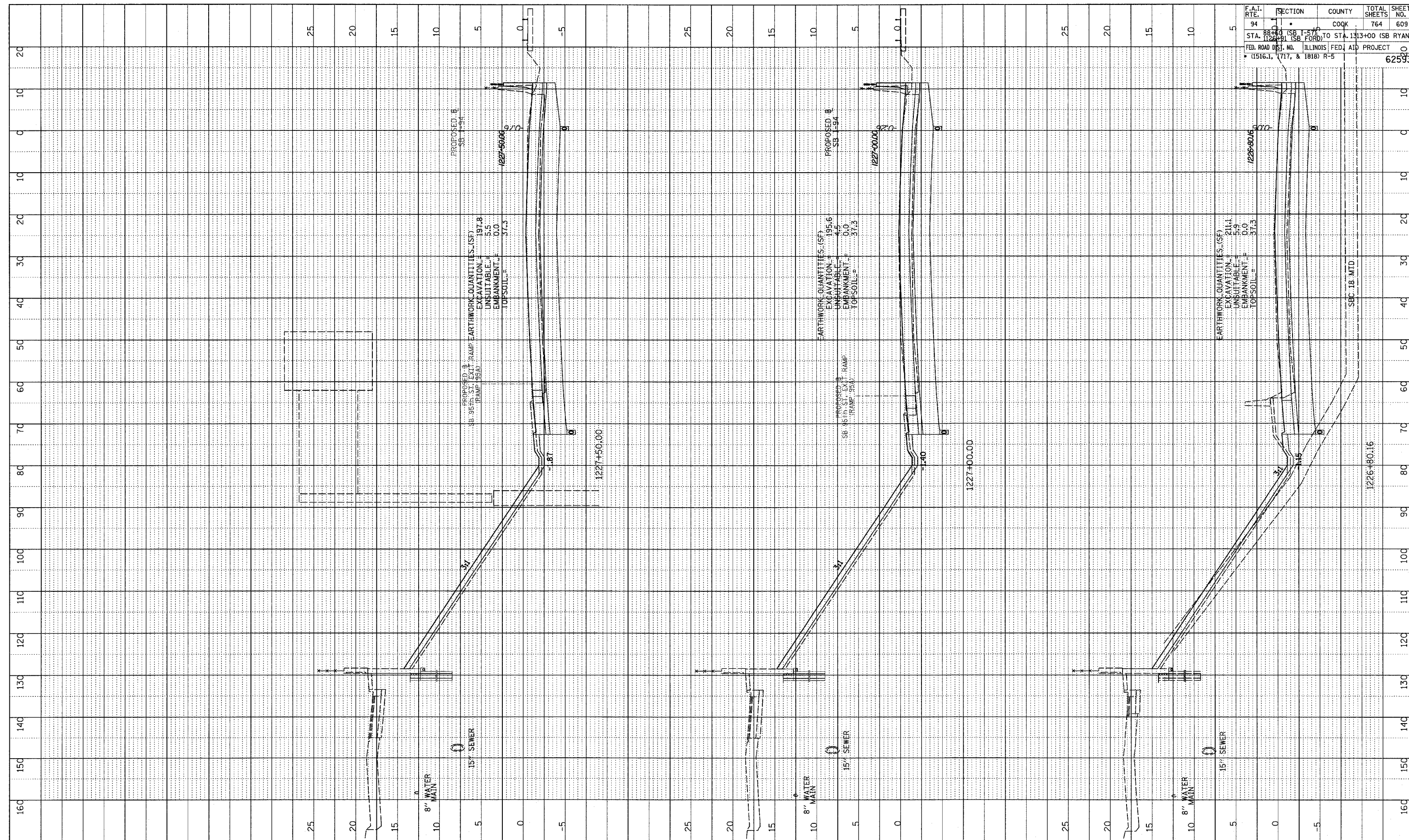

F.A.I. RTE.	SECTION	COUNTY	TOTAL SHEETS	SHEET NO.
94	SB 1-577	COOK	764	609
STA. 1226+80.16 (SB FORD) TO STA. 1313+00 (SB RYAN)				
FED. ROAD DIST. NO. ILLINOIS FED. AID PROJECT				
• (1516.1, 1717, & 1818) R-5				
				62593

TYLIN INTERNATIONAL

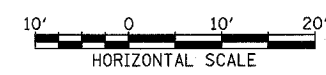

I-94 SOUTHBOUND (DAN RYAN EXPWY)
 STA. 1226+80.16 TO STA. 1227+50

P:\02373\road\c23\gpk23\ss\1850.dgn
 02/27/2006 12:35:06 PM