

PROFILE SURVEYED
 PLOTTED
 NOTE BOOK
 NO.

F.A.I. RTE.	SECTION	COUNTY	TOTAL SHEETS	SHEET NO.
94	88+60 (SB FORD) TO STA. 1313+00 (SB RYAN)	COOK	764	630
FED. ROAD DIST. NO. ILLINOIS FED. AID PROJECT				62593
* (1516.1, 1717, & 1818) R-5				

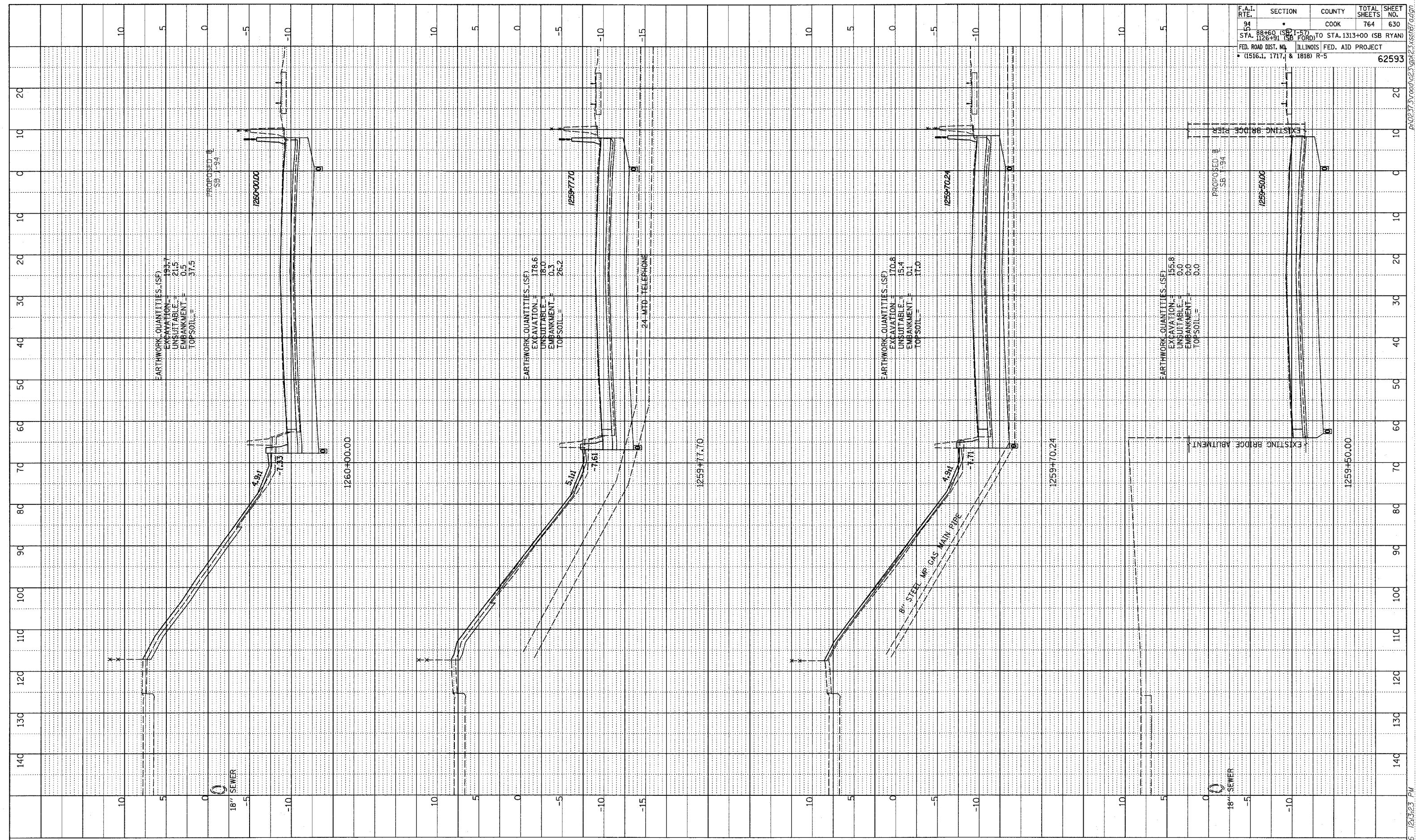

TYLIN INTERNATIONAL

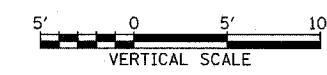
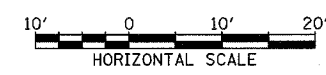

I-94 SOUTHBOUND (DAN RYAN EXPWY)
 STA. 1259+50 TO STA. 1260+00

02/27/2006 12:52:23 PM p:\02373\000\023\pk23\ss187a.dgn