

SURVEYED
 GRADES CHECKED
 B.M. NOTED
 STRUCTURE NOTATIONS OK'D
 NO.

F.A.I. RTE.	SECTION	COUNTY	TOTAL SHEETS	SHEET NO.
94	88+60 (SB I-57) TO STA. 126+91 (SB FORD)	COOK	764	631
FED. ROAD DIST. NO. ILLINOIS FED. AID PROJECT				62593
(1516.1, 1717, & 1818) R-5				

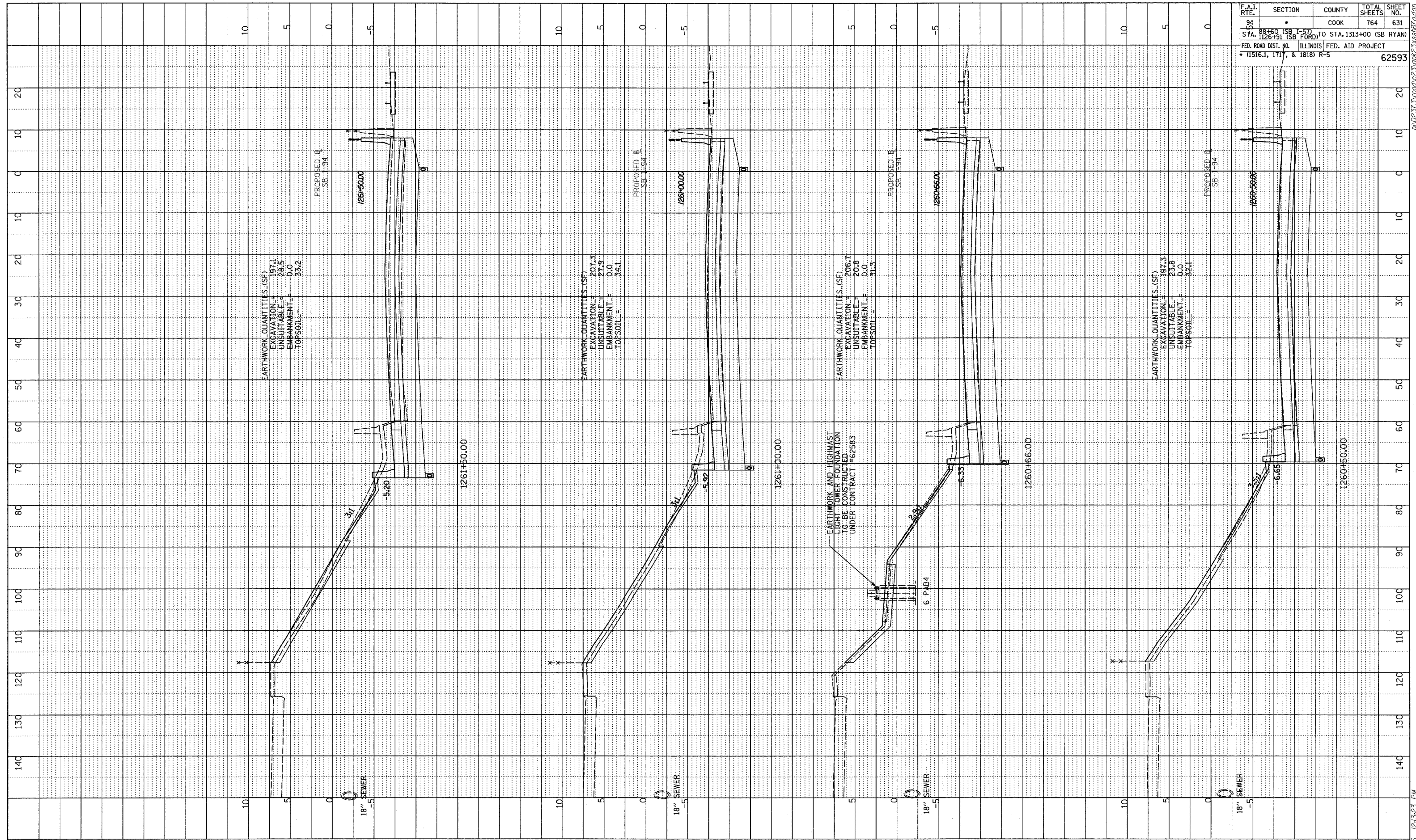

TYLIN INTERNATIONAL

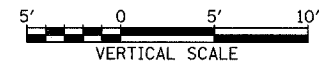
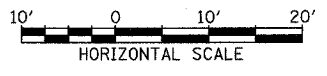

I-94 SOUTHBOUND (DAN RYAN EXPWY)
 STA. 1260+50 TO STA. 1261+50

02/27/2006 12:33:23 PM