

DATE	
BT	
PROFILE SURVEYED	
PLOTTED/REVISION	
NOTE BOOK	
NO.	
STRUCTURE NOTATIONS CHECKED	

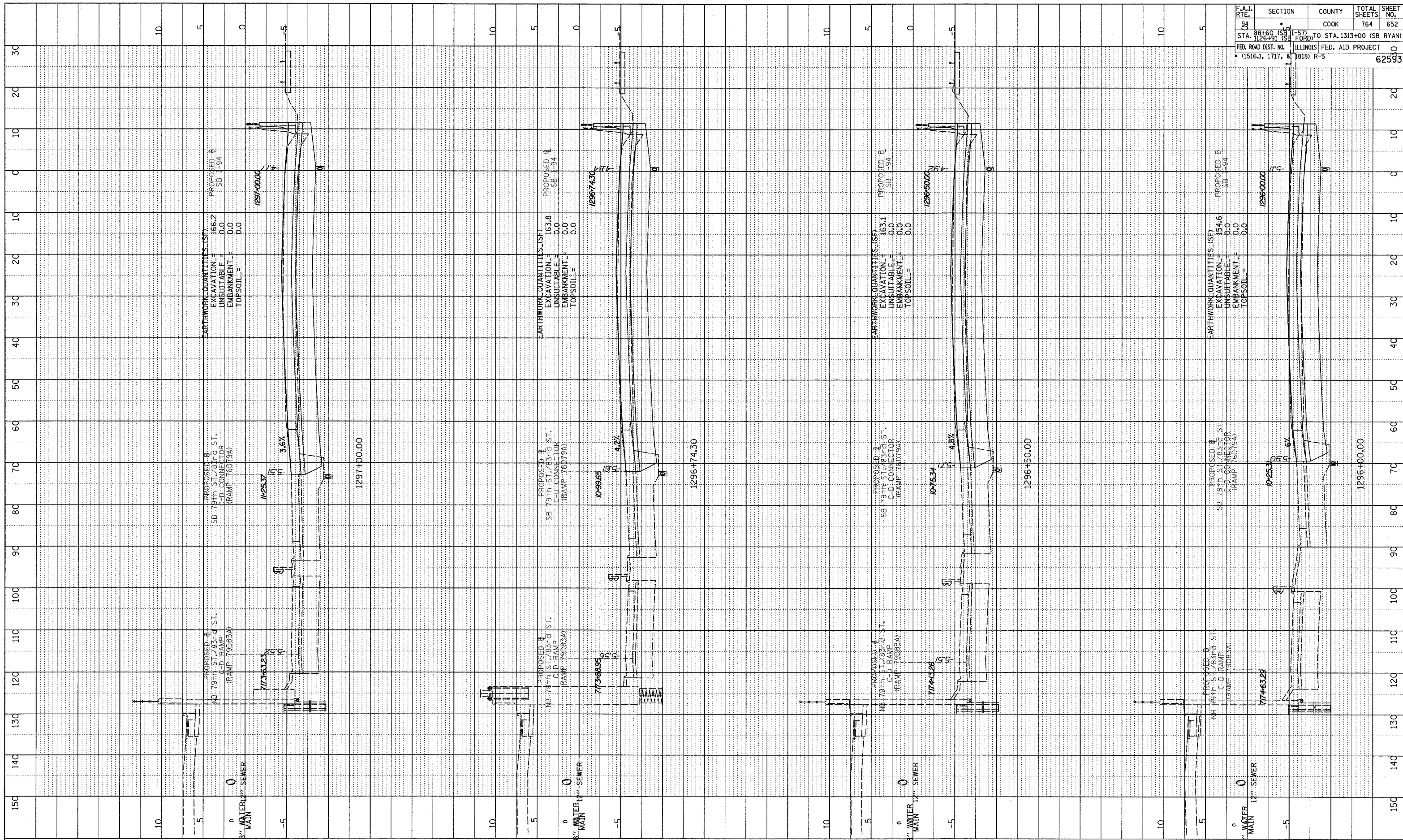

F.A.I. RTE.	SECTION	COUNTY	TOTAL SHEETS	SHEET NO.
94	1296+00 (SB FORD) TO STA. 1313+00 (SB RYAN)	COOK	764	652
FED. ROAD DIST. NO. 111			ILLINOIS FED. AID PROJECT	
1516.1, 1717, & 1818			R-5	
				62593

TYLIN INTERNATIONAL

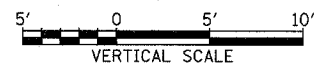
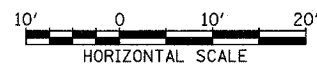

I-94 SOUTHBOUND (DAN RYAN EXPWY)  
STA. 1296+00 TO STA. 1297+00

02/27/2006 12:35:36 PM P:\0227\3\road\vol2\mapk23\ssb17993.dgn