

PROFILE SURVEYED  
 PLOTTED  
 CHECKED  
 NOTE BOOK  
 NO. STRUCTURE NOTATIONS CIRCD

F.A.I. RTE.	SECTION	COUNTY	TOTAL SHEETS	SHEET NO.
94		COOK	764	660
STA. 88+60 (SB I-57)				
TO STA. 1126+91 (SB FORD)				
TO STA. 1313+00 (SB RYAN)				
FED. ROAD DIST. NO.	ILLINOIS FED. AID PROJECT			
(1516.1, 1717, & 1818) R-5				62593

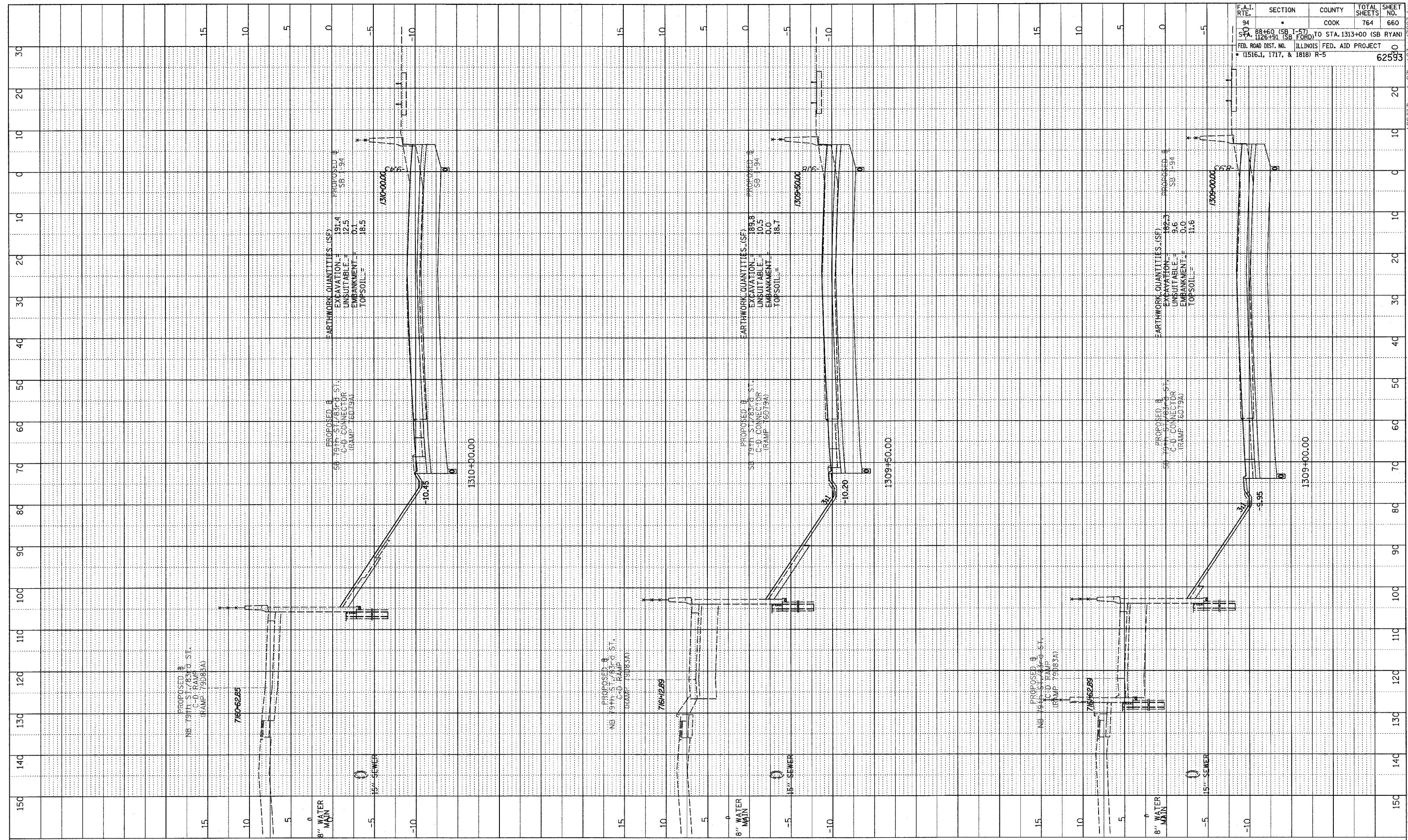

TYLIN INTERNATIONAL

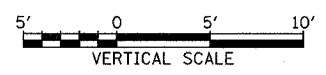
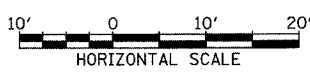

I-94 SOUTHBOUND (DAN RYAN EXPWY)  
 STA. 1309+00 TO STA. 1310+00

02/21/2006 12:13:42 PM P:\0227\3\road\023\gsm\23\sheet\93.dgn