

PROFILE SURVEYED
 PLOTTED, CHECKED
 NOTE BOOK
 NO. _____
 STRUCTURE NOTATIONS CIPD

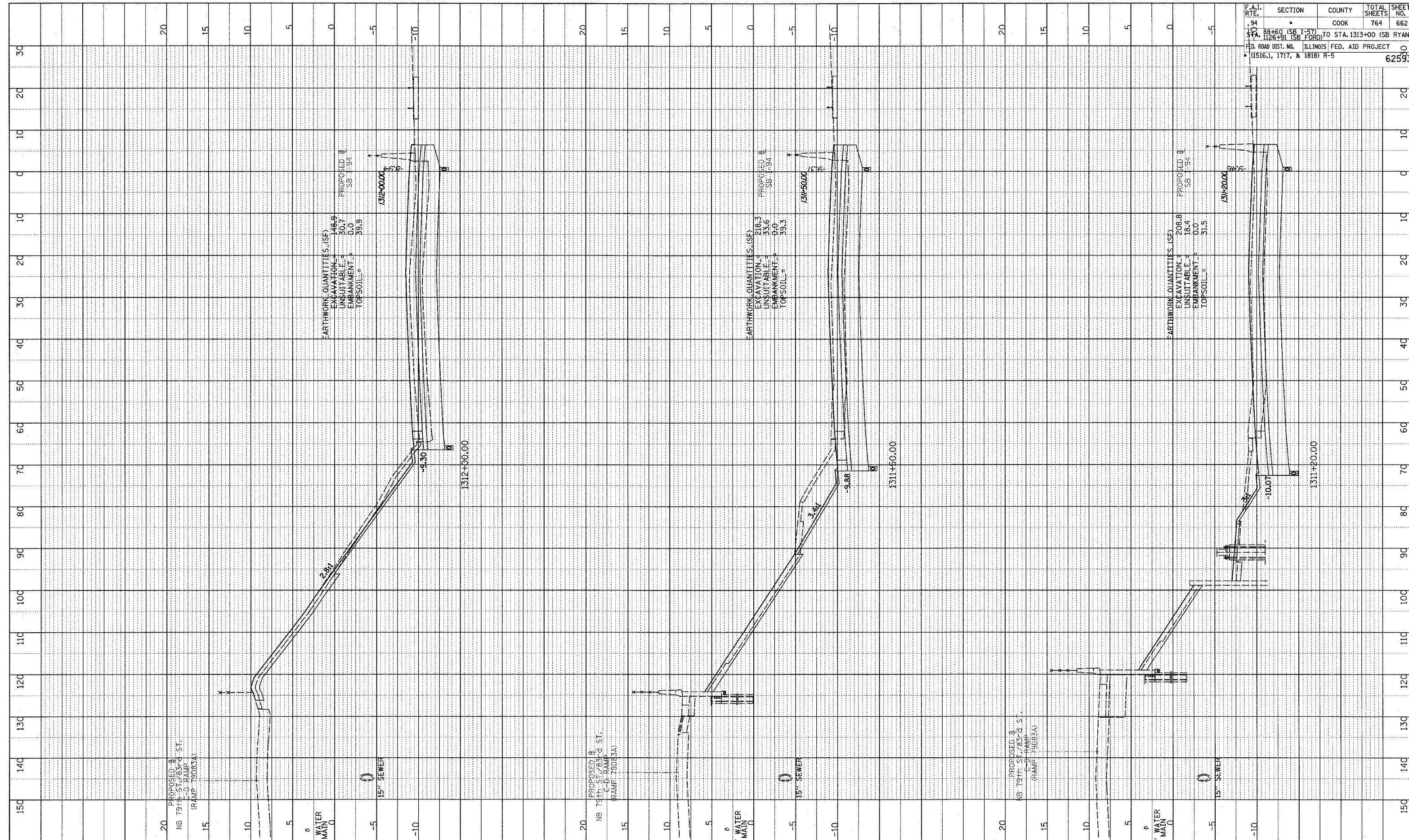

F.A.I. RTE.	SECTION	COUNTY	TOTAL SHEETS	SHEET NO.
194	88+60 (SB I-57) TO STA. 1313+00 (SB RYAN)	COOK	764	662
126+91 (SB FORD)				
FED. ROAD DIST. NO. ILLINOIS FED. AID PROJECT				
(1516.1, 1717, & 1818) R-5				
				62593

TYLIN INTERNATIONAL

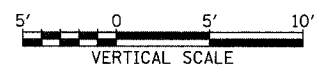
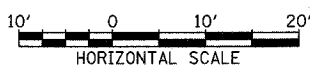

I-94 SOUTHBOUND (DAN RYAN EXPWY)
 STA. 1311+20 TO STA. 1312+00

02/27/2006 12:34:3 PM