

PROFILE SURVEYED  
 PLOTTED REVISIONS  
 NO. BOOK EAM NOTED  
 NO. STRUCTURE NOTATIONS CHFD

F.A.I. RTE.	SECTION	COUNTY	TOTAL SHEETS	SHEET NO.
94	•	COOK	764	673
STA. 1126+91	(SB FORD) TO STA. 1313+00 (SB RYAN)			
FED. ROAD DIST. NO. ILLINOIS FED. AID PROJECT				62593
(1516.1, 1717, & 1818) R-5				

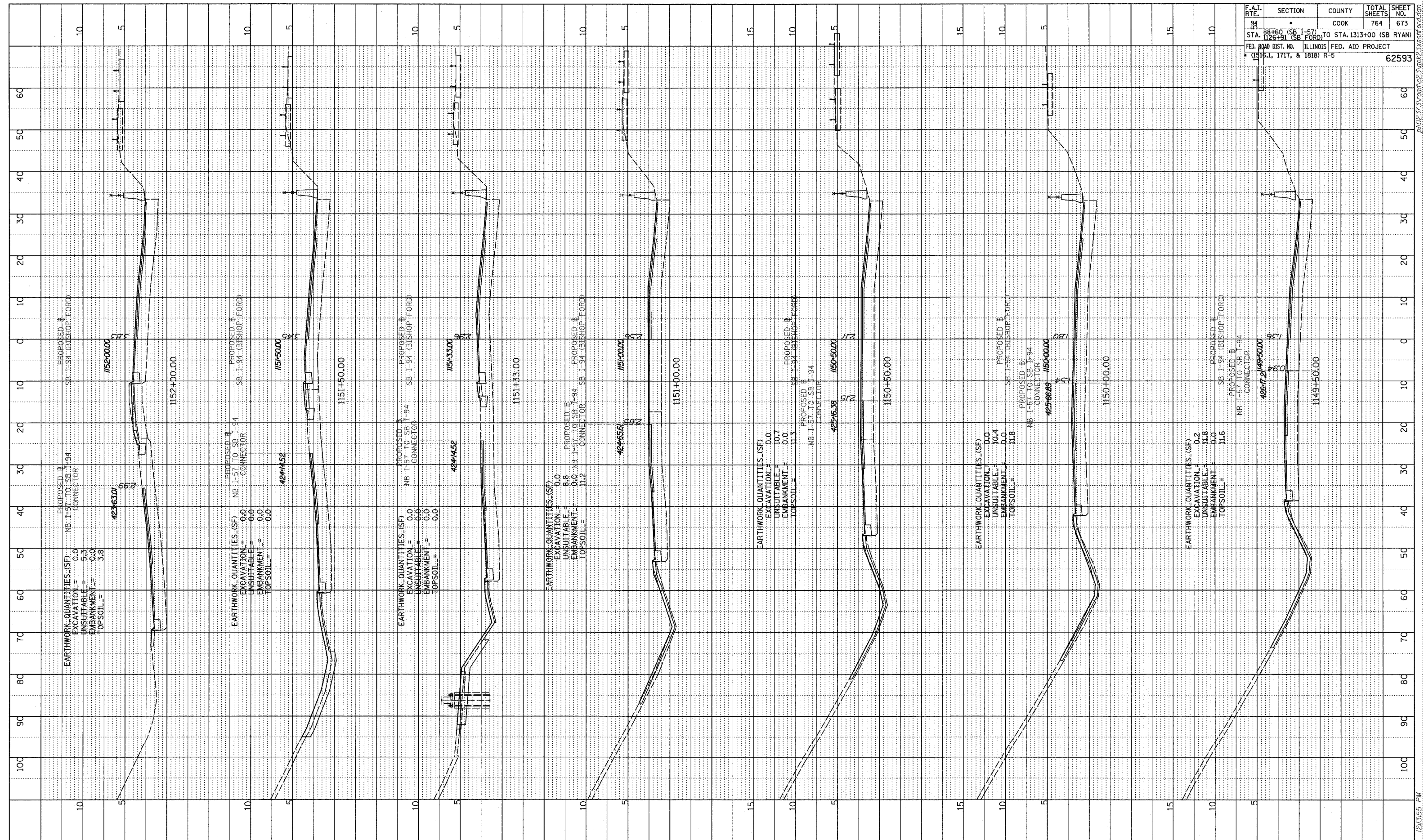

TYLINT INTERNATIONAL

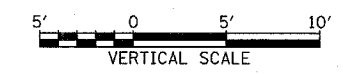

I-94 SOUTHBOUND (BISHOP FORD FWY)  
 STA. 1149+50 TO STA. 1152+00

02/27/2006 12:55:55 PM P:\02313\road\2313\gk\2313\ssit.dwg