

PROF FILE SURVEYED
 NOTE BOOK GRADES CHECKED
 NO. E.M. NOTED
 STRUCTURE NOTATIVE CROSS

F.A.I. RTE.	SECTION	COUNTY	TOTAL SHEETS	SHEET NO.
94	SB I-94	COOK	764	679
STA. 1126+00 (SB FORD) TO STA. 1313+00 (SB RYAN)				
FED. ROAD DIST. NO. 1 ILLINOIS FED. AID PROJECT				
* (1516.1, 1717, & 1818) R-5				
				62593

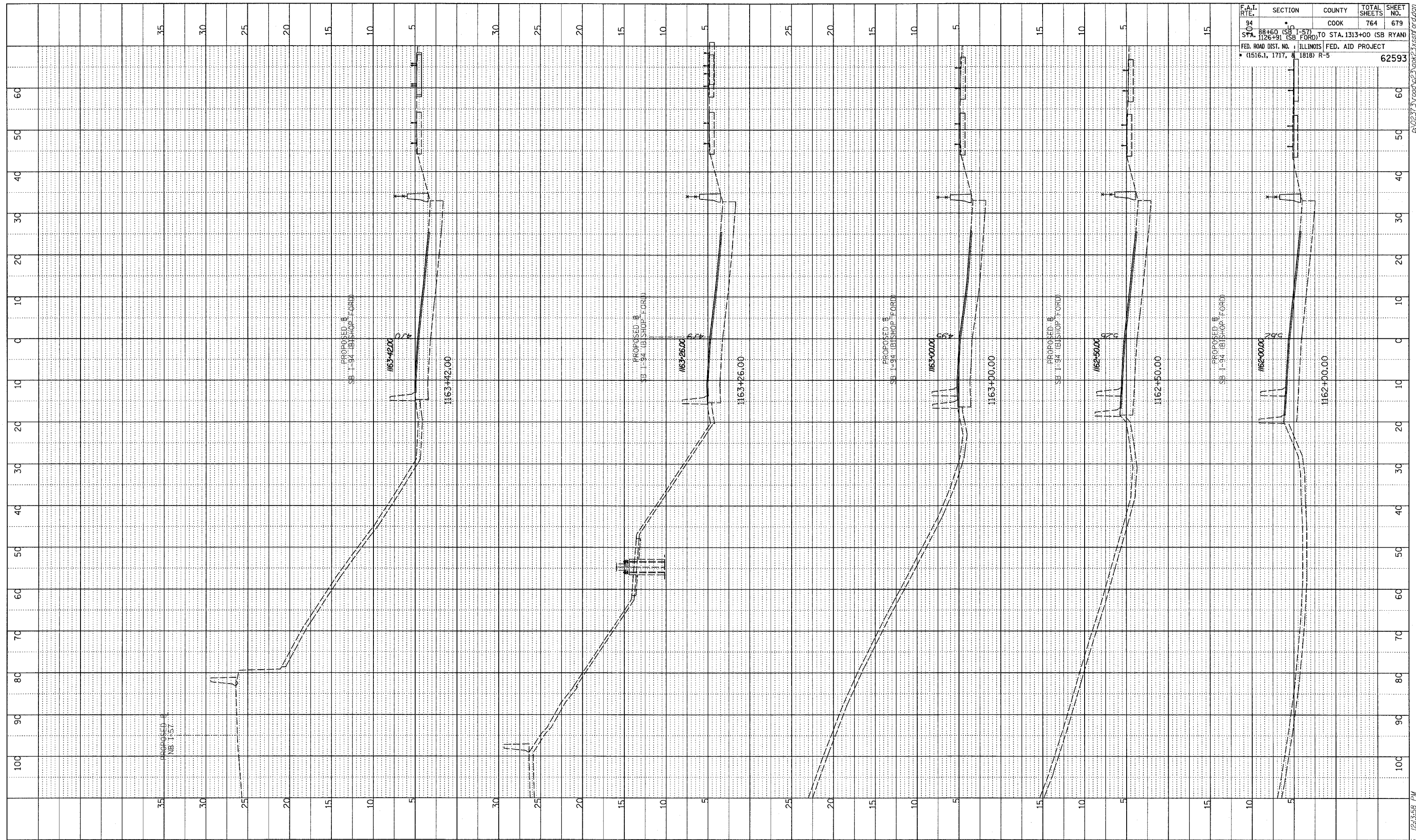

TYLIN INTERNATIONAL

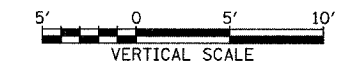
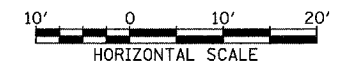

I-94 SOUTHBOUND (BISHOP FORD FWY)
 STA. 1162+00 TO STA. 1163+42

02/27/2006 12:43:58 PM