

PLAN SURVEYED BY DATE  
 ALIGNED BY  
 CHECKED BY  
 NOTE BOOK NO. FILE NAME

PLAN SURVEYED BY DATE  
 ALIGNED BY  
 CHECKED BY  
 NOTE BOOK NO. FILE NAME

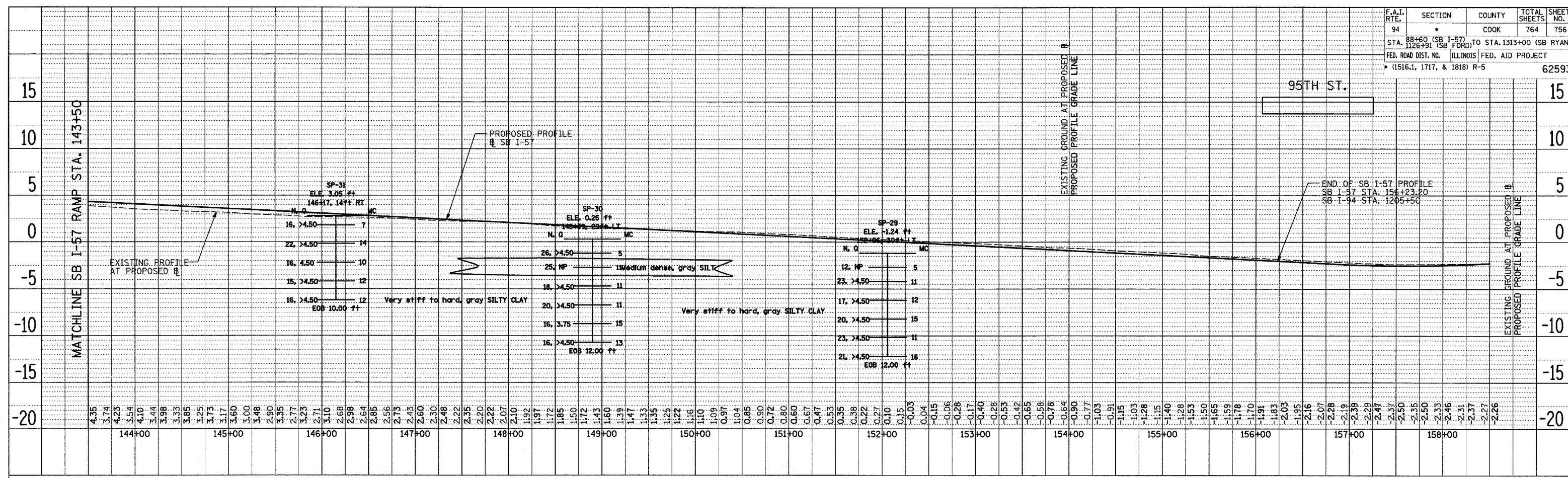

SB I-57

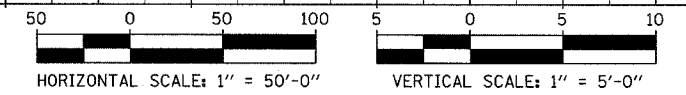

REVISIONS	
NAME	DATE

ILLINOIS DEPARTMENT OF TRANSPORTATION  
 F.A.I. 94 (DAN RYAN EXPRESSWAY)

SOIL BORING PROFILES  
 SB I-57 - SHEET 3 OF 3  
 SB I-57 STA. 143+50 TO 156+23.2

SCALE: 1/4"=50' HORIZ.  
 1/2"=5' VERT.  
 DATE: MARCH 1, 2006

DRAWN BY: SS  
 CHECKED BY: MLS

**W** Wang Engineering, Inc. 1145 Main Street  
 Geotechnical and Environmental Engineers Lombard, IL 60148  
 630-953-9928  
BASED ON DRAWINGS PREPARED BY T.Y. LIN INTERNATIONAL, INC. 414-07-01