

F.A.L. RTE.	SECTION	COUNTY	TOTAL SHEETS	SHEET NO.
80	(32, 47-4)K	KENDALL/GRUNDY	243	35
STA. 1000+00		TO STA. 1013+00		
FED. ROAD DIST. NO.		ILLINOIS	FED. AID PROJECT	
CONTRACT NO. 66294				

- NOTES:
- SEE STORM WATER POLLUTION PREVENTION PLAN FOR TREE PROTECTION LOCATIONS.
  - ALL DRIVEWAYS (INCLUDING COMMERCIAL, PRIVATE, AND FIELD ENTRANCES) WILL BE CONSTRUCTED WITH PORTLAND CEMENT CONCRETE DRIVEWAY PAVEMENT 8 INCH.
  - BOTTOM EDGE OF RELOCATED SIGN NEEDS TO BE 7" ABOVE THE EDGE OF PAVEMENT ELEVATION.
  - ALL GUTTER FLAGS ALONG THE MEDIAN SHALL BE SLOPED TO MATCH THE ADJACENT PAVEMENT. THIS WILL BE PAID FOR AS COMBINATION CONCRETE CURB & GUTTER TYPE B6.24 OR CONCRETE MEDIAN TYPE SB-6.24 (SPECIAL).
  - FIRE HYDRANT AT STA. 9+02 LT ON OTTAWA DRIVE WILL BE MOVED TWICE. THE FIRST MOVE WILL BE NORTH TO THE TEMPORARY EASEMENT AND OUT OF THE WAY OF THE TEMPORARY PAVEMENT. THE HYDRANT WILL BE MOVED AGAIN AFTER THE ROADWAY CONSTRUCTION OF OTTAWA DRIVE IS COMPLETE. THE FINAL LOCATION WILL BE WITHIN THE PERMANENT HIGHWAY RIGHT-OF-WAY AND DETERMINED BY THE ENGINEER.
  - FIRE HYDRANT AT STA. 1004+80 LT ON RIDGE ROAD WILL BE MOVED ONCE. THE HYDRANT WILL BE MOVED EAST AFTER THE CURB AND GUTTER FOR RIDGE IS CONSTRUCTED AND BEFORE THE SIDEWALK IS CONSTRUCTED. THE FINAL LOCATION WILL BE WITHIN THE PERMANENT RIGHT-OF-WAY AND DETERMINED BY THE ENGINEER.

DATE	BY
DATE	BY
DATE	BY

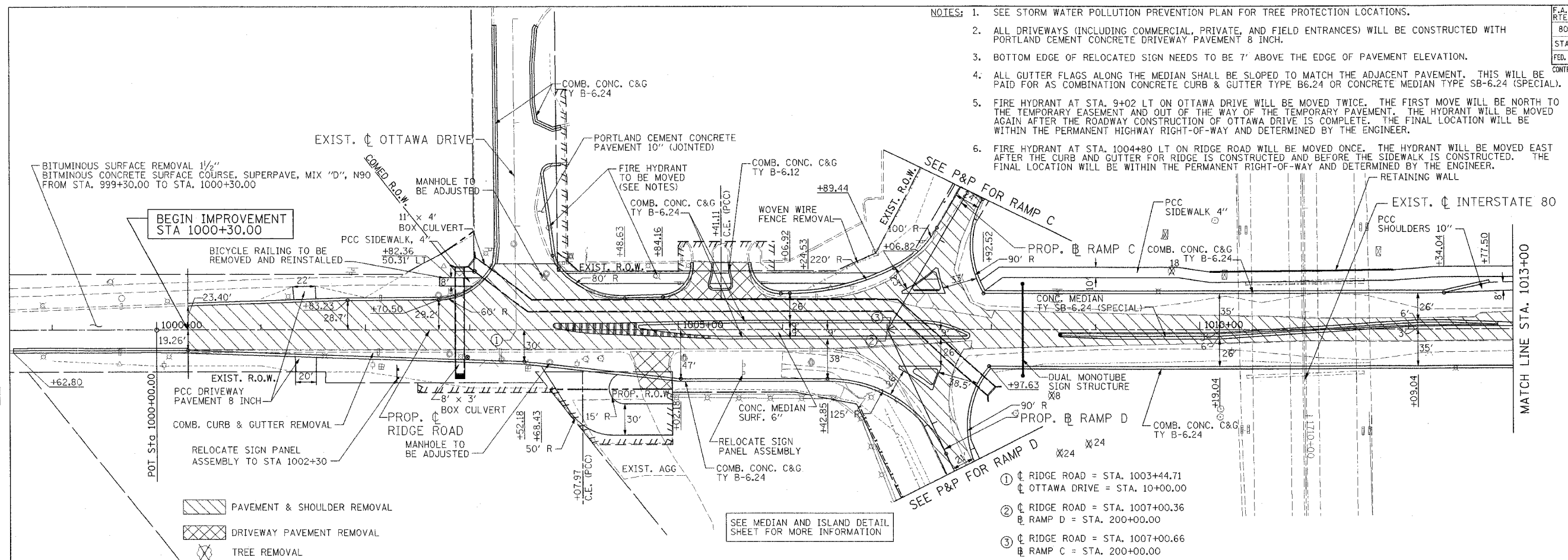

- PAVEMENT & SHOULDER REMOVAL
- DRIVEWAY PAVEMENT REMOVAL
- TREE REMOVAL

SEE MEDIAN AND ISLAND DETAIL SHEET FOR MORE INFORMATION

- ① RIDGE ROAD = STA. 1003+44.71  
OTTAWA DRIVE = STA. 10+00.00
- ② RIDGE ROAD = STA. 1007+00.36  
RAMP D = STA. 200+00.00
- ③ RIDGE ROAD = STA. 1007+00.66  
RAMP C = STA. 200+00.00



DATE	BY
DATE	BY
DATE	BY

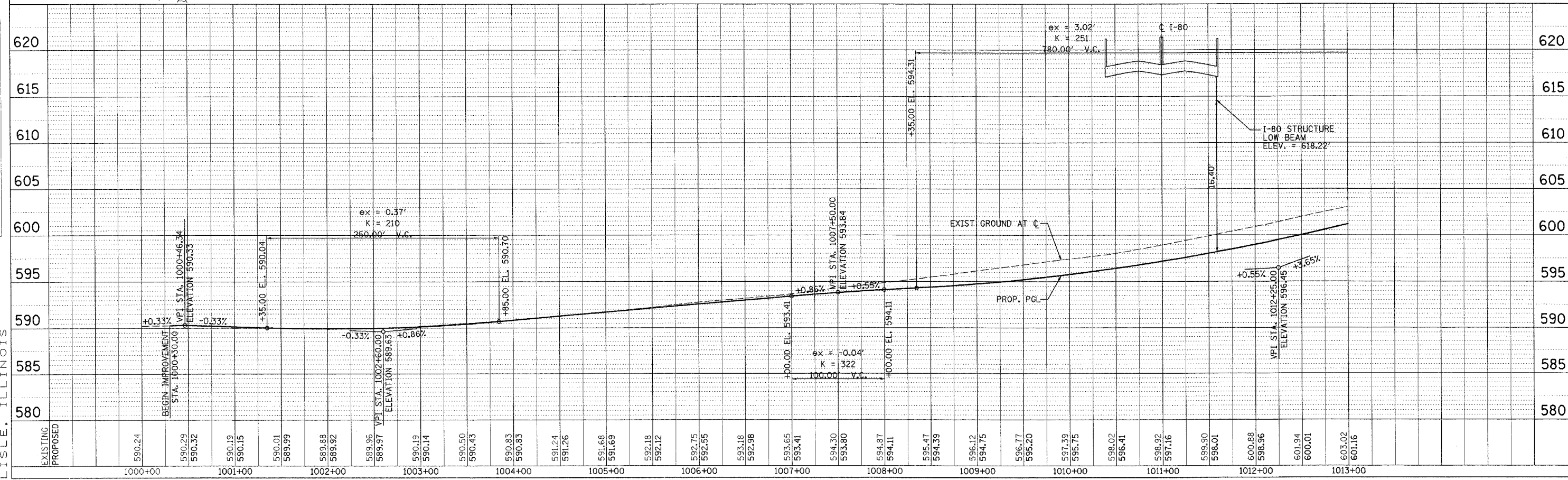

**PATRICK**  
ENGINEERING INC.  
LISLE, ILLINOIS