



F.A.I. RTE.	SECTION	COUNTY	TOTAL SHEETS	SHEET NO.
80	(32, 47-4)K	KENDALL/GRUNDY	243	50
STA.	TO STA.			
FED. ROAD DIST. NO.	ILLINOIS	FED. AID PROJECT		

CONTRACT NO. 66294

LEGEND:

- ① TEMPORARY PAVEMENT MARKING LINE, 4 INCHES (WHITE)
 - ② TEMPORARY PAVEMENT MARKING LINE, 4 INCHES (DOUBLE YELLOW)
 - ③ TEMPORARY PAVEMENT MARKING LINE, 4 INCHES (YELLOW)
 - ④ TYPE II BARRICADE OR DRUM WITH STEADY BURNING LIGHT
 - ⑤ PAVEMENT MARKING TAPE, TYPE 3, 4 INCHES (WHITE)
 - ⑥ PAVEMENT MARKING TAPE, TYPE 3, 4 INCHES (DOUBLE YELLOW)
 - ⑦ PAVEMENT MARKING TAPE, TYPE 3, 4 INCHES (YELLOW)
 - ⑧ TEMPORARY PAVEMENT
 - ⑨ VERTICAL PANEL
-  BITUMINOUS TEMPORARY PAVEMENT, 10.5"
 NEW CONSTRUCTION

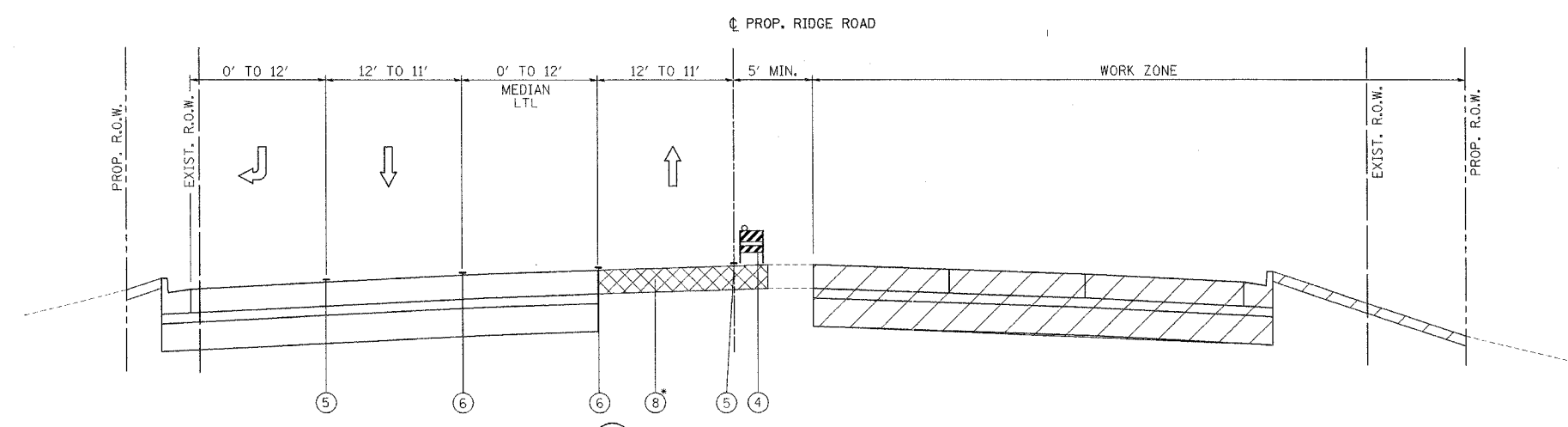

(R4) RIDGE ROAD STAGE 2 & 2A
 STA. 1000+30.00 TO STA. 1017+50.00
 *TEMPORARY PAVEMENT VARIES 0' TO 18'

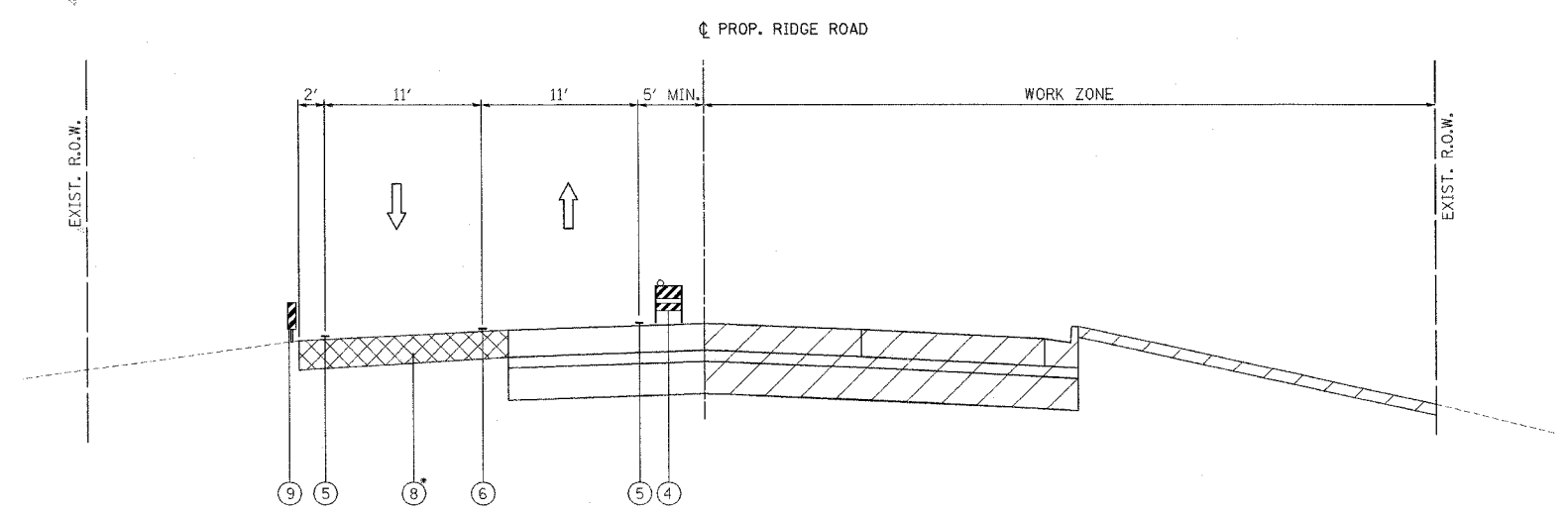

(R5) RIDGE ROAD STAGE 2 & 2A
 STA. 1017+50.00 TO STA. 1025+50.00
 *TEMPORARY PAVEMENT VARIES 0' TO 18.5'

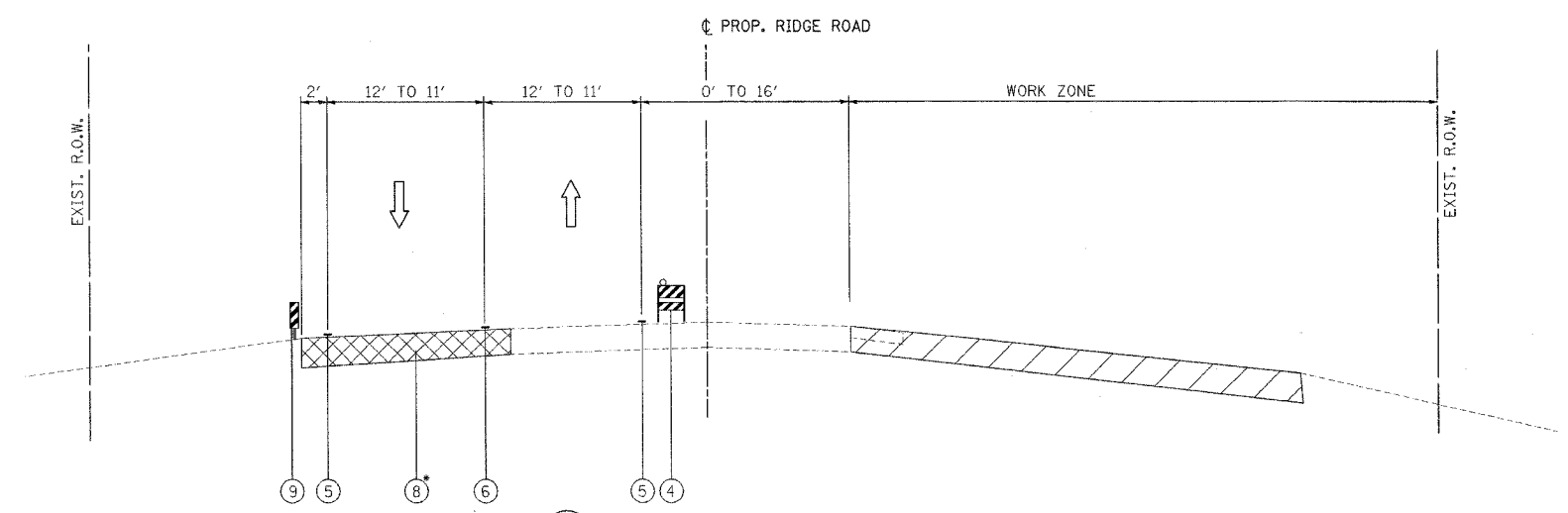

(R6) RIDGE ROAD STAGE 2 & 2A
 STA. STA. 1025+50.00 TO STA. 1029+50.00
 *TEMPORARY PAVEMENT VARIES 0' TO 18.5'

NOTE: SEE RIDGE ROAD PRE-STAGE PLAN SHEETS FOR EXACT LOCATION OF TEMPORARY PAVEMENT.

REVISIONS	
NAME	DATE

ILLINOIS DEPARTMENT OF TRANSPORTATION
 FAI ROUTE 80 (I-80 AT MINOOKA INTERCHANGE)
 SUGGESTED STAGING OF CONSTRUCTION
 & TRAFFIC CONTROL
 TYPICAL SECTIONS
 RIDGE ROAD STAGE 2 & 2A
 SCALE: NONE
 DATE: 2/10/06
 DRAWN BY: MAT
 CHECKED BY: JJC

