

F.A.I. RTE.	SECTION	COUNTY	TOTAL SHEETS	SHEET NO.
80	(32, 47-4)K	KENDALL/GRUNDY	243	63
STA.		TO STA.		
FED. ROAD DIST. NO.		ILLINOIS FED. AID PROJECT		
CONTRACT NO. 66294				

LEGEND

- TYPE II BARRICADES OR DRUMS WITH STEADY BURN LIGHTS @ 50' CENTERS, 25' CENTERS ALONG TAPERS AND 12' CENTERS ALONG RADIUS RETURNS
- ➔ TRAFFIC DIRECTION
- ⚡ VERTICAL PANEL WITH STEADY BURNING LIGHT
- ⌋ TYPE III BARRICADES WITH FLASHING LIGHTS
- ▨ WORK ZONE
- ▨ TEMPORARY PAVEMENT
- ➔ ARROW BOARD

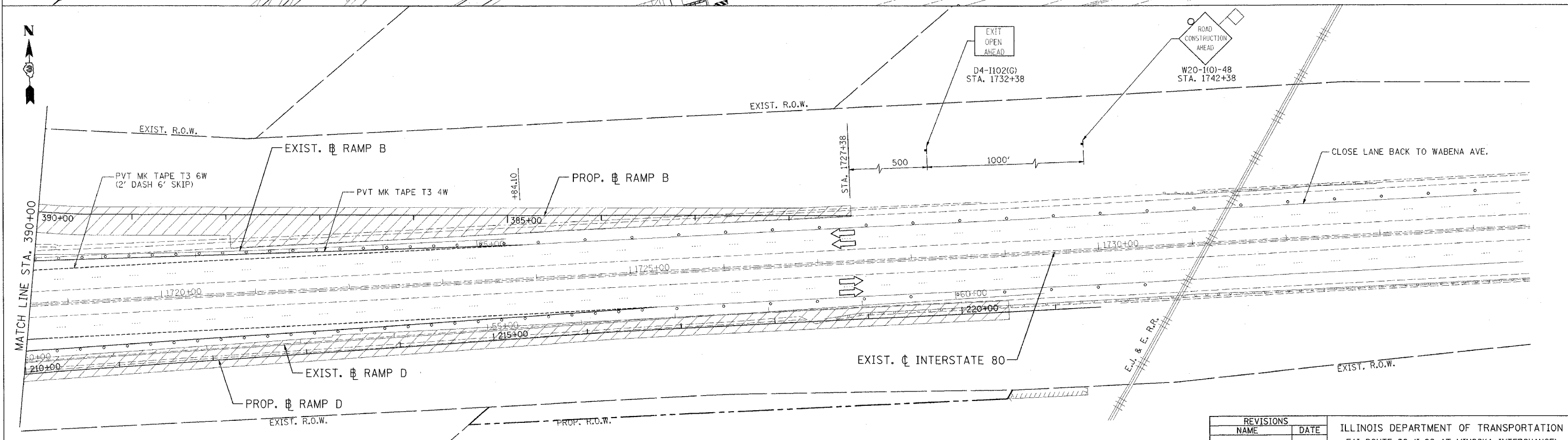
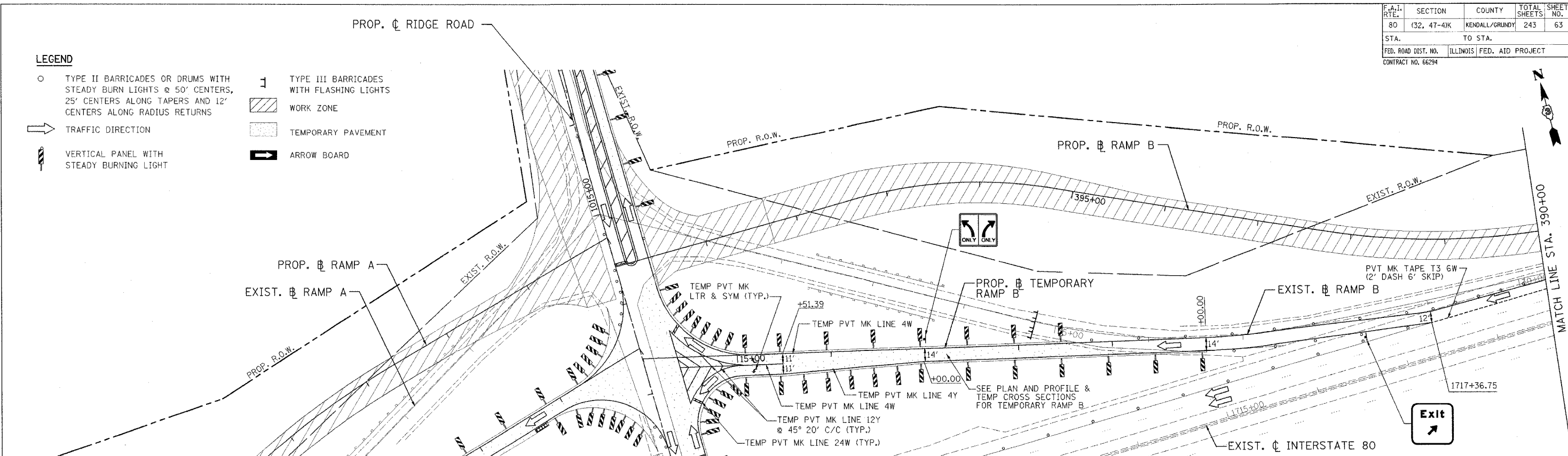

PATRICK
ENGINEERING INC.
LISLE, ILLINOIS

REVISIONS	
NAME	DATE

ILLINOIS DEPARTMENT OF TRANSPORTATION
FAI ROUTE 80 (I-80 AT MINOOKA INTERCHANGE)
SUGGESTED STAGING OF CONSTRUCTION & TRAFFIC CONTROL
STAGE 1
RAMP B
STA. 381+33.22 TO STA. 400+00
SCALE: 1:50
DATE: 2/10/06
DRAWN BY: MAT
CHECKED BY: JJC