

|                     |             |                  |              |           |
|---------------------|-------------|------------------|--------------|-----------|
| F.A.I. RTE.         | SECTION     | COUNTY           | TOTAL SHEETS | SHEET NO. |
| 80                  | (32, 47-4)K | KENDALL/GRUNDY   | 243          | 88        |
| STA.                | TO STA.     |                  |              |           |
| FED. ROAD DIST. NO. | ILLINOIS    | FED. AID PROJECT |              |           |
| CONTRACT NO. 66294  |             |                  |              |           |

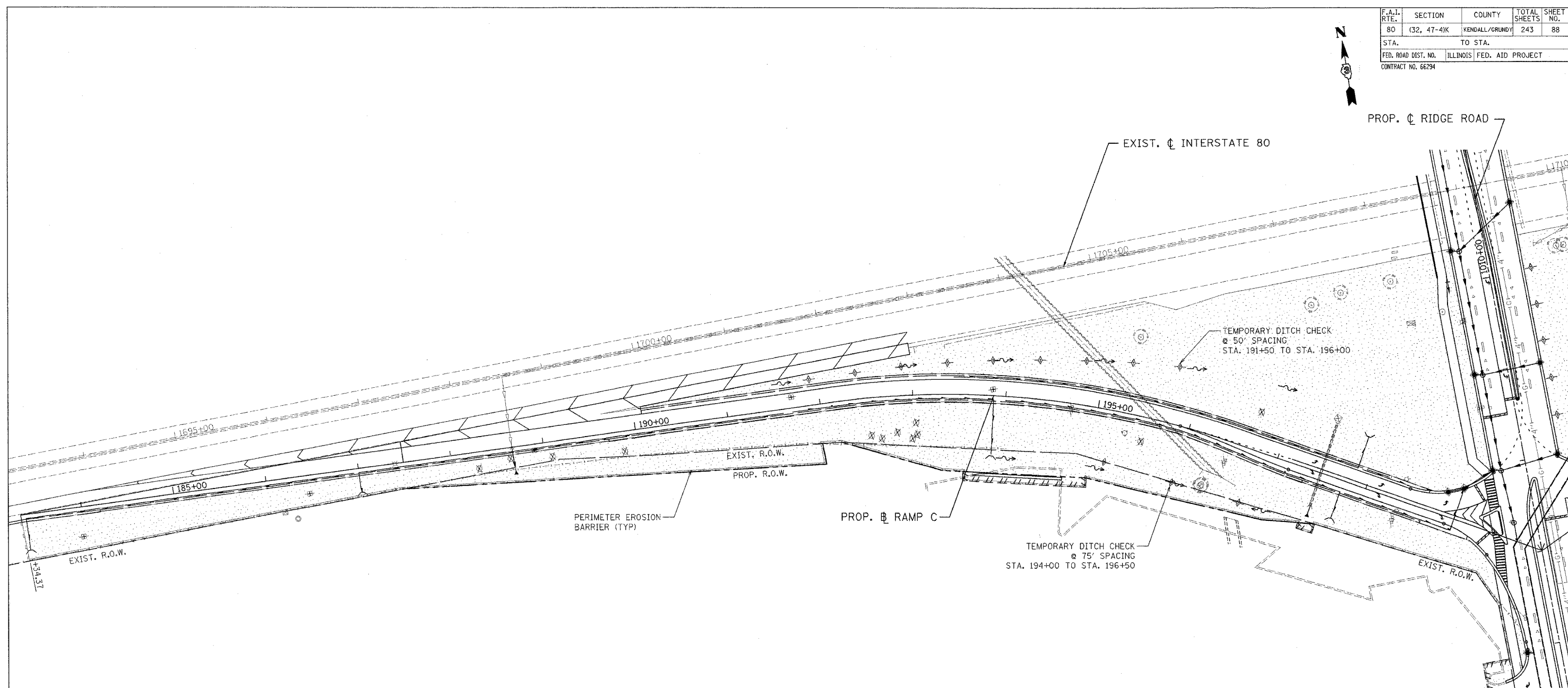

**LEGEND**

|  |  |
|--|--|
|  | TEMPORARY EROSION CONTROL SEEDING (28000250) |
|  | PERIMETER EROSION BARRIER (28000400)         |
|  | TEMPORARY DITCH CHECKS (28000300)            |
|  | INLET AND PIPE PROTECTION (28000500)         |
|  | TEMPORARY FENCE (20101000)                   |

| REVISIONS |      |
|-----------|------|
| NAME      | DATE |
|           |      |
|           |      |
|           |      |
|           |      |
|           |      |
|           |      |
|           |      |
|           |      |
|           |      |
|           |      |

ILLINOIS DEPARTMENT OF TRANSPORTATION  
 FAI ROUTE 80 (I-80 AT MINOOKA INTERCHANGE)  
 STORM WATER POLLUTION PREVENTION PLAN  
 RAMP C STA. 186+50 TO STA. 200+00  
 SCALE: 1/50  
 DATE: 2/10/06  
 DRAWN BY: DES  
 CHECKED BY: JJC

**PATRICK**  
 ENGINEERING INC.  
 LISLE, ILLINOIS