

F.A.I. RTE.	SECTION	COUNTY	TOTAL SHEETS	SHEET NO.
80	132, 47-41K	KENDALL/GRUNDY	243	101
STA.	TO STA.			
FED. ROAD DIST. NO.	ILLINOIS	FED. AID PROJECT		
CONTRACT NO. 66294				

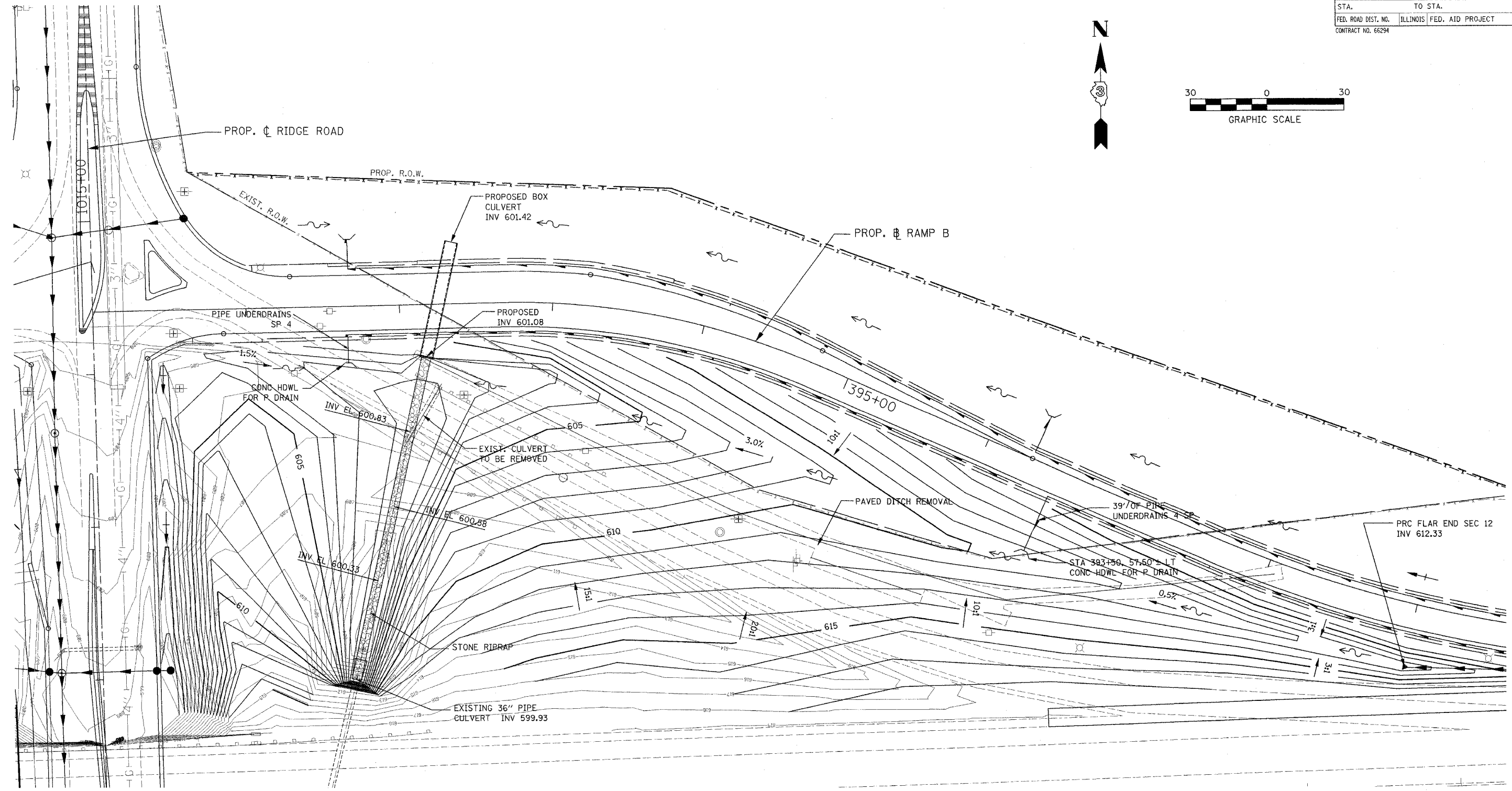
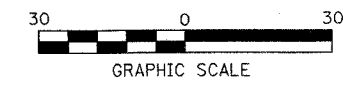

PATRICK
ENGINEERING INC.
LISLE, ILLINOIS

REVISIONS	
NAME	DATE

ILLINOIS DEPARTMENT OF TRANSPORTATION
FAI ROUTE 80 (I-80 AT MINOOKA INTERCHANGE)

PROPOSED GRADING PLAN
RAMP B INFIELD

SCALE: 1"=30'
DATE: 2/10/06

DRAWN BY: SRL
CHECKED BY: TKL