

F.A.I. RTE.	SECTION	COUNTY	TOTAL SHEETS	SHEET NO.
80	(32, 47-4)K	KENDALL/GRUNDY	243	133
STA.		TO STA.		
FED. ROAD DIST. NO.		ILLINOIS	FED. AID PROJECT	
CONTRACT NO. 66294				

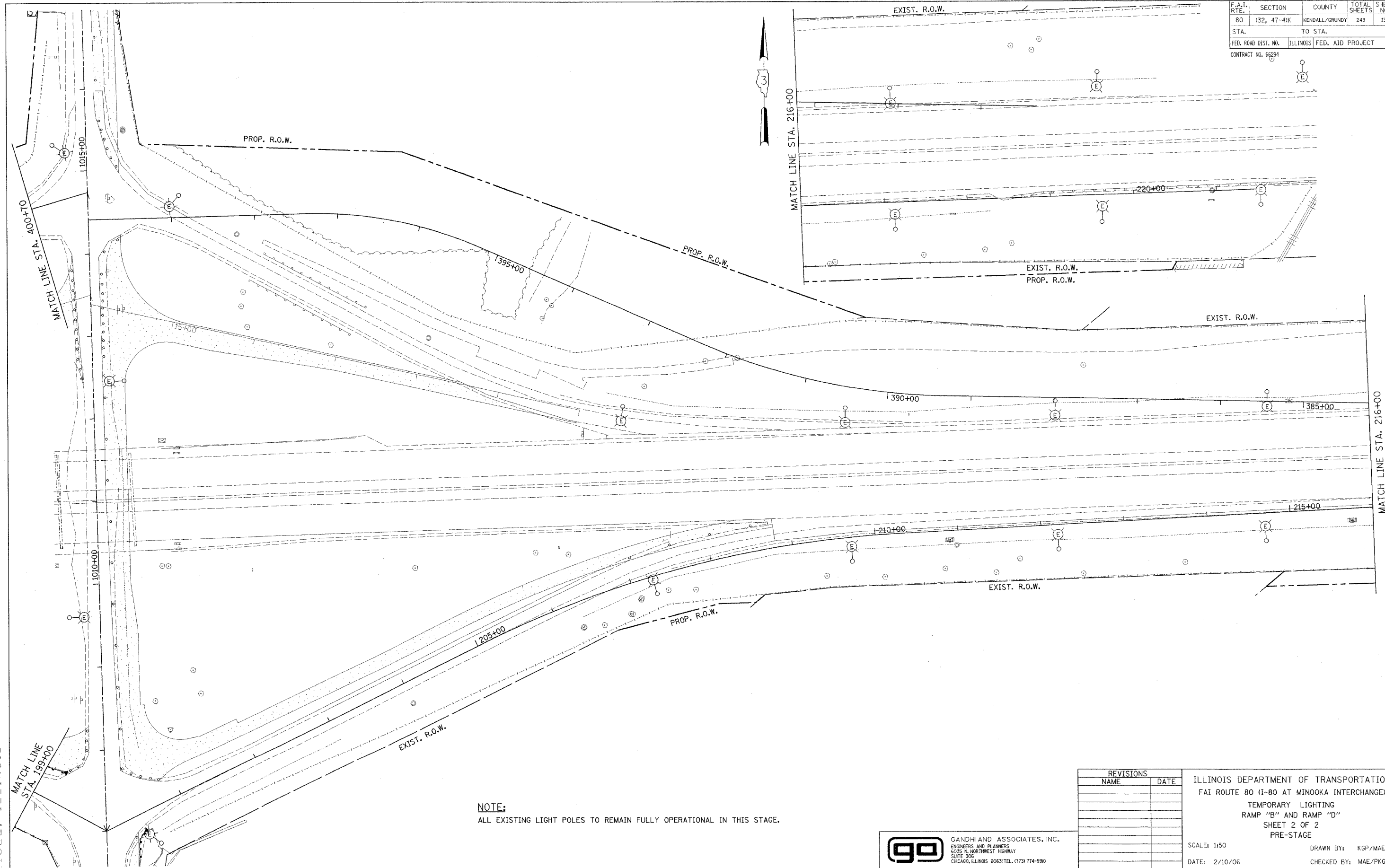

NOTE:
ALL EXISTING LIGHT POLES TO REMAIN FULLY OPERATIONAL IN THIS STAGE.

REVISIONS	
NAME	DATE

ILLINOIS DEPARTMENT OF TRANSPORTATION
 FAI ROUTE 80 (I-80 AT MINOOKA INTERCHANGE)
 TEMPORARY LIGHTING
 RAMP "B" AND RAMP "D"
 SHEET 2 OF 2
 PRE-STAGE

SCALE: 1:50
 DATE: 2/10/06

DRAWN BY: KGP/MAE
 CHECKED BY: MAE/PKG

GO GANDHI AND ASSOCIATES, INC.
 ENGINEERS AND PLANNERS
 6035 N. NORTHWEST HIGHWAY
 SUITE 306
 CHICAGO, ILLINOIS 60631 TEL: (773) 774-590

PATRICK
 ENGINEERING INC.
 LISLE, ILLINOIS