

ELEVATION

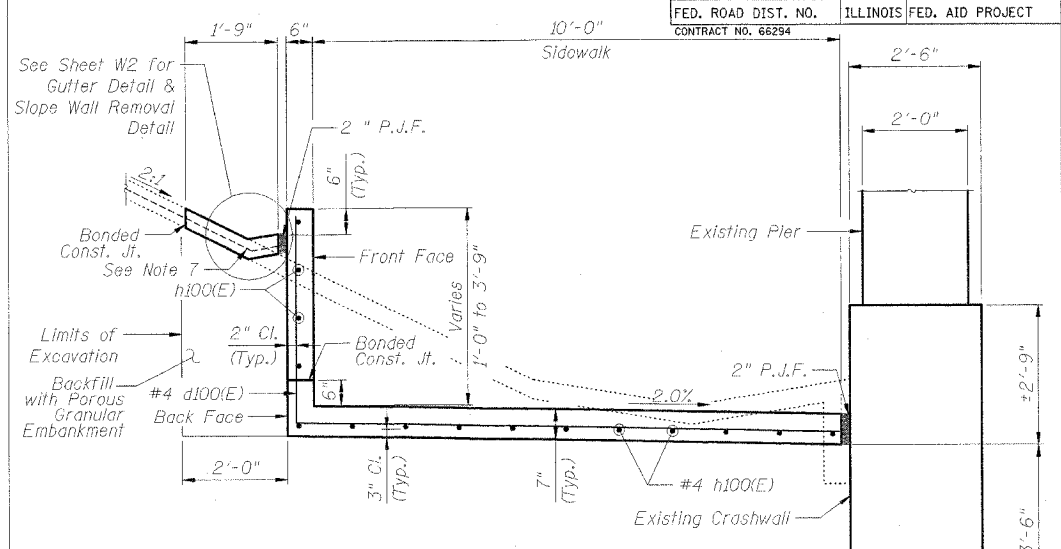

SECTION A-A

TOTAL BILL OF MATERIAL

Item	Unit	Quantity
Porous Granular Embankment	Cu. Yd.	39
Concrete Structures	Cu. Yd.	48.3
Structure Excavation	Cu. Yd.	153
Reinforcement Bars	Pound	3,410
Slope Wall Removal	Sq. Yd.	204
Concrete Gutter, Type B	Ft.	39

INDEX OF SHEETS

W1 - General Plan & Elevation
 W2 - Plan & Elevation Details

DESIGN STRESSES

$f'_c = 3500$ psi
 $f_y = 60,000$ psi (Reinf.)

DESIGN SPECIFICATIONS

2002 AASHTO Standard Specifications for Highway Bridges

SEISMIC DATA

Seismic Performance Category (SPC)=A
 Bedrock Acceleration Coefficient (A)=0.035g
 Site Coefficient (S)=1.0

NOTES:

- Bars designated (E) shall be epoxy coated.
- Reinforcement Bars shall conform to the requirements of AASHTO M-31, or M-322, Grade 60.
- Bars indicated thus 12x4-#5 etc. indicates 12 lines of bars with 4 lengths per line.
- All Construction joints shall be bonded.
- Work this sheet with W2 of W2.
- The Contractor shall provide adequate bracing for temporary support of the slope wall during construction. The cost of the bracing is included with the cost of Structure Excavation.
- Existing welded wire fabric shall be sand blasted clean and incorporated into new construction. Cost shall be included with the cost of Concrete Removal. See Sheet W2 for Slope Wall Removal Detail.

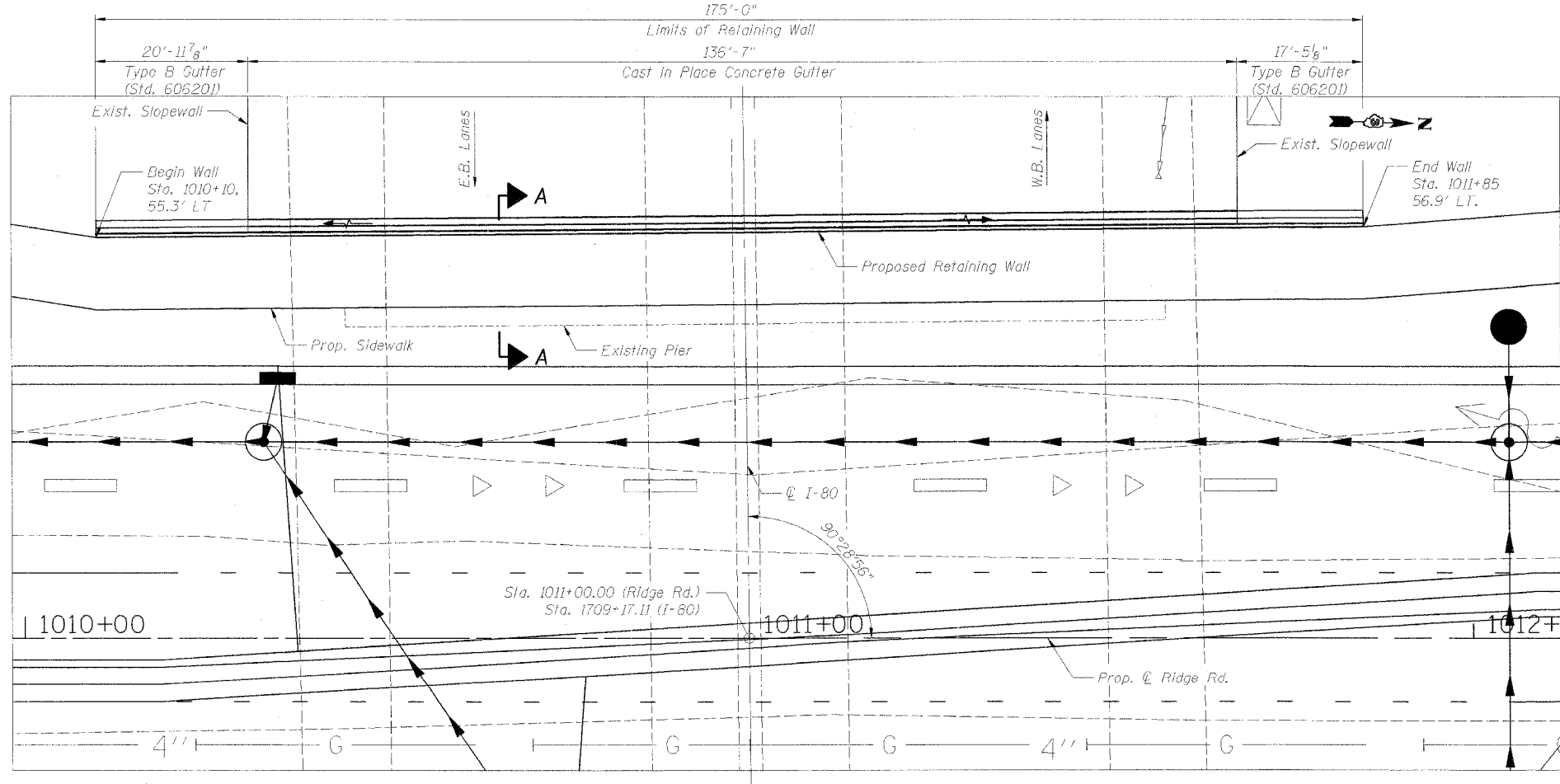

PLAN

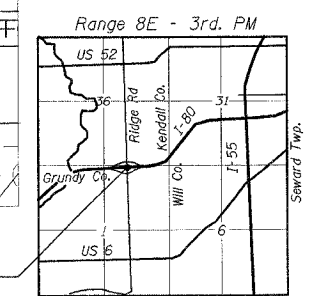

LOCATION SKETCH

REVISIONS	
NAME	DATE

ILLINOIS DEPARTMENT OF TRANSPORTATION
 FAI ROUTE 80
 (I-80 AT MINOOKA INTERCHANGE)
RETAINING WALL GENERAL PLAN & ELEVATION

SCALE: None
 DATE: 2/10/06
 DRAWN BY: M. Tryon
 CHECKED BY: A. Yargoclu