

| F.A. RTE. | SECTION | COUNTY | TOTAL SHEETS | SHEET NO. |
|--------------|---------|---------------------------|--------------|-----------|
| • | •• | LASALLE | 95 | 28 |
| STA. TO STA. | | ILLINOIS FED. AID PROJECT | | |

• FAP ROUTE 653 (ROUTE 18 COUPLE)
 •• SECTION (7)R, RS-2; (8)R, RS-1

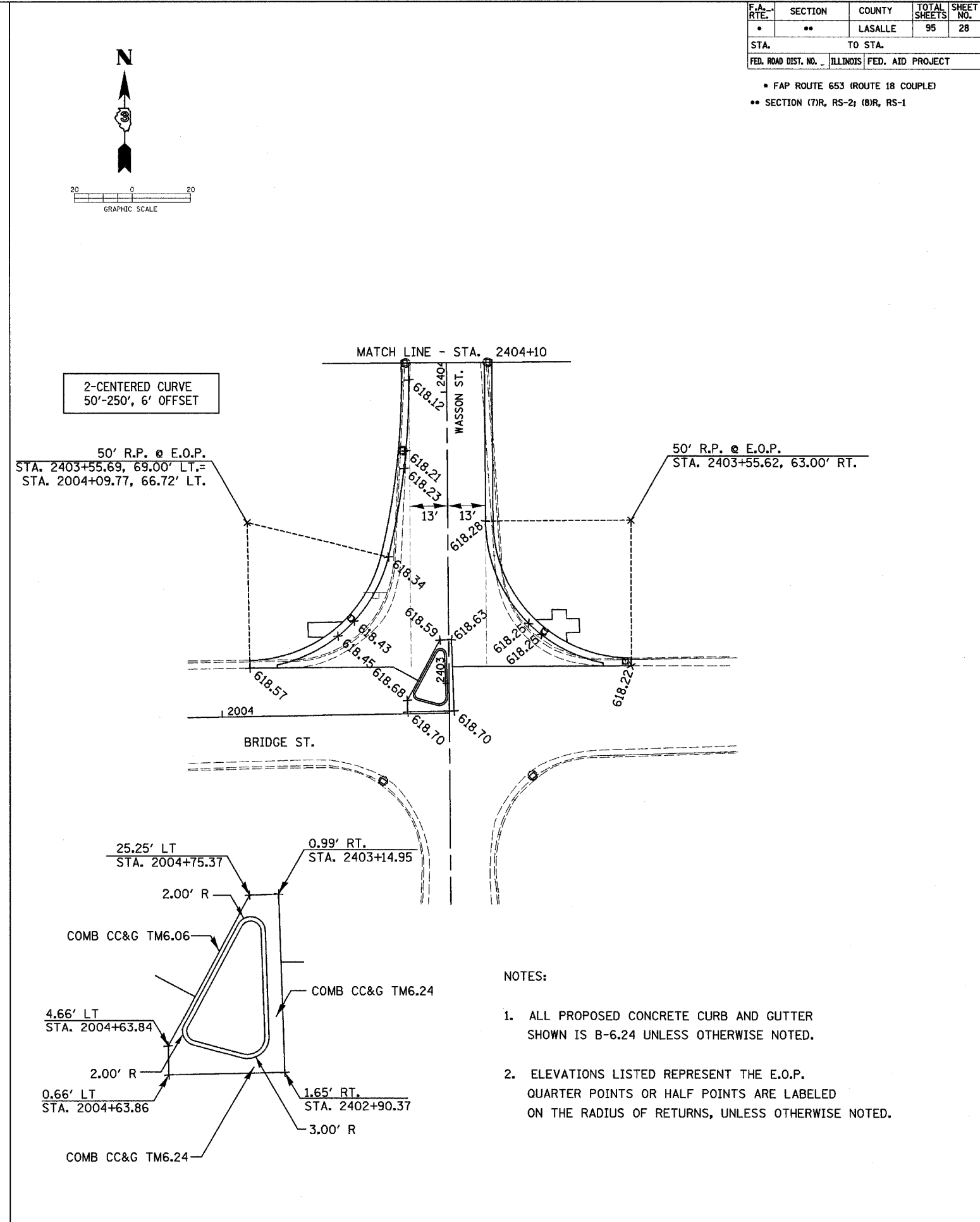
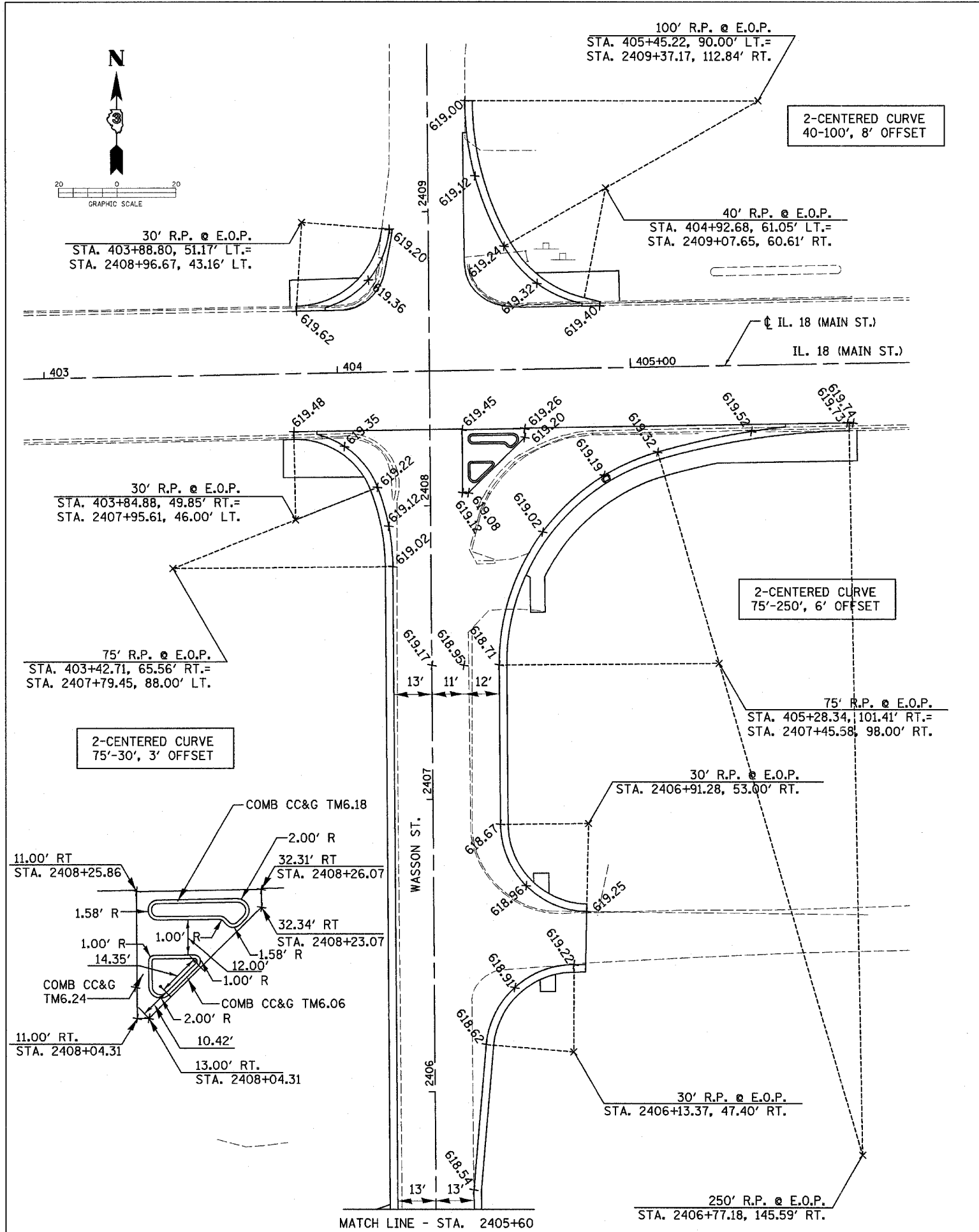

- NOTES:
1. ALL PROPOSED CONCRETE CURB AND GUTTER SHOWN IS B-6.24 UNLESS OTHERWISE NOTED.
 2. ELEVATIONS LISTED REPRESENT THE E.O.P. QUARTER POINTS OR HALF POINTS ARE LABELED ON THE RADIUS OF RETURNS, UNLESS OTHERWISE NOTED.

WASSON ST. GEOMETRIC PLAN