

F.A. RTE.	SECTION	COUNTY	TOTAL SHEETS	SHEET NO.
*	**	LASALLE	95	35
STA. TO STA.				
FED. ROAD DIST. NO. ILLINOIS FED. AID PROJECT				
* FAP ROUTE 653 (ROUTE 18 COUPLE)				
** SECTION (7R, RS-2) (8R, RS-1)				

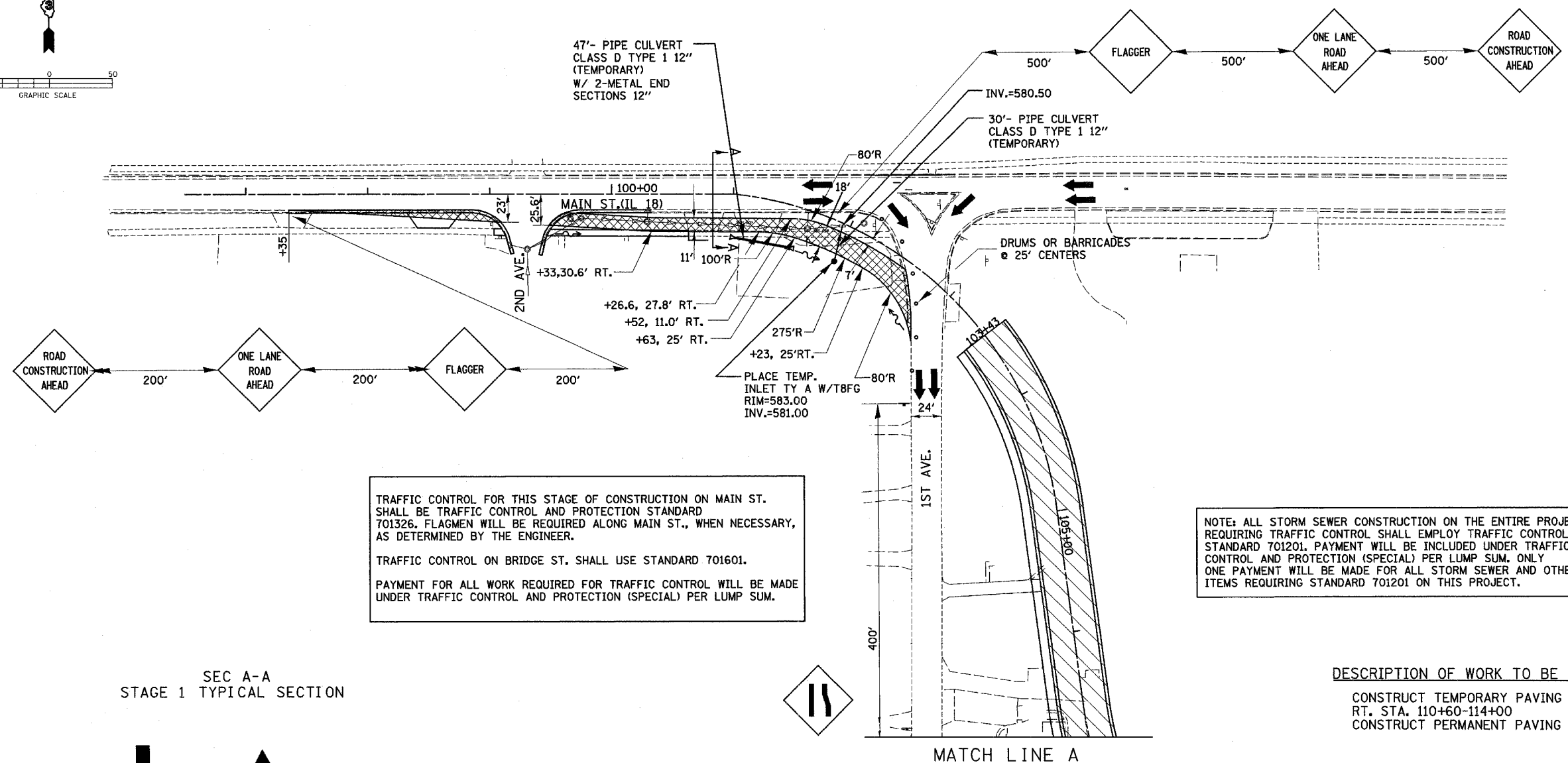
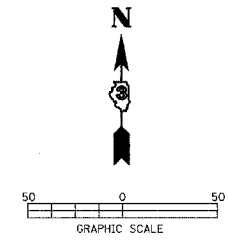

TRAFFIC CONTROL FOR THIS STAGE OF CONSTRUCTION ON MAIN ST. SHALL BE TRAFFIC CONTROL AND PROTECTION STANDARD 701326. FLAGMEN WILL BE REQUIRED ALONG MAIN ST., WHEN NECESSARY, AS DETERMINED BY THE ENGINEER.

TRAFFIC CONTROL ON BRIDGE ST. SHALL USE STANDARD 701601.

PAYMENT FOR ALL WORK REQUIRED FOR TRAFFIC CONTROL WILL BE MADE UNDER TRAFFIC CONTROL AND PROTECTION (SPECIAL) PER LUMP SUM.

NOTE: ALL STORM SEWER CONSTRUCTION ON THE ENTIRE PROJECT REQUIRING TRAFFIC CONTROL SHALL EMPLOY TRAFFIC CONTROL STANDARD 701201. PAYMENT WILL BE INCLUDED UNDER TRAFFIC CONTROL AND PROTECTION (SPECIAL) PER LUMP SUM. ONLY ONE PAYMENT WILL BE MADE FOR ALL STORM SEWER AND OTHER ITEMS REQUIRING STANDARD 701201 ON THIS PROJECT.

SEC A-A
STAGE 1 TYPICAL SECTION

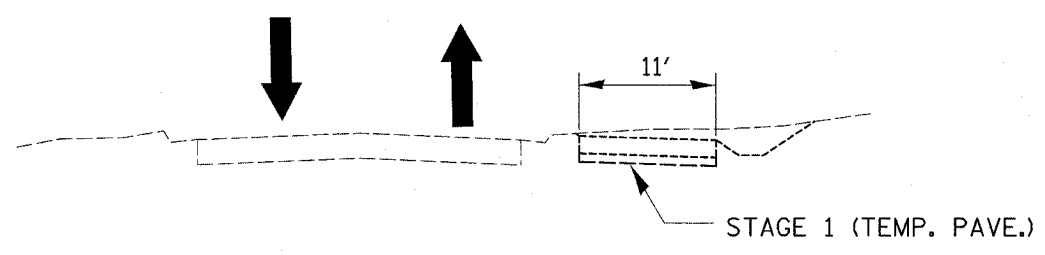

RUNAROUND TYPICAL SECTION

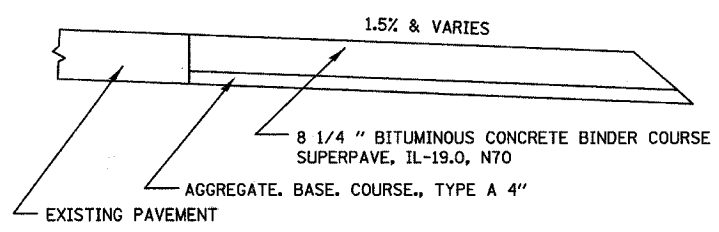

- LEGEND
- PERMANENT CONSTRUCTION
 - TEMPORARY CONSTRUCTION
 - DRUM OR BARRICADE W/LIGHT
 - TRAFFIC FLOW ARROW

DESCRIPTION OF WORK TO BE COMPLETED (STAGE 1)

CONSTRUCT TEMPORARY PAVING RT. STA. 97+35-103+00 & RT. STA. 110+60-114+00
CONSTRUCT PERMANENT PAVING STA. 103+43-109+41

TRAFFIC CONTROL (STAGE 1)

MAINTAIN TWO SOUTHBOUND LANES ON 1ST. AVE.
MAINTAIN ONE EASTBOUND LANE ON BRIDGE ST.
USE SHORT TIME LANE CLOSURES ON MAIN ST. ACCORDING TO STANDARD 701201 AND USE STANDARD 701601 FOR THE BRIDGE ST. LANE CLOSURE