

F.A. RTE.	SECTION	COUNTY	TOTAL SHEETS	SHEET NO.
68	**	LASALLE	95	53
STA. 200+00 TO STA. 204+78				
FED. ROAD DIST. NO. ILLINOIS FED. AID PROJECT				
• FAP ROUTE 653 (ROUTE 18) COUPLED				
•• SECTION (7)R, RS-2; (8)R, RS-1				

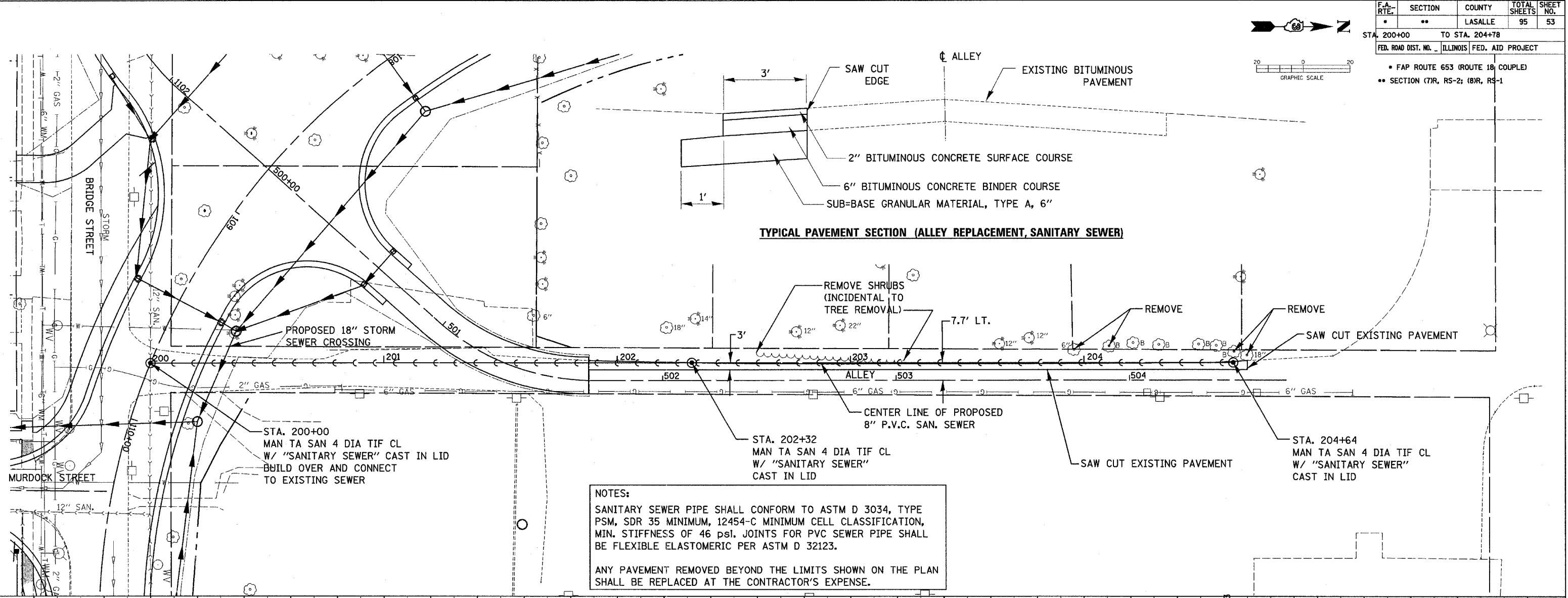

**NOTES:**  
 SANITARY SEWER PIPE SHALL CONFORM TO ASTM D 3034, TYPE PSM, SDR 35 MINIMUM, 12454-C MINIMUM CELL CLASSIFICATION, MIN. STIFFNESS OF 46 psi. JOINTS FOR PVC SEWER PIPE SHALL BE FLEXIBLE ELASTOMERIC PER ASTM D 32123.  
 ANY PAVEMENT REMOVED BEYOND THE LIMITS SHOWN ON THE PLAN SHALL BE REPLACED AT THE CONTRACTOR'S EXPENSE.

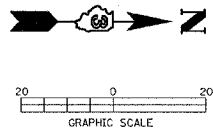
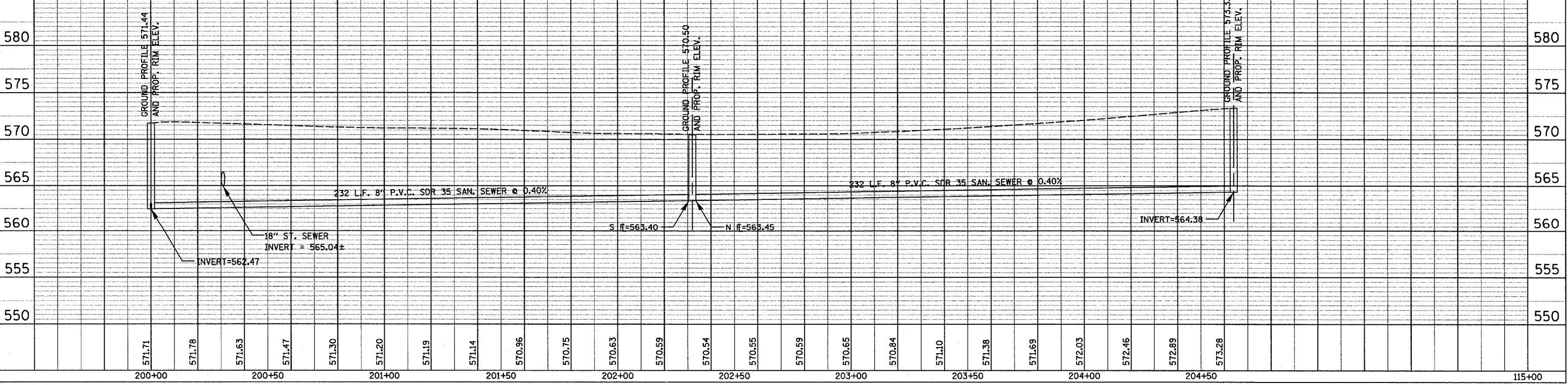

DATE	BY	REVISION

DATE	BY	REVISION

**DRAINAGE AND UTILITY SHEET-SANITARY SEWER ALONG ALLEY**