

F.A. RTE.	SECTION	COUNTY	TOTAL SHEETS	SHEET NO.
**	**	LASALLE	95	56
STA. 2405+90		TO STA. 2409+37.95		
FED. ROAD DIST. NO. ILLINOIS FED. AID PROJECT				

• FAP ROUTE 653 (ROUTE 18 COUPLE)
 •• SECTION (7)R, RS-2; (8)R, RS-1

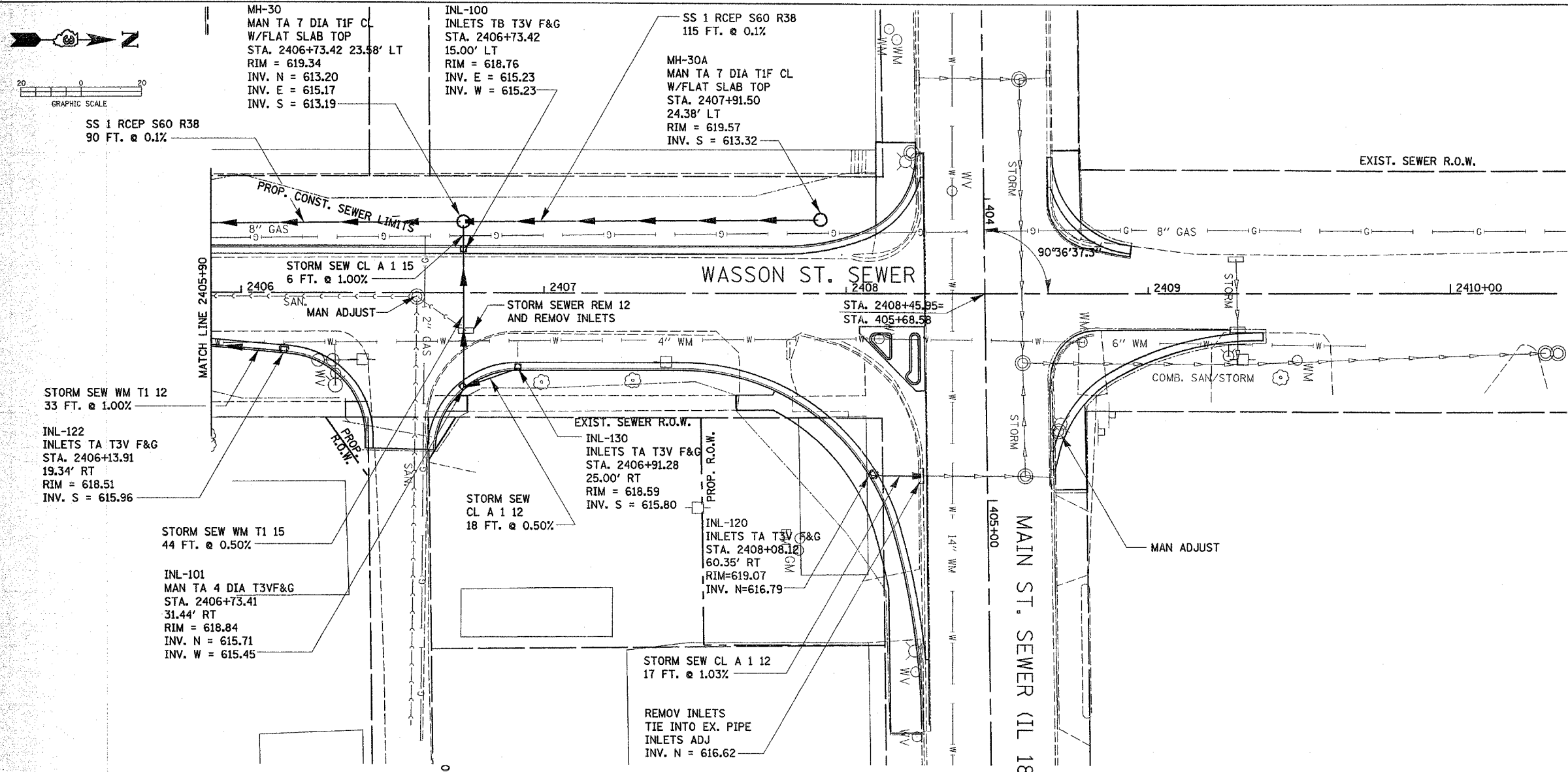

1:10(V) SCALE = PROFILE

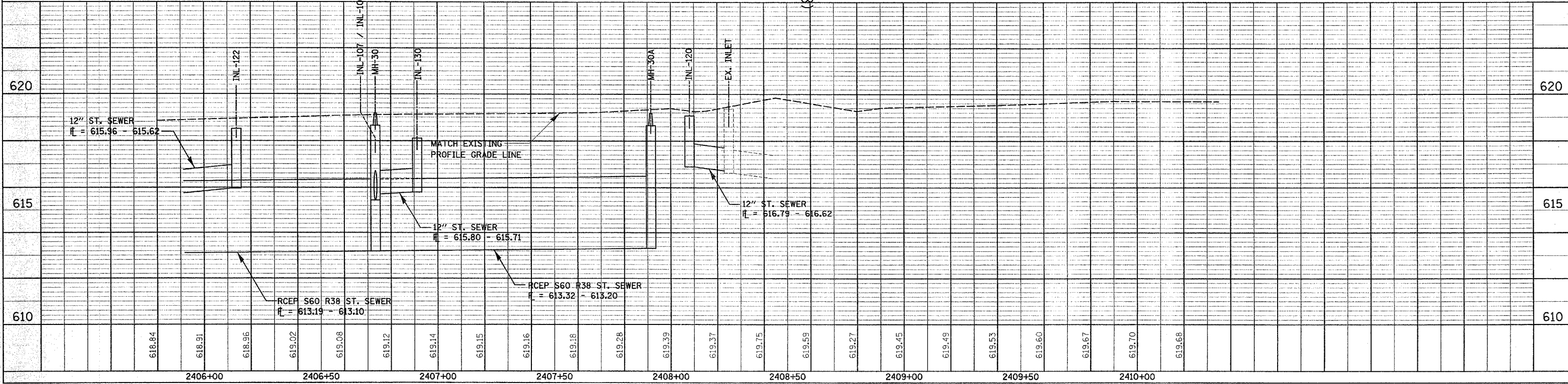

DRAINAGE AND UTILITY SHEET FOR WASSON ST. SEWER -- STA. 2405+90 TO STA. 2409+37.95

DATE	BY	REVISION

DATE	BY	REVISION