

F.A.P. RTE.	SECTION	COUNTY	TOTAL SHEETS	SHEET NO.
623	(30)1-1	LASALLE	12	8
FED. ROAD DIST. NO. - ILLINOIS				

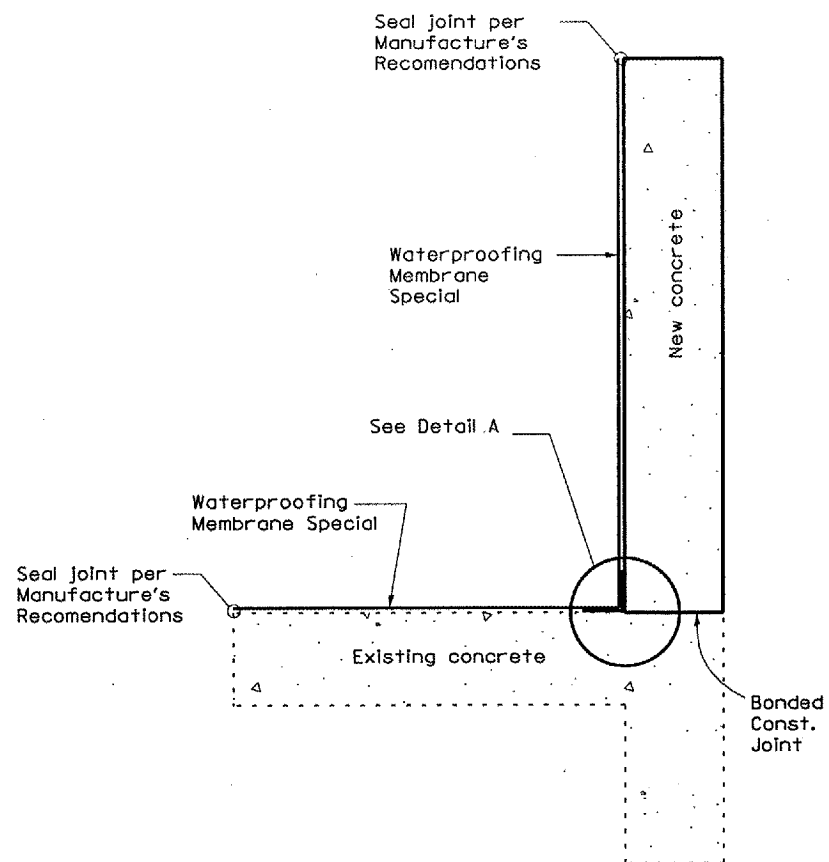

DETAIL A

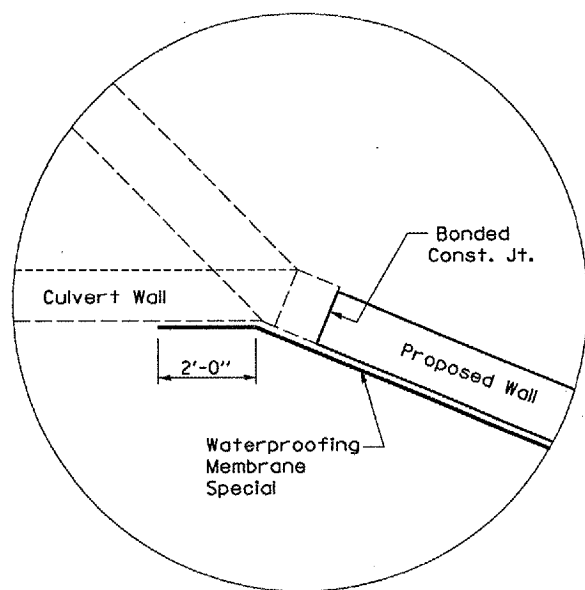

CORNER DETAIL

① A two foot (2') min width strip of waterproofing membrane shall be placed centered over the construction joint prior to applying a full protective layer to the concrete surfaces.

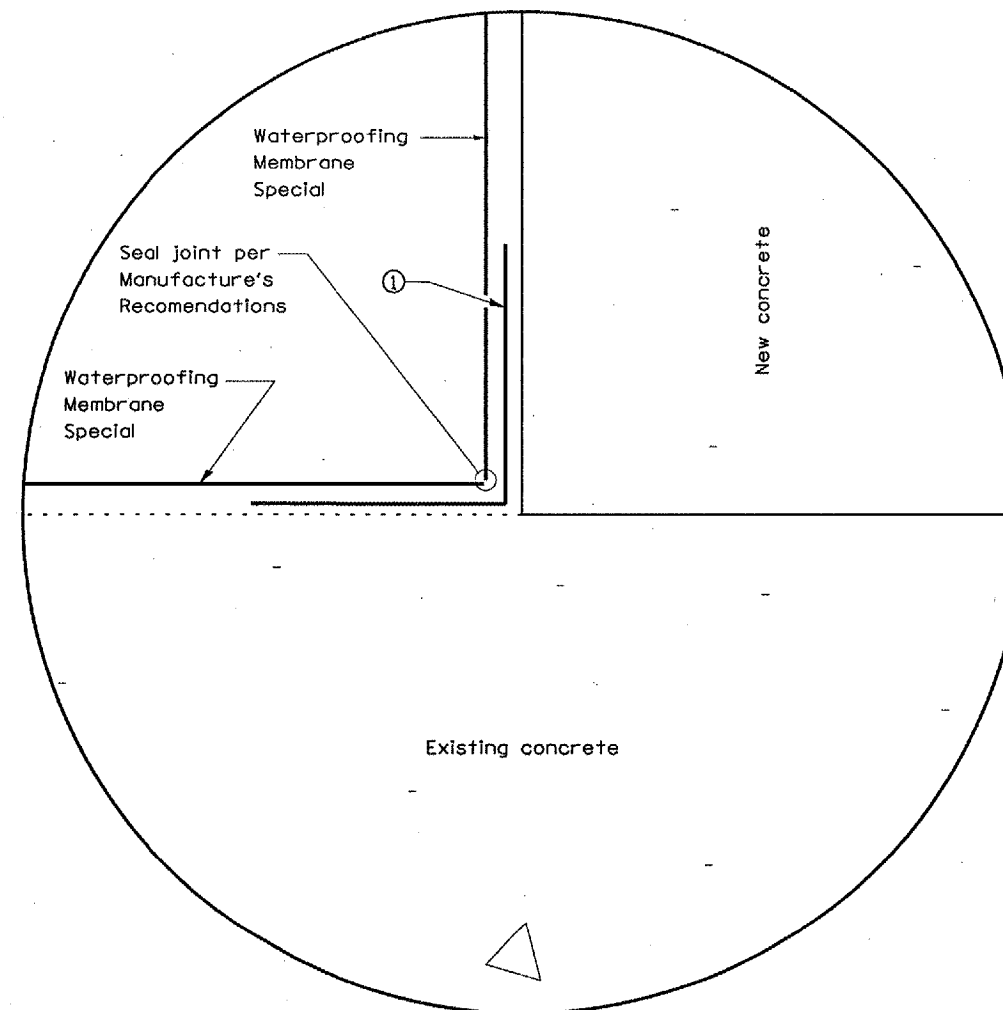

DETAIL A

**NOTES:**

The exposed surfaces of the existing top of footing and the back side of the wingwall shall be protected by the waterproofing membrane as per the manufacturer's recommendations.

A manufacturer's representative shall be on site during the installation of the waterproofing membrane to provide technical support when required.

The Contractor shall install the waterproofing membrane according the Special Provision for Waterproofing Membrane Special provided elsewhere in the plans, according to this detail and as directed by the Engineer.

REVISIONS	
NAME	DATE

ILLINOIS DEPARTMENT OF TRANSPORTATION  
**MEMBRANE WATERPROOFING**  
**(SPECIAL) DETAILS**  
 F.A.P. 623 (U.S. 6) SECTION (30)1-1  
 LASALLE COUNTY  
 STA. 1556 + 25  
 DATE 12/20/2005 DRAWN BY RLW

Date: 11/07/2005  
 File: cr/projects/cmain06/cm324/details.dgn