

F.A.P. RTE.	SECTION	COUNTY	TOTAL SHEETS	SHEET NO.
313	103N-1,TS	WARREN		39
STA.		TO STA.		
FED. ROAD DIST. NO. 4 ILLINOIS FED. AID PROJECT				

MATCHLINE STA. 11+30

MATCHLINE STA. 424+42.31

MATCHLINE STA. 429+00

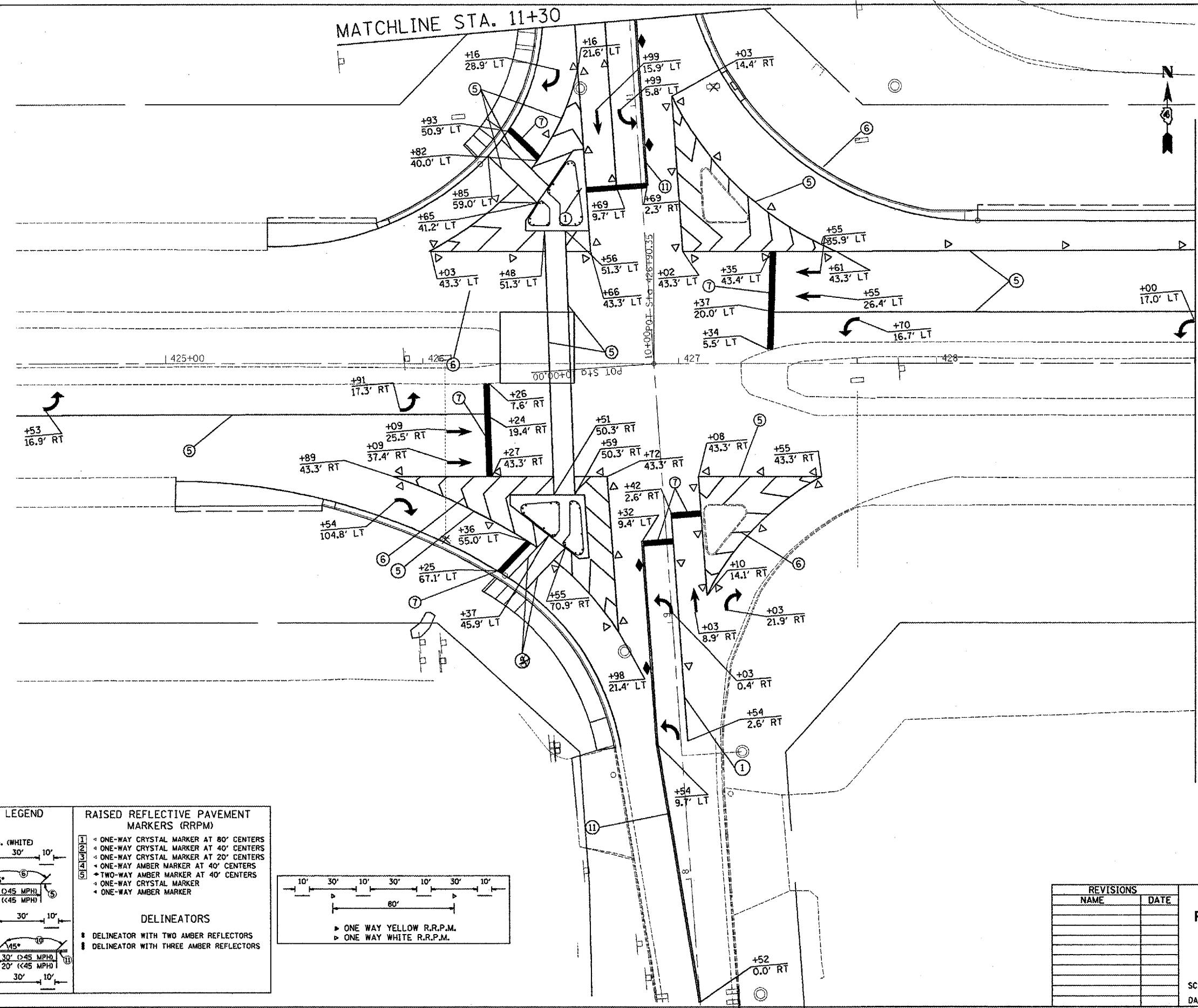

**PAVEMENT MARKING LEGEND**

① 4" SOLID (YELLOW)	⑤ 8" SOLID (WHITE)
② 4" SOLID (WHITE)	⑥ 12" DIAGONAL (WHITE)
③ 6" CROSSWALK @ 6'-6" o.c. (WHITE)	⑦ 24" STOP BAR (WHITE)
④ 4" SKIP DASH (WHITE)	⑧ LETTERS AND SYMBOLS
	⑨ 4" SKIP DASH (YELLOW)
	⑩ 12" DIAGONAL (YELLOW)
	⑪ 4" DOUBLE (YELLOW)
	⑫ 6" SKIP DASH (WHITE)

**RAISED REFLECTIVE PAVEMENT MARKERS (RRPM)**

① ONE-WAY CRYSTAL MARKER AT 80' CENTERS
② ONE-WAY CRYSTAL MARKER AT 40' CENTERS
③ ONE-WAY CRYSTAL MARKER AT 20' CENTERS
④ ONE-WAY AMBER MARKER AT 40' CENTERS
⑤ TWO-WAY AMBER MARKER AT 40' CENTERS
⑥ ONE-WAY CRYSTAL MARKER
⑦ ONE-WAY AMBER MARKER

**DELINEATORS**

① DELINEATOR WITH TWO AMBER REFLECTORS
② DELINEATOR WITH THREE AMBER REFLECTORS

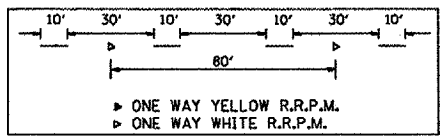

**REVISIONS**

NAME	DATE

ILLINOIS DEPARTMENT OF TRANSPORTATION  
**PROPOSED PAVEMENT MARKINGS**  
**US 34**  
**STA 418+00 TO 424+00**

SCALE: VERT. 1" = 20' scale  
 HORIZ. 1" = 40' scale

DRAWN BY jaw  
 CHECKED BY

PLOT DATE = 2/18/2008  
 FILE NAME = c:\p\projects\warren\042\propplan\mshs.dwg  
 PLOT SCALE = 48.0000 / IN.  
 USER NAME = russellm