

F.A.P. RTE.	SECTION	COUNTY	TOTAL SHEETS	SHEET NO.
313	1031-3	WARREN		46
STA.		TO STA.		
FED. ROAD DIST. NO. 4 ILLINOIS FED. AID PROJECT				
CONT. #68356				

REF.	LOCATION	TYPE
HH-2	SE QUADRANT	STANDARD
HH-3	SW QUADRANT	STANDARD
HH-4	NW QUADRANT	STANDARD

	EX. CONCRETE HANDHOLE
	EX. CONTROLLER CABINET
	EX. LIGHTING CONTROLLER
	EX. SERVICE INSTALLATION
	EX. CONDUIT
	FIBER OPTIC CABLE IN EX. CONDUIT
	PROP. CONCRETE HANDHOLE
	PROP. PEDESTRIAN SIGNAL HEAD
	PROP. PEDESTRIAN PUSH BUTTON
	PROP. SIGNAL HEAD WITH BACKPLATE
	PROP. SIGNAL HEAD
	PROP. VIDEO DETECTION CAMERA
	PROP. TRAFFIC SIGNAL POST
	PROP. LUMINAIRE

**CONSTRUCTION STAGING NOTES**

ALL TRAFFIC SIGNAL WORK MUST BE COMPLETED BEFORE THE INTERSECTION IMPROVEMENTS CAN COMMENCE. IF THE CONTRACTOR ELECTS ALTERNATE STAGING, ALL COSTS ASSOCIATED WITH THE STAGING CHANGE, INCLUDING BUT NOT LIMITED TO TRAFFIC SIGNAL MODIFICATIONS, TEMPORARY CABLE, AND TEMPORARY TRAFFIC SIGNALS, WILL BE THE SOLE RESPONSIBILITY OF THE CONTRACTOR.

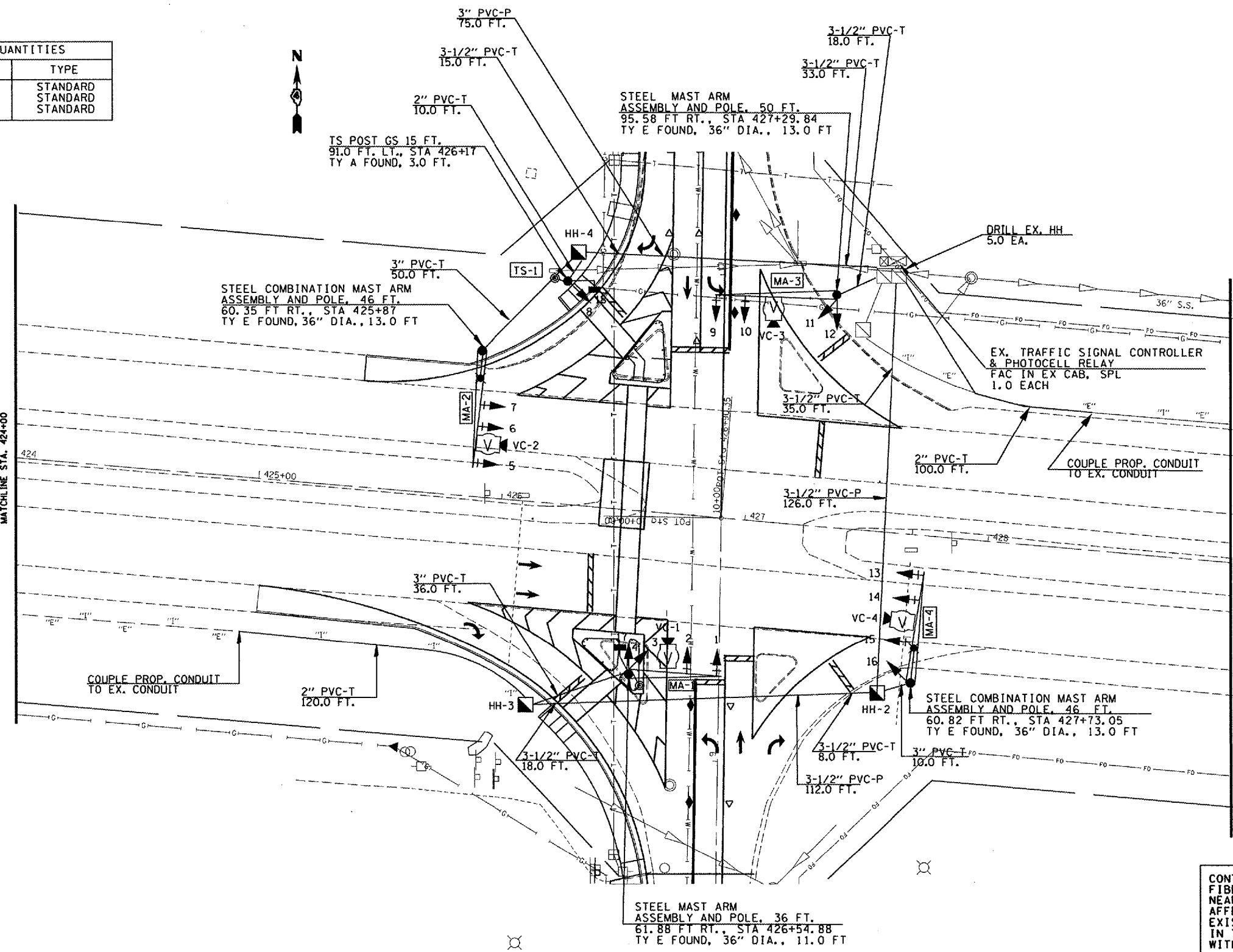

CONTRACTOR TO REMOVE EXISTING FIBER OPTIC CABLE AND LOOP WIRE TO NEAREST HANDHOLE THAT IS NOT AFFECTED BY CONSTRUCTION. THE EXISTING CABLES WILL BE REINSTALLED IN THE EXISTING CONDUITS FOR USE WITH THE PROPOSED TRAFFIC SIGNALS.

REF.	LOCATION	TYPE	LENGTH
TS-1	NW QUADRANT	TS POST GS	15 FT.
MA-1	SW QUADRANT	S MAA & P	36 FT.
MA-2	NW QUADRANT	S COMB MAA & P	46 FT.
MA-3	NE QUADRANT	S MAA & P	50 FT.
MA-4	SE QUADRANT	S COMB MAA & P	46 FT.

QTY	UNIT	ITEM	LOCATION
10.0	EA.	SH, LED, 1F, 3-SEC, MAM	1, 2, 5, 6, 7, 9, 10, 13, 14, 15
4.0	EA.	SH, LED, 1F, 3-SEC, BM	3, 4, 8, 11, 12, 16
10.0	EA.	TRAFFIC SIGNAL BACKPLATE LOUVERED	1, 2, 5, 6, 7, 9, 10, 13, 14, 15
2.0	EA.	SH, LED, 1F, PED, BM	17, 18

NAME	DATE

ILLINOIS DEPARTMENT OF TRANSPORTATION  
**PROPOSED TRAFFIC SIGNALS**  
 US 34 & SIXTH ST.  
 MONMOUTH  
 WARREN COUNTY

SCALE: VERT. \_\_\_\_\_  
 HORIZ. \_\_\_\_\_  
 DATE \_\_\_\_\_

DRAWN BY \_\_\_\_\_  
 CHECKED BY \_\_\_\_\_

\$\$\$DATE\$\$\$  
 \*DGN-ONLY\*