

F.A. RTE.	SECTION	COUNTY	TOTAL SHEETS	SHEET NO.
121	134RS-4	LOGAN	67	19
STA. 367+00.00		TO STA. 373+00.00		
FED. ROAD DIST. NO. 6		ILLINOIS FED. AID PROJECT		



**PIPE WORK TO BE DONE BY OTHERS
(PRIOR TO RESURFACING)**

EX INLET CONC. GUTTER
OUTLET, AND 8" x 100' CLAY
PIPE **TBR**

**GRADING TO BE DONE BY OTHERS
(PRIOR TO RESURFACING)**

20.0' LT STA 370+00.00
PR MH, T-A, 5' DIA. W/
FSL, T-1 F. CL (STDS
INV = 601.30
TOL = 607.00
PR PIPE CULV 15" x
+50.00, 20.0' LT USFL = 605.50
+00.00, 20.0' LT DSFL = 602.00
1-PRC FL END SEC 15" (STD 542301)
PR PIPE CULV 15" x
+00.00, 20.0' LT DSFL = 602.00
+00.00, 20.0' LT USFL = 605.50
1-PRC FL END SEC 15"
(STD 542301)
EX MANHOLE **TBR**

PR GRADING & SHAPING
TO BE DONE BY OTHERS

PR 3' AGG WEDGE SHLDR

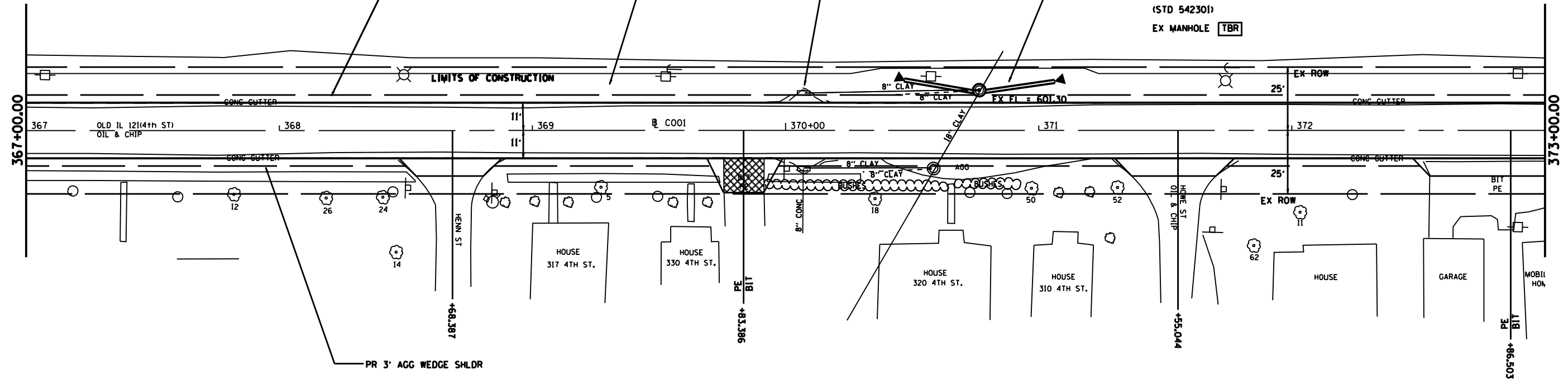

REVISIONS	
NAME	DATE

ILLINOIS DEPARTMENT OF TRANSPORTATION

**PLAN VIEW
FOURTH STREET**

SCALE: VERT. 1" = 4'
HORIZ. 1" = 40'

DATE: _____

DRAWN BY: BDK
CHECKED BY: JCN

PLOT DATE: 12/16/2008
 FILE NAME: c:\puro\proj\121\134RS-4\121\72A12\plan\plan.dwg
 PLOT SCALE: 1/4" = 10'
 USER NAME: jbranham