

160 150 140 130 120 110 100 90 80 70 60 50 40 30 20 10 0 10 20 30 40 50 60 70 80 90 100 110 120

PROP. F.A.P. 103

F.A. RTE.	SECTION	COUNTY	TOTAL SHEETS	SHEET NO.
103	27-1R	ST. CLAIR	382	223
STA.		TO STA.		
FED. ROAD DIST. NO.		ILLINOIS FED. AID PROJECT		
CONTRACT NO. 76300				

SPEC. DITCH MEDIAN
STA. 185+16.12 TO 186+50
AT +0.30 %

SPEC. DITCH LT. AC. RD.
STA. 185+16.12 TO 185+50
AT +18.42 %

SPEC. DITCH LEFT
STA. 185+16.12 TO 187+00
AT +0.40 %

SPEC. DITCH RIGHT
STA. 186+16.12 TO 187+50
AT +0.45 %

SPEC. DITCH RT. AC. RD.
STA. 185+16.12 TO 185+50
AT +7.82 %

DATE _____

BY _____

FINAL SURVEY _____

NOTED _____

NO. _____

AREAS CHECKED _____

DATE _____

BY _____

ORIGINAL SURVEY _____

NOTED _____

NO. _____

AREAS CHECKED _____

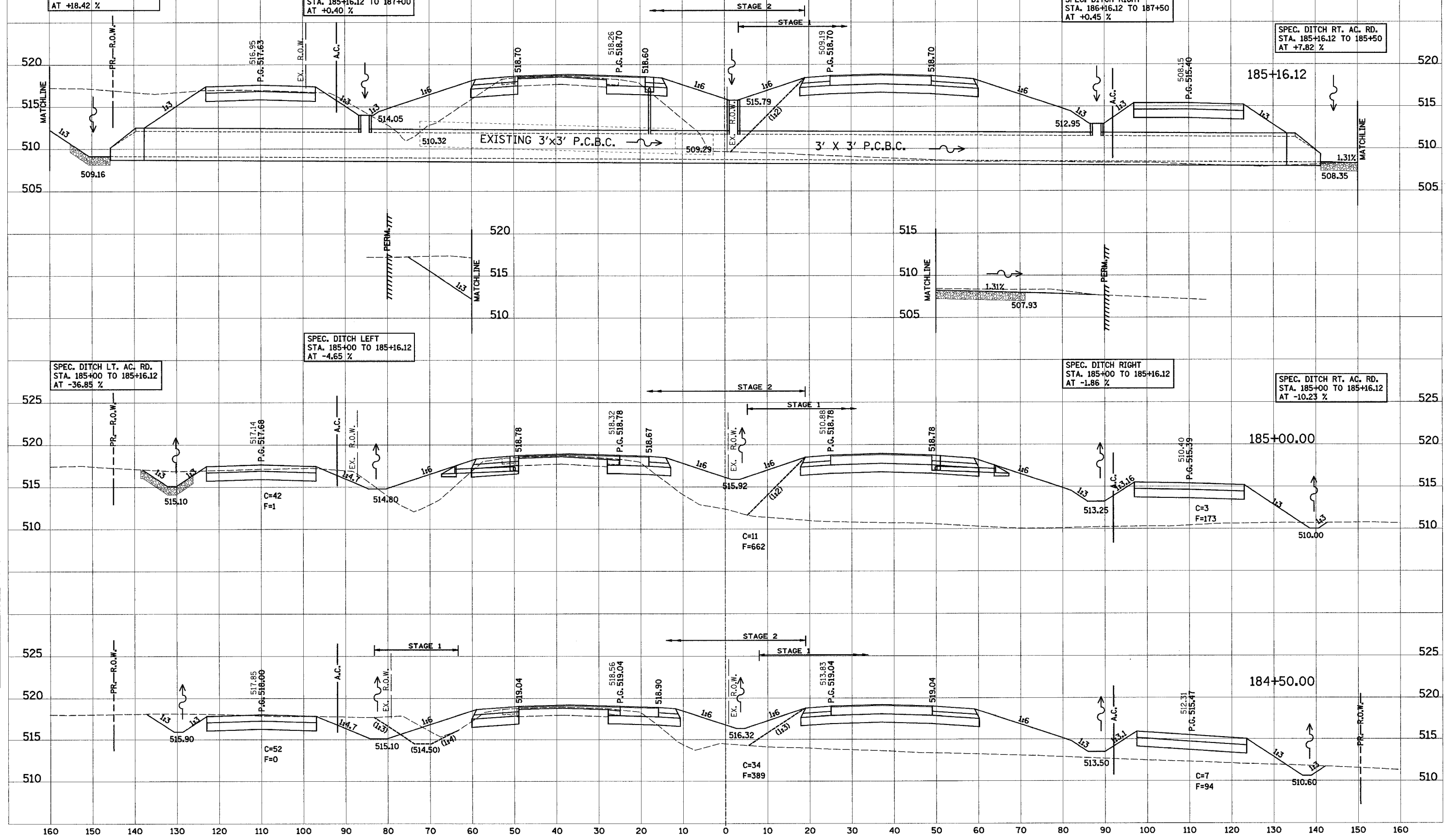

160 150 140 130 120 110 100 90 80 70 60 50 40 30 20 10 0 10 20 30 40 50 60 70 80 90 100 110 120 130 140 150 160