

F.A. RTE.	SECTION	COUNTY	TOTAL SHEETS	SHEET NO.
595	1 - 1	ROCK ISLAND	239	52
STA. 76+50.00		TO STA. 116+00.00		
FED. ROAD DIST. NO.	ILLINOIS	FED. AID PROJECT		
CONTRACT # 84986				

**SHEET LEGEND**

- ➔ INDICATES DIRECTION OF ONE LANE OF TRAFFIC
- BARRICADE OR DRUM WITH MONODIRECTIONAL STEADY BURN LIGHT
- H VERTICAL BARRICADE
- I TYPE III BARRICADE

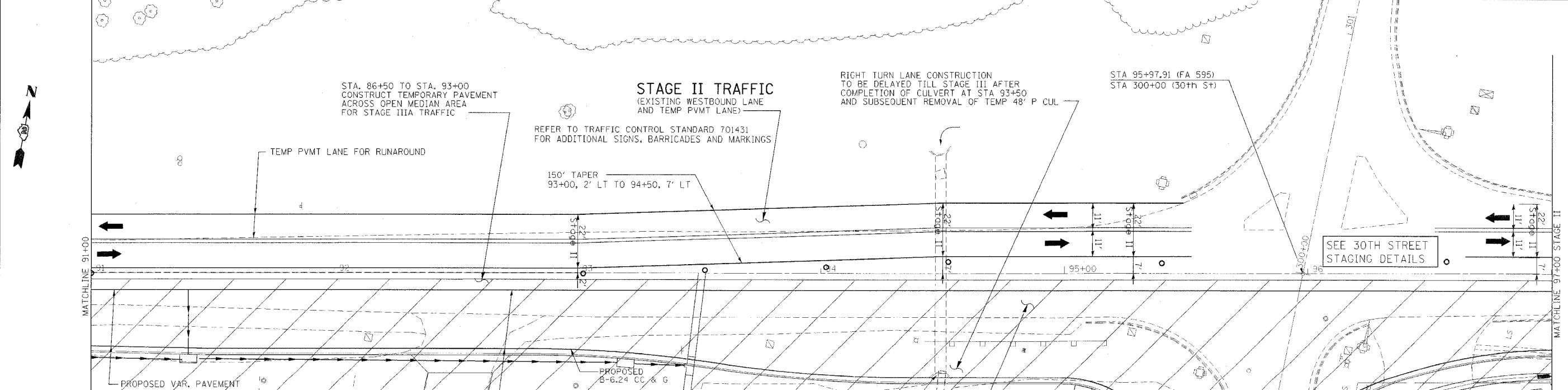
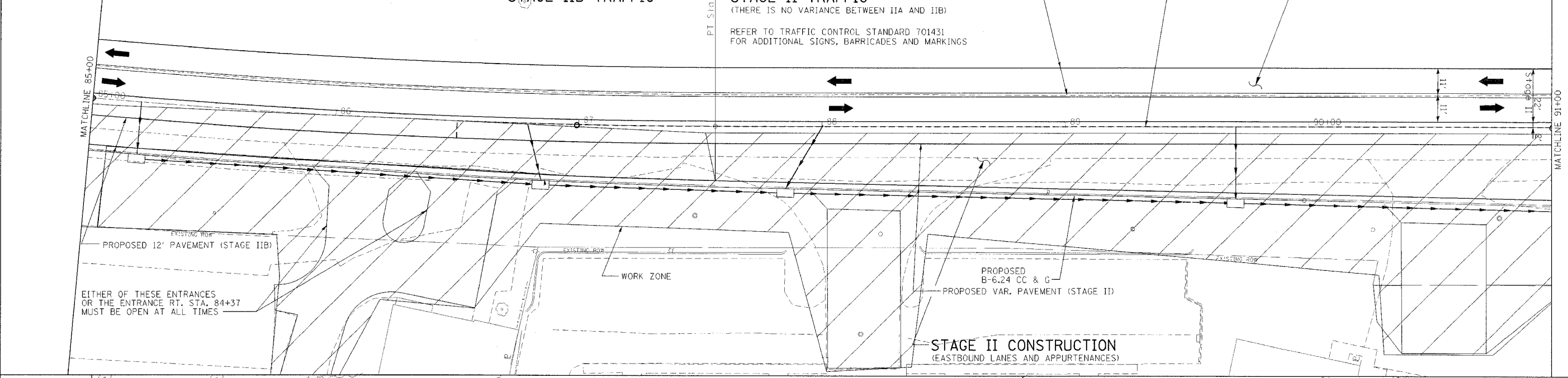

ILLINOIS PROFESSIONAL  
DESIGN FIRM NO. 184-001533

Stanley Consultants Inc.  
850 West Higgins Road, Suite 150, Chicago, Illinois 60630-2801  
www.stanleygroup.com

REVISIONS	
NAME	DATE

ILLINOIS DEPARTMENT OF TRANSPORTATION

**STAGE IIB / II STAGING DETAILS**

SCALE: VERT. \_\_\_\_\_  
HORIZ. \_\_\_\_\_

DATE \_\_\_\_\_ DRAWN BY \_\_\_\_\_  
CHECKED BY \_\_\_\_\_