

STATE OF ILLINOIS
DEPARTMENT OF TRANSPORTATION

ROUTE NO.	SECTION	COUNTY	SHEETS	PAGE	SHEET NO.
595	1-1	ROCK ISLAND	239	116	13 SHEETS
FED. ROAD DIST. NO. 2		T. 24008		FED. AID PROJECT	
Contract No. 84986					

GENERAL NOTES

- Contractor shall be responsible for design of timber lagging (per special provisions). Lagging design shall be submitted to Engineer for approval. Quantity shown in Bill of Materials is an estimate for bidding purposes only.
- Reinforcement bars shall conform to the requirements of AASHTO M31 or M322, Grade 60.
- All exposed edges of the concrete caps shall be chamfered $\frac{3}{4}$ " unless noted otherwise.
- All soldier piles shall be AASHTO M 270 Grade 50.
- For drainage details (inlets, storm sewers, pipe drains, etc. See roadway plan and profile sheets and drainage and utility sheets.
- Apply protective coat to all exposed concrete surfaces of the wall facing plus one foot below finished grade along the front of wall and one foot below top of wall along the back of wall.
- All construction joints shall be banded.

SUGGESTED SEQUENCE OF CONSTRUCTION

- Drill holes for soldier piles. Do not excavate near these holes at this stage.
- Set Soldier Piles.
- Fill hole with concrete to specified elevation.
- Fill remainder of hole with controlled low strength material.
- Begin earth excavation. Remove only earth and controlled low strength material as necessary to install timber lagging.
- Install geocomposite wall drain and pipe underdrain.
- Install stud shear connectors.
- Construct concrete wall facing.
- Install Pedestrian Railing.

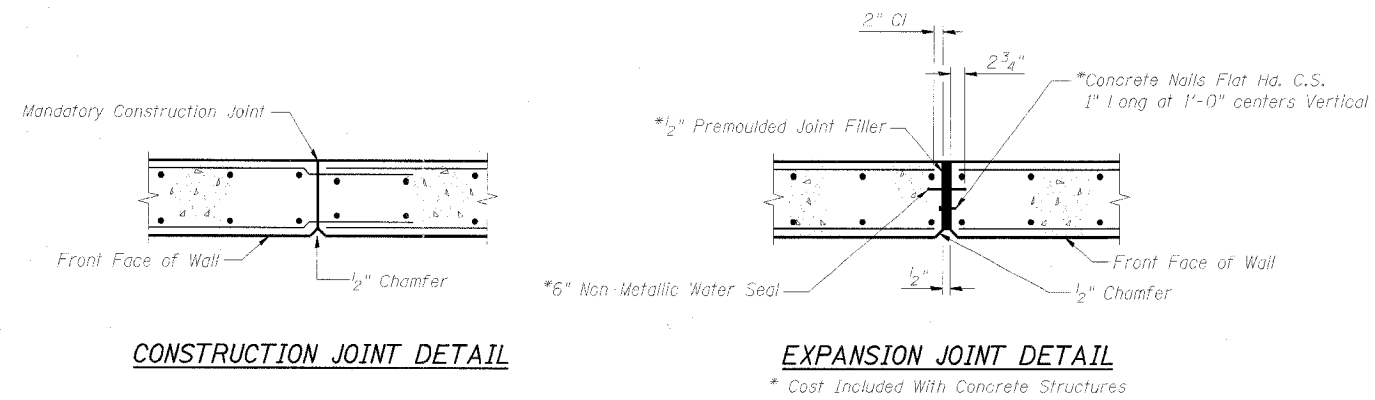

CONSTRUCTION JOINT DETAIL

EXPANSION JOINT DETAIL

RETAINING WALL JOINT DETAILS

TOTAL BILL OF MATERIAL

ITEM	UNIT	TOTAL
Structure Excavation	Cu Yd	345.1
Rock Excavation for Structures	Cu Yd	150.6
Protective Coat	Sq Yd	264.7
Concrete Structures	Cu Ft	242.6
Stud Shear Connectors	Each	564
Untreated Timber Lagging	Sq Ft	5,694
Furnishing Soldier Piles (W Section)	Foot	1793.9
Reinforcement Bars, Epoxy Coated	Pound	31,330
Pedestrian Railing	Foot	515.8
Geocomposite Wall Drain	Sq Yd	632.7
Concrete Gutter, Type B	Foot	444.7
Drilling and Setting Soldiers Piles in Soil	Cu Ft	2,744
Drilling and Setting Soldiers Piles in Rock	Cu Ft	7,786
Pipe Underdrain for Structures 4"	Foot	513.6

INDEX OF DRAWINGS

Sheet No.	Title
1	General Plan and Elevation
2	General Notes and Total Bill of Material
3	Typical Section and Detail
4	Soldier Pile Schedule
5	Wall Plan and Elevation
6	Wall Plan and Elevation
7	Wall Plan and Elevation
8	Wall Plan and Elevation
9	Wall Plan and Elevation
10	Wall Plan and Elevation
11	Wall Plan and Elevation
12	Pedestrian Railing
13	Soil Boring Logs B-1 and B-2
14	Soil Boring Logs B-3 and B-4
15	Soil Boring Logs B-5 and B-6
16	Soil Boring and Rock Core Log B-7
17	Soil Boring and Rock Core Log B-8
18	Soil Boring and Rock Core Log B-9

Illinois Firm Registration No. 084-00533



**GENERAL NOTES AND TOTAL BILL OF MATERIALS
RETAINING WALL D ALONG
IL ROUTE 5
FA 595 (IL ROUTE 5) SECTION 1-1
ROCK ISLAND COUNTY
STA 76+50.00 TO STA 81+70.00
STRUCTURE NO. 081-W006**

DESIGNED	-	NDR
CHECKED	-	DSE
DRAWN	-	RTT
CHECKED	-	DSE
DATE	-	JAN 31, 2006