

STATE OF ILLINOIS
DEPARTMENT OF TRANSPORTATION

ROUTE NO.	SECTION	COUNTY	TOTAL SHEETS	SHEET NO.	SHEET NO. 6
595	I-1	ROCK ISLAND	239	120	19 SHEETS
FED. ROAD DIST. NO. 7		ILLINOIS	FED. AID PROJECT NO.		
Contract No. 84906					

BILL OF MATERIAL

Bar	No.	Size	Length	Shape
d1 (L)	36	#4	2'-0"	□
h6 (E)	54	#6	32'-7"	—
h8 (E)	30	#6	29'-8"	—
h10 (E)	1	#4	31'-8"	—
h11 (E)	2	#4	29'-8"	—
h12 (E)	2	#4	27'-1"	—
h13 (E)	2	#4	19'-10"	—
h14 (E)	2	#4	14'-3"	—
v4 (E)	186	#4	10'-0"	—
v5 (E)	62	#4	5'-4"	—
v6 (E)	62	#4	6'-3"	—
v7 (E)	62	#4	7'-2"	—
Structure Excavation		Cu Yd	14.1	
Rock Excavation		Cu Yd	7.2	
For Structures				
Concrete Structures		Cu Yd	18.1	
Reinforcement Bars, Epoxy Coated		Pound	6250	

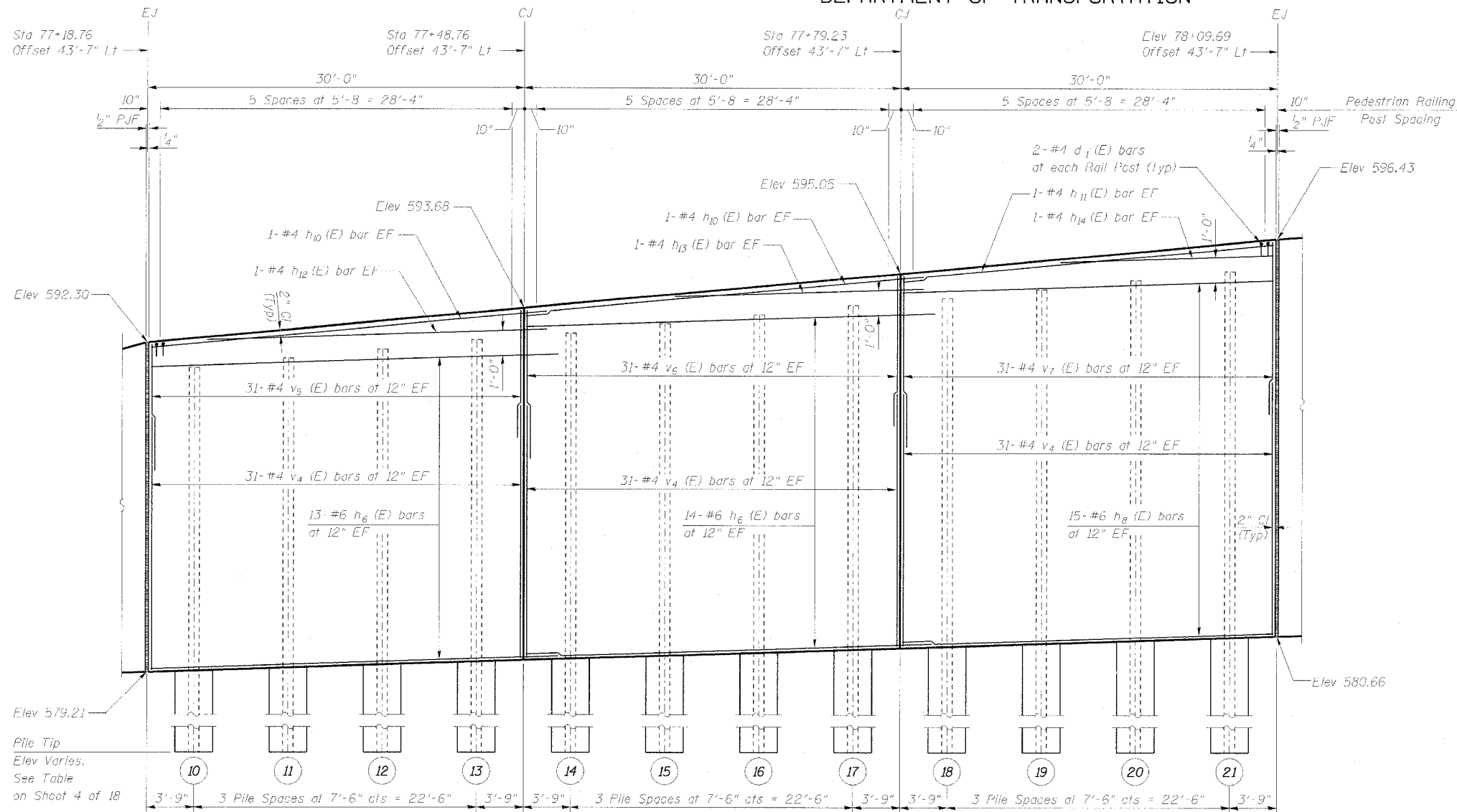
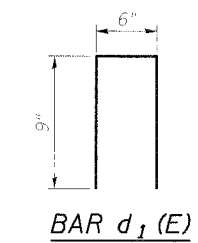

FRONT FACE ELEVATION

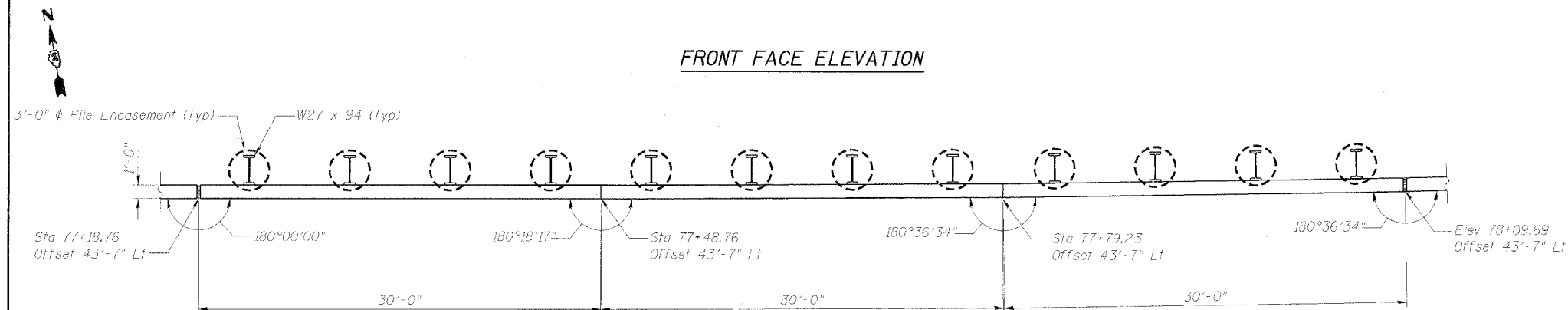

PLAN

DESIGNED	-	NDR
CHECKED	-	DSE
DRAWN	-	RTT
CHECKED	-	DSE
DATE	-	JAN 31, 2006

Reinforcement bars designated (E) shall be epoxy coated.
See Sheet 2 of 18 for Expansion Joint and Water Seal Placement Detail.
See Sheet 12 of 18 for Pedestrian Railing Details.
See Sheet 3 of 18 for Retaining Wall, Typical Section and Underdrain Details.
Min Lap Length: #4 bar = 1'-8"
#6 bar = 2'-7"

Illinois Firm Registration No. 084-00533

850 West Higgins Road, Suite 730, Chicago, Illinois 60631-2803
www.stanleygroup.com

WALL PLAN AND ELEVATION
RETAINING WALL D ALONG
IL ROUTE 5
FA 595 (IL ROUTE 5) SECTION I-1
ROCK ISLAND COUNTY
STA 76+50.00 TO STA 81+70.00
STRUCTURE NO. 081-W006