

# THREE CENTER CURVE DATA

## SYMMETRICAL CURVES

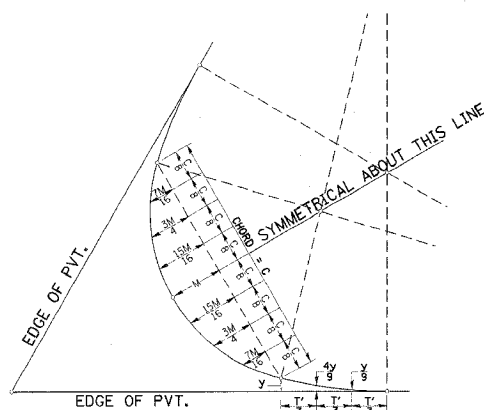

CURVE #									
R <sub>1</sub>									
R <sub>2</sub>									
R <sub>3</sub>									
O									
Δ									
T									
T <sub>1</sub>									
T <sub>2</sub>									
T'									
y									
4y/9									
y/9									
M									
15M/16									
3M/4									
7M/16									
C									

FIELD LAYOUT METHOD

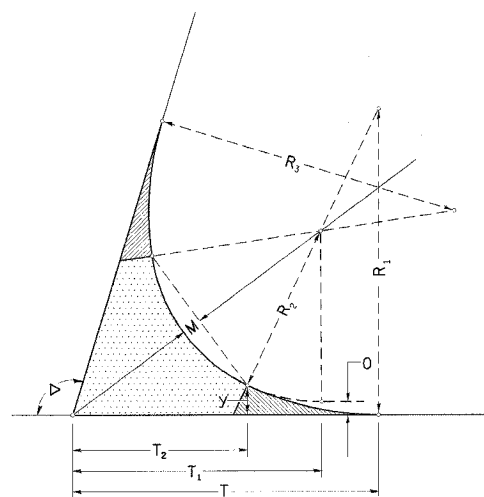

ALL DIMENSIONS ARE IN FEET UNLESS OTHERWISE NOTED.

FOR SYMMETRICAL CURVES

# TWO CENTER CURVE DATA

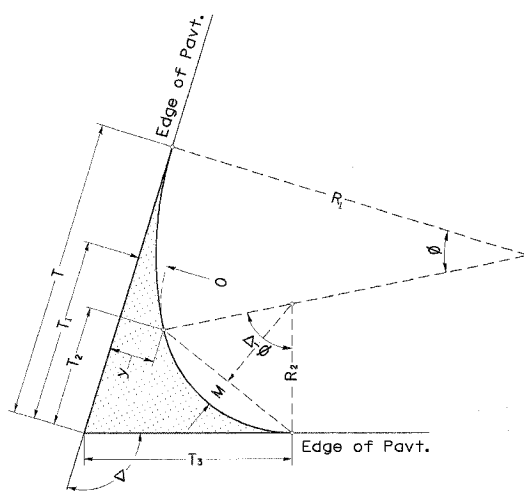

TWO CENTER CURVES

CURVE #	30TH STREET INTERSECTION RADII			
	SW	SE	NW	NE
R <sub>1</sub>	150'	200'	320'	300'
R <sub>2</sub>	50'	40'	80'	60'
O	10.65'	14.00'	16.00'	13.75'
Δ	101° 36' 30"	78° 23' 30"	78° 23' 30"	101° 36' 30"
T	108.40'	95.20'	148.11'	156.50'
T <sub>1</sub>	63.50'	29.74'	61.95'	76.40'
T <sub>2</sub>	41.05'	13.38'	33.23'	56.38'
T <sub>3</sub>	72.18'	46.91'	81.57'	87.63'
y	15.97'	17.50'	21.33'	17.20'
4y/9	7.10'	7.78'	9.48'	7.64'
y/9	1.77'	1.94'	2.37'	1.91'
M	10.31'	4.40'	9.81'	14.76'
15M/16	9.67'	4.13'	9.20'	13.83'
3M/4	7.73'	3.30'	7.36'	11.07'
7M/16	4.51'	1.93'	4.29'	6.46'
C	60.83'	36.47'	76.78'	78.82'

# TRAFFIC CONTROL AND PROTECTION AT TURN BAYS (TO REMAIN OPEN TO TRAFFIC)

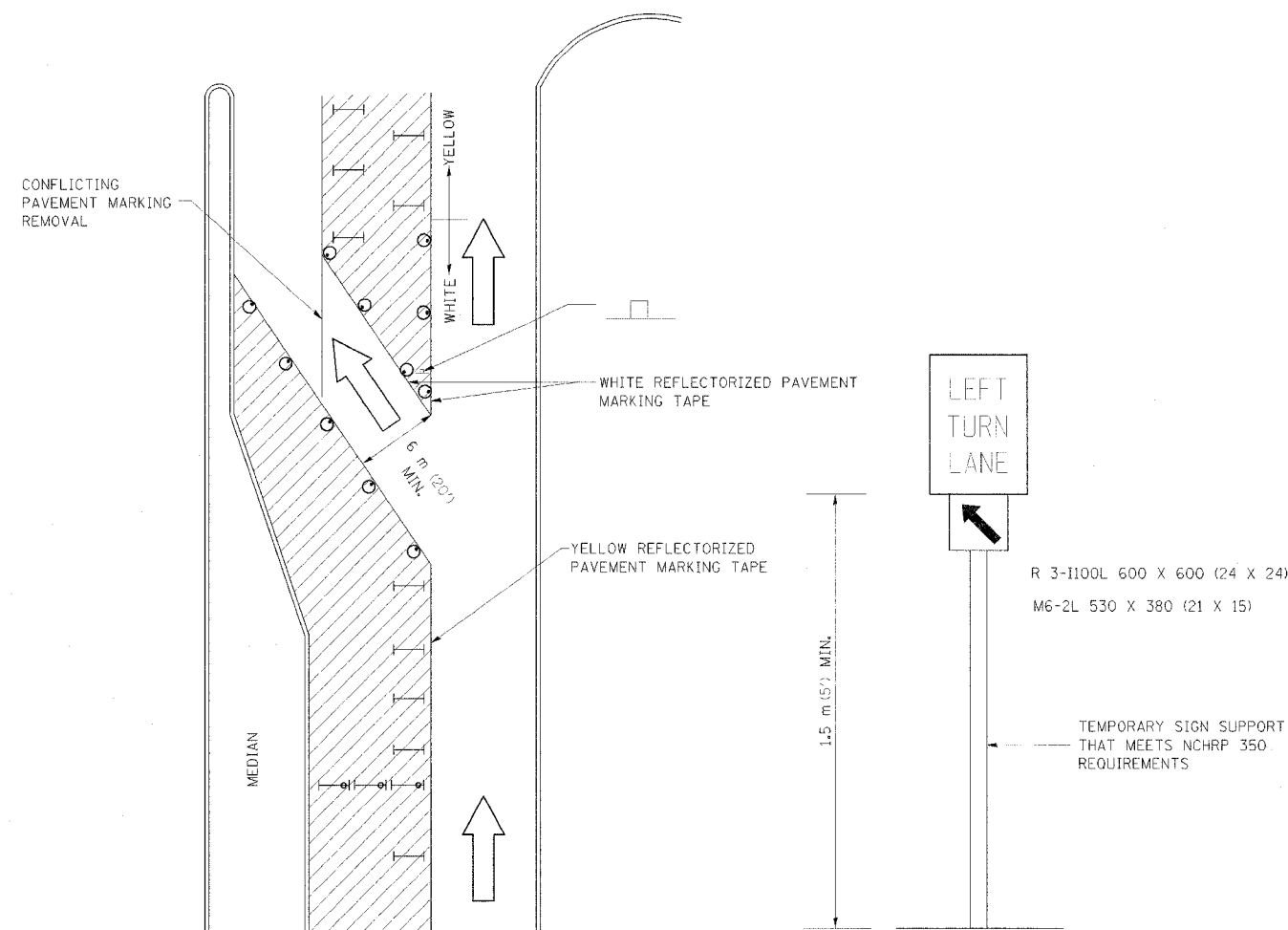

## LEGEND

- WORK AREA
- LANE OPEN TO TRAFFIC
- TYPE I OR II BARRICADE OR DRUM WITH FLASHING BURNING LIGHT
- DRUM OR BARRICADE WITH STEADY BURN LIGHT
- SIGN (SEE DETAIL)
- TYPE I OR II CHECK BARRICADE WITH STEADY LIGHT BURN

## GENERAL NOTES

- CONES MAY BE SUBSTITUTED FOR BARRICADES OR DRUMS AT HALF THE SPACING DURING DAY OPERATIONS. CONES SHALL BE A MINIMUM OF 710 (28) IN HEIGHT.
- STEADY BURNING LIGHTS WILL NOT BE REQUIRED ON BARRICADES OR DRUMS FOR DAY OPERATIONS. ALL LIGHTS WILL BE MONODIRECTIONAL.
- REFLECTORIZED TEMPORARY PAVEMENT MARKING TAPE SHALL BE PLACED THROUGHOUT THE BARRICADED AREA OF EACH BAY WHERE THE CLOSURE TIME IS GREATER THAN FOURTEEN DAYS.
- THIS APPLICATION ALSO APPLIES WHEN WORK IS BEING PERFORMED IN THE RIGHT LANE(S) AND THE RIGHT TURN BAY IS TO REMAIN OPEN. UNDER THIS CONDITION, "RIGHT TURN LANE" R3-100 600 x 600 (24 x 24) AND M6-2R 530 X 380 (21 x 15) SHALL BE USED.
- THESE CONTROLS SHALL SUPPLEMENT MAINLINE TRAFFIC CONTROL FOR LANE CLOSURES.
- LONGITUDINAL DIMENSIONS MAY BE ADJUSTED TO FIT FIELD CONDITIONS.
- TRAFFIC CONTROL AND PROTECTION AT TURN BAYS (TO REMAIN OPEN TO TRAFFIC) SHALL BE INCLUDED IN THE COST SPECIFIED TRAFFIC CONTROL STANDARDS OR ITEMS.
- ALL DIMENSIONS ARE IN MILLIMETERS (INCHES) UNLESS OTHERWISE NOTED.