

DATE	
BY	
CHECKED	
DESIGNED	
DRAWN	
IN CHARGE	
APPROVED	
REVISIONS	

DATE	
BY	
CHECKED	
DESIGNED	
DRAWN	
IN CHARGE	
APPROVED	
REVISIONS	

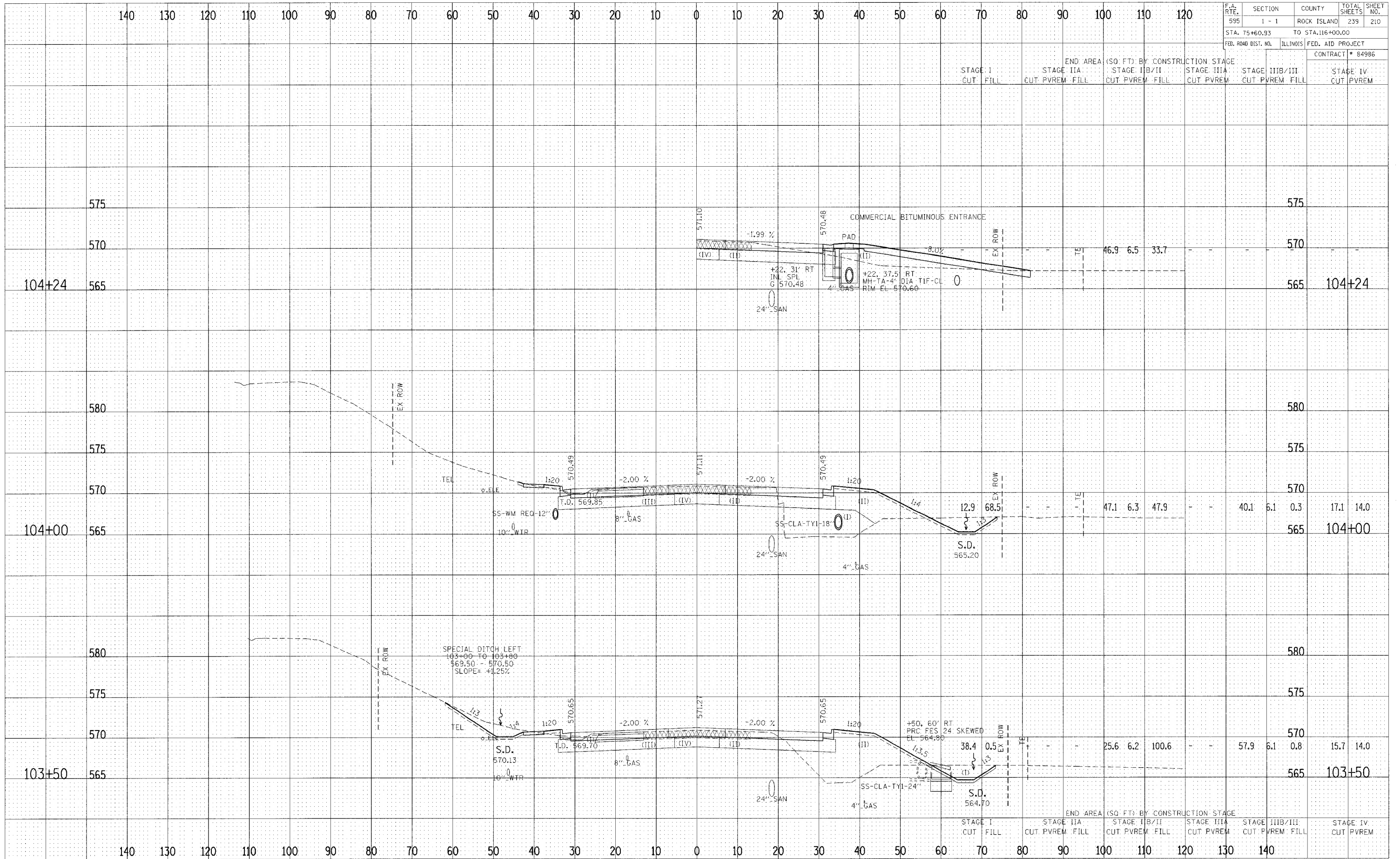

F.A. RTE.	SECTION	COUNTY	TOTAL SHEETS	SHEET NO.
595	1 - 1	ROCK ISLAND	239	210
STA. 75+60.93	TO STA. 116+00.00			
FED. ROAD DIST. NO.	ILLINOIS	FED. AID PROJECT	CONTRACT # 84986	

STAGE I	STAGE II	STAGE III	STAGE IV
CUT	CUT	CUT	CUT
FILL	PVREM	PVREM	PVREM

CROSS SECTIONS - F.A. 595 (IL RTE 5)