

ROUTE NO.	SECTION	COUNTY	TOTAL SHEETS	SHEET NO.
S.B.L. 224	04-00137-01-FP	HENRY	25	23
FED. ROAD DIST. NO. 7		ILLINOIS	FID. AD. PROJ. SP. NO.	

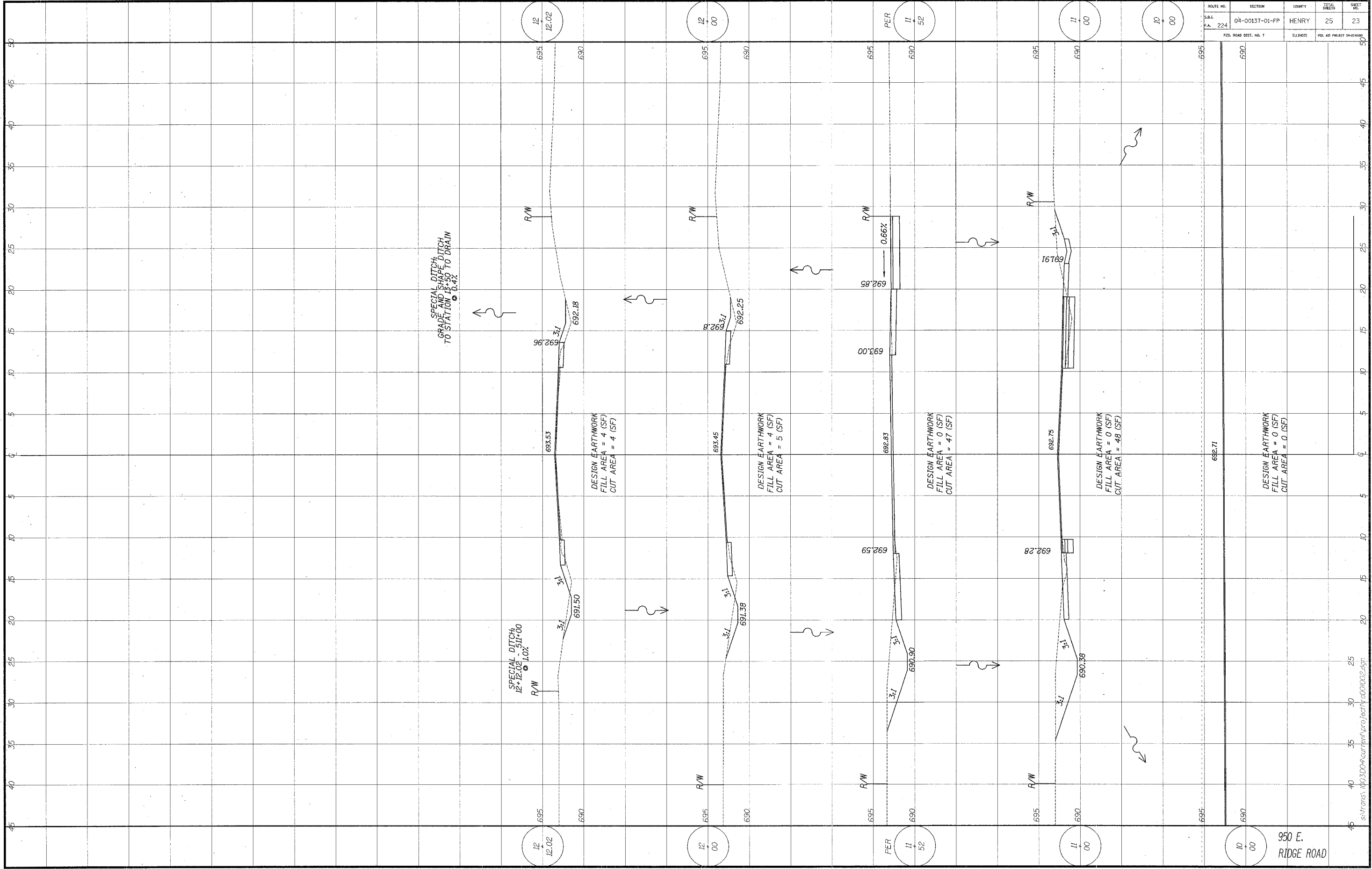

950 E. RIDGE ROAD

ss:\trans\100300\4-corr\plan\cor\lect\c001002.dgn