

ROUTE NO.	SECTION NO.	TOTAL SHEET
F.A.U. 6578	03-0019-1 1-FP	98
F.A.U. 6679		
FED. ROAD DIST. NO.	COUNTY	PROJECT
	PEORIA	M-5093
	ILLINOIS	
CONTRACT NO. 89369		

**CONSTRUCTION STAGING (SUGGESTED)**

THE CONTRACTOR WILL PERFORM ALL PHASE WORK BY CLOSING ONE LANE OF TRAFFIC WHEN NECESSARY IN ACCORDANCE WITH ILLINOIS DEPARTMENT OF TRANSPORTATION STANDARDS. DURING NON-WORKING HOURS BOTH LANES OF TRAFFIC WILL REMAIN OPEN. ACCESS WILL BE MAINTAINED TO ALL BUSINESSES AND SCHOOLS EXCEPT AS DIRECTED BY THE ENGINEER. DRAINAGE AND UTILITIES WILL BE MAINTAINED AT ALL TIMES EXCEPT TO MAKE NEW CONNECTIONS

PHASE 9 (HATCHED AREA)  
CONSTRUCT NEW PAVEMENT

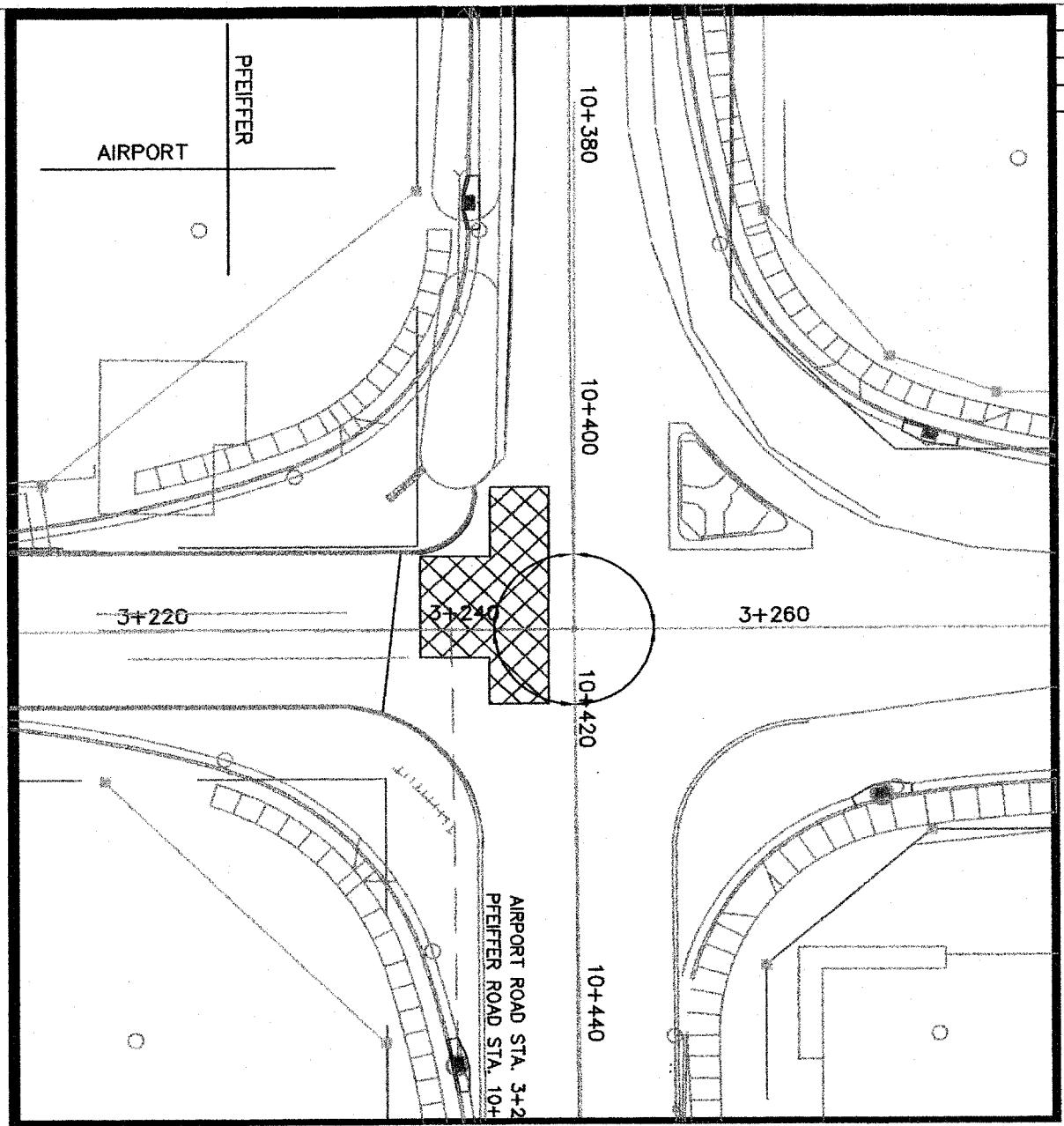
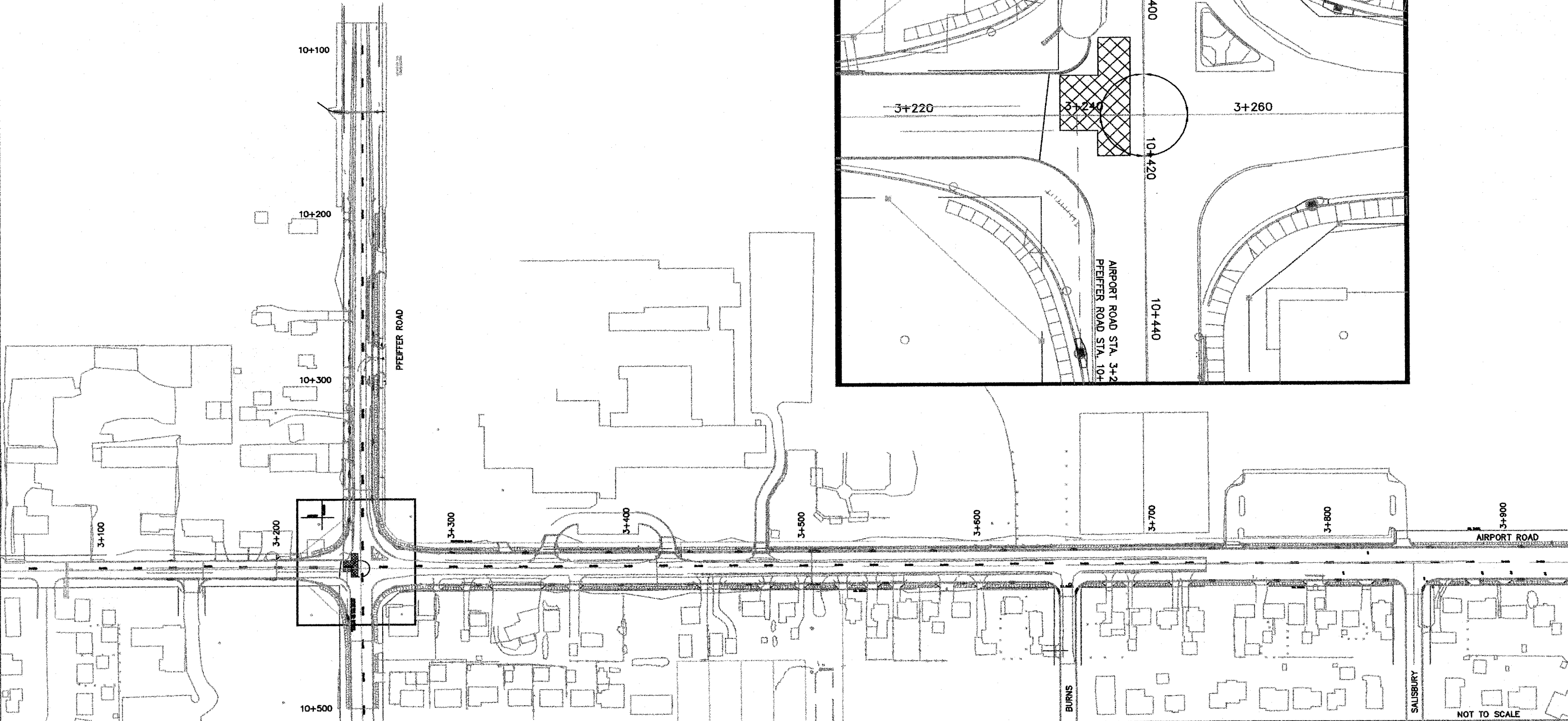

NOT TO SCALE