

INDEX OF SHEETS

SHT. NO.	DESCRIPTION
1	COVER SHEET
2	INDEX OF SHEETS, COMMITMENTS, LIST OF STANDARDS, GENERAL NOTES AND JOB SPECIFIC NOTES
3	SUMMARY OF QUANTITIES
4	SCHEDULE OF QUANTITIES
5	TYPICAL SECTIONS
6	ALIGNMENT, TIES, BENCHMARKS AND STATUS OF UTILITIES
7	REMOVAL PLANS
8	ROADWAY AND DRAINAGE PLAN AND PROFILES
9	PAVEMENT MARKING
10	MISCELLANEOUS DETAILS
11-15	CROSS SECTIONS
16-20	DISTRICT 4 CADD STANDARDS: 406101-D4 BUTT JOINTS (2) 440001-D4 BITUMINOUS SURFACE REMOVAL (COLD MILLING) 602001-D4 INLETS, TYPE G-1 604001-D4 FRAME AND GRATES FOR TYPE G-1 AND TYPE G-1, SPECIAL DRAINAGE STRUCTURES 780001-D4 TYPICAL PAVEMENT MARKINGS (2)

LIST OF STANDARDS

- 000001-04 STANDARD SYMBOLS, ABBREVIATIONS AND PATTERNS
- 280001-02 TEMPORARY EROSION CONTROL SYSTEMS
- 542301 PRECAST REINFORCED CONCRETE FLARED END SECTION
- 604011-02 FRAME AND LIDS, TYPE 1
- 606001-02 CONCRETE CURB TYPE B AND COMBINATION CONCRETE CURB AND GUTTER
- 701301-02 LANE CLOSURE 2L, 2W - SHORT TIME OPERATION
- 701311-02 LANE CLOSURE 2L, 2W - MOVING OPERATION DAY ONLY
- 701326-02 LANE CLOSURE 2L, 2W - PAVEMENT WIDENING, FOR SPEEDS: ≥45 MPH
- 701501-03 URBAN LANE CLOSURE, 2L, 2W UNDIVIDED
- 702001-06 TRAFFIC CONTROL DEVICES
- 780001-01 TYPICAL PAVEMENT MARKINGS

COMMITMENTS

NO COMMITMENTS HAVE BEEN MADE FOR THIS PROJECT.

GENERAL NOTES

UTILITIES - LOCATIONS/INFORMATION ON PLANS

The locations of existing water mains, gas mains, sewers, electric power lines, telephone lines and other utilities as shown on the plans are based on careful field investigation and the best information available, but they are not guaranteed. Unless elevations are shown --- all utility locations shown on the cross sections are based on the approximate depth supplied by the utility company. It shall be the Contractor's responsibility to ascertain their exact location from the utility companies and by field inspection.

PLAN ELEVATIONS - U.S.G.S. MEAN SEA LEVEL DATUM

All elevations shown on the plans are established from U.S.G.S. mean sea level datum.

PROPERTY OWNER ACCESS REQUIREMENT

Access must be maintained to all existing properties during construction per Article 107.09 unless arrangements are made in writing by the Contractor with the property owners with a copy to the Engineer for short-term closures.

TEMPORARY MATERIAL REQUIREMENTS - UTILITY AND DRIVEWAY CROSSINGS

Incidental bituminous surface shall be used for all temporary side road crossings. Aggregate surface course may be used for all driveway crossings except during winter shutdown in accordance with Article 107.09.

CONSECUTIVE SIDE STREET (ROAD) CLOSURE - PROHIBITED

No two consecutive side streets (roads or school driveways) may be closed at the same time during construction. The contractor must alternate streets (roads).

ENVIRONMENTAL REVIEWS

Prior to the use of any proposed borrow areas, use areas (temporary access roads, detours, run-arounds, etc.) and/or waste areas, the Contractor shall file the required environmental resource request surveys according to Section 107.22 of the Standard Specifications. These surveys are required in order for the Department to conduct cultural and biological resource surveys for the proposed site.

Prior to any waste materials being removed from the construction site the required environmental resource surveys will need to be obtained and filed by the Contractor. Excess waste products removed from the construction site shall be disposed of as required in Section 202.03 of the Standard Specifications.

Any protruding metal bars shall be removed prior to the disposal of broken concrete at approved disposal sites.

The required environmental resource documentation shall include the following:

- BDE Form 2289 (Environmental Survey Request)
- A location map showing the size limits and location of the use area
- Signed property owner agreement form
- Color photographs depicting the use area

Please note that a minimum of two weeks shall be allowed for the District to obtain the required environmental clearances.

EARTH EXCAVATION - INCIDENTAL TO CURB, GUTTER AND DRIVEWAY

Earth excavation and backfill for proposed curb and gutters and driveway pavements shall be included in the unit cost of the various items.

LABORATORY TESTING OF SUPERPAVE MIXES

Some aggregate compositions produce inconsistent results when burned in the ignition oven. The Engineer will determine whether the ignition oven or AC nuclear gauge will be required after the aggregate sources have been identified.

BITUMINOUS CONCRETE MIXTURE REQUIREMENTS

Mixture Uses(s):	BITUMINOUS CONCRETE BINDER COURSE, SUPERPAVE
RAP % (Max)**:	25%
AC/PG:	PG 64-27
Design Air Voids:	4.2% @ N = 50
Mixture Composition: (Gradation Mixture)	IL 19.0
Friction Aggregate	N/A
Mixture Uses(s):	POLYMERIZED BITUMINOUS CONCRETE SURFACE COURSE, SUPERPAVE N50
RAP % (Max)**:	0%
AC/PG:	SBR OR SBS PG 70-22
Design Air Voids:	4.2% @ N = 50
Mixture Composition: (Gradation Mixture)	IL 9.5 OR 12.5
Friction Aggregate	MIX D
Mixture Uses(s):	BITUMINOUS SHOULDERS, SUPERPAVE
RAP % (Max)**:	50%
AC/PG:	PG 58-22
Design Air Voids:	2.0%
Mixture Composition: (Gradation Mixture)	CA-6, CA-10
Friction Aggregate	N/A

**If the RAP option is selected, the asphalt cement grade may need to be adjusted; this will be determined by the Engineer.

PAVING SURFACE COURSE, CONTINUOUS

Continuous paving operations on the main roadway shall be maintained at all times during the construction of the bituminous surface. No interruptions for side roads, entrances, turn lanes, etc. will be allowed.

REFLECTIVE CRACK CONTROL TREATMENT

Reflective crack control treatment shall be placed on the binder course.

ORDERING LENGTH CONFIRMATION - DRAINAGE ITEMS

The Contractor shall consult with the Engineer in regard to the exact length of the box/pipe culverts, storm sewers, and/or pipe drains required prior to ordering these items.

EXISTING DRAINAGE PIPES CONNECTED TO NEW STRUCTURES

In accordance with Section 602 of the Standard Specifications, the connecting of existing drain tiles, pipe culverts, or storm sewers to the proposed drainage system structures will not be paid for separately but shall be considered as included in the pay items provided.

SIGNING

Sign locations may vary from the stations shown on the plans in accordance with directions from the Engineer at the time of construction. Sign locations may be adjusted in the field to avoid any found utilities. All wood post locations shall be verified with the Bureau of Operations, Traffic Section, before installation. ITEMS NOT MARKED FOR REMOVAL
Items within temporary easements that are not marked for removal or relocation are to be left unaltered.

TRANSITION PAYMENT METHOD - NEW/OLD CONSTRUCTION

Ten feet transitions shall be used to match proposed items of work to existing items in the field unless otherwise shown. The transition shall be paid at the contract unit price for the proposed item of work specified.

JOB SPECIFIC NOTES

SAW CUT

A full depth saw cut will be required at the joint between the driving lane and the bituminous shoulder prior to the shoulder removal. This work will not be paid for separately but shall be included in the bituminous shoulder removal.

TOP SOIL

Existing Top Soil from cut areas shall be used as Top Soil on Proposed Fill. Cost included in EARTH EXCAVATION and EMBANKMENT.

Contract 89393

SUMMARY OF QUANTITIES				TAZEWELL COUNTY	
				CONSTRUCTION TYPE CODE	
				ROADWAY	
CODE NO.	PAY ITEM	UNIT	TOTAL QUANTITY	1 000-2A	
20200100	EARTH EXCAVATION	CU YD	567	567	
20800150	TRENCH BACKFILL	CU YD	3	3	
* 25000210	SEEDING, CLASS 2A	ACRE	0.40	0.40	
* 25000400	NITROGEN FERTILIZER NUTRIENT	POUND	36	36	
* 25000500	PHOSPHORUS FERTILIZER NUTRIENT	POUND	36	36	
* 25000600	POTASSIUM FERTILIZER NUTRIENT	POUND	36	36	
* 25100105	MULCH, METHOD 1	ACRE	0.40	0.40	
28000500	INLET AND PIPE PROTECTION	EACH	2	2	
20800510	INLET FILTERS	EACH	3	3	
28100125	STONE RIPRAP, CLASS B3	SQ YD	20	20	
28200200	FILTER FABRIC	SQ YD	20	20	
35101100	AGGREGATE BASE COURSE, TYPE A 12"	SQ YD	1,071	1,071	
40600200	BITUMINOUS MATERIALS (PRIMECOAT)	TON	3.3	3.3	
40600300	AGGREGATE (PRIMECOAT)	TON	6.0	6.0	
44000006	BITUMINOUS SURFACE REMOVAL 1 1/2"	SQ YD	3,202	3,202	
44000500	COMBINATION CURB AND GUTTER REMOVAL	FOOT	13	13	
44001430	BITUMINOUS SHOULDER REMOVAL	SQ YD	1,172	1,172	
44300200	STRIP REFLECTIVE CRACK CONTROL TREATMENT	FOOT	1,166	1,166	
54010103	PRECAST CONCRETE BOX CULVERT 5' X 3'	FOOT	8	8	
54213657	PRECAST REINFORCED CONCRETE FLARED END SECTIONS 12"	EACH	2	2	
54248515	CONCRETE COLLAR	EACH	1	1	
550A0050	STORM SEWER, CLASS A, TYPE 1 12"	FOOT	98	98	
60241800	INLETS, TYPE G-1	EACH	3	3	
60605000	COMBINATION CONCRETE CURB AND GUTTER, TYPE B-6.24	FOOT	841	841	
67100100	MOBILIZATION	L SUM	1	1	
70101700	TRAFFIC CONTROL AND PROTECTION	L SUM	1	1	
70300100	SHORT TERM PAVEMENT MARKING	FOOT	233	233	
70301000	WORK ZONE PAVEMENT MARKING REMOVAL	SQ FT	70	70	
* 78001100	PAINT PAVEMENT MARKING - LETTERS AND SYMBOLS	SQ FT	47	47	
* 78001110	PAINT PAVEMENT MARKING LINE - 4"	FOOT	5,064	5,064	
* 78001140	PAINT PAVEMENT MARKING LINE - 8"	FOOT	225	225	
* 78001150	PAINT PAVEMENT MARKING LINE - 12"	FOOT	165	165	

* SPECIALTY ITEMS

SUMMARY OF QUANTITIES				TAZEWELL COUNTY	
				CONSTRUCTION TYPE CODE	
				ROADWAY	
CODE NO.	PAY ITEM	UNIT	TOTAL QUANTITY	1 000-2A	
X0301766	DRILL AND GROUT #6 TIE BARS	EACH	6	6	
X0320547	REMOVE AND REINSTALL END SECTION	EACH	1	1	
X0322996	END SECTIONS TO BE RELOCATED	EACH	1	1	
X4066524	POLYMERIZED BITUMINOUS CONCRETE SURFACE COURSE, SUPERPAVE, MIX'D N50	TON	362	362	
X6063600	COMBINATION CONCRETE CURB AND GUTTER, TYPE M-6.24	FOOT	80	80	
XX002804	STORM SEWERS, PVC 12" (SPECIAL)	FOOT	6	6	
XX004093	CONCRETE SLOPEWALL REMOVAL	SQ FT	170	170	
XX005347	BITUMINOUS CONCRETE BINDER COURSE, SUPERPAVE N50	TON	270	270	
Z0013798	CONSTRUCTION LAYOUT	L SUM	1	1	



NORTH MAIN STREET IMPROVEMENT

SUMMARY OF QUANTITIES

SURVEY	CHECKED	ISSUE DATE
DESIGN	APPROVED	02-21-08
REW	PRELIM. DATE	
DRAWN	DLC	PROJECT NO. ILS00003

SHEET
3
OF
20

EARTH SUMMARY SCHEDULE				
	EARTH EXCAVATION	EARTH EXCAVATION ADJUSTED FOR SHRINKAGE *	EMBANKMENT	EARTHWORK BALANCE WASTE (+) OR SHORTAGE (-)
LOCATION	CU YD	CU YD	CU YD	CU YD
ENTIRE PROJECT	567	426	265	161
TOTAL	567	426	265	161

* 25% SHRINKAGE FACTOR

PERMANENT SEEDING SCHEDULE							
LOCATION		ACRE	SEEDING, CLASS 2A	NITROGEN FERTILIZER NUTRIENT	PHOSPHORUS FERTILIZER NUTRIENT	POTASSIUM FERTILIZER NUTRIENT	MULCH, METHOD 1
STA. 8+96.00	TO STA. 11+00.00	0.060		5.40	5.40	5.40	0.060
STA. 11+75.00	TO STA. 15+75.00	0.290		26.10	26.10	26.10	0.290
STA. 16+50.00	TO STA. 17+75.00	0.035		3.15	3.15	3.15	0.035
STA. 18+55.00	TO STA. 20+60.00	0.010		0.90	0.90	0.90	0.010
TOTAL		0.40		36	36	36	0.40

NITROGEN, PHOSPHORUS, AND POTASSIUM USE 90 lb/acre

INLET AND PIPE PROTECTION SCHEDULE		
LOCATION	INLET AND PIPE PROTECTION EACH	
STA. 12+40	40' Lt	1
STA. 18+44	28' Lt	1
TOTAL		2

DRILL AND GROUT #6 TIE BARS		
LOCATION		EACH
STA. 8+93.50	LT	2
STA. 17+76.00	LT	2
STA. 18+55.00	LT	2
TOTAL		6

PAVEMENT REMOVAL SCHEDULE			
LOCATION		BITUMINOUS SURFACE REMOVAL 1.5" SQ YD	BITUMINOUS SHOULDER REMOVAL SQ YD
STA. 8+93.50	TO STA. 20+60.00	3,202.0	1,172.00
TOTAL		3,202	1,172

REMOVAL SCHEDULE				
LOCATION			COMBINATION CURB AND GUTTER REMOVAL FT	CONCRETE SLOPEWALL REMOVAL SQ FT
STA. 8+94.00	TO STA. 8+99.00	LT	5.00	
STA. 12+36.00	TO STA. 12+70.00	LT		170.00
STA. 17+73.00	TO STA. 17+76.00	LT	3.00	
STA. 18+55.00	TO STA. 18+60.00	LT	5.00	
TOTAL			13	170

MOBILIZATION SCHEDULE	
LOCATION	MOBILIZATION L. SUM
ENTIRE PROJECT	1
TOTAL	1

CONSTRUCTION LAYOUT SCHEDULE	
LOCATION	CONSTRUCTION LAYOUT L. SUM
ENTIRE PROJECT	1
TOTAL	1

TRAFFIC CONTROL AND PROTECTION SCHEDULE	
LOCATION	TRAFFIC CONTROL AND PROTECTION L. SUM
ENTIRE PROJECT	1
TOTAL	1

PAVING SCHEDULE							
LOCATION		WIDENING AREA SQ YD	POLYMER FILL BITUMINOUS CONCRETE SURFACE COURSE, SUPERPAVE, MIX D, N50 TON	BITUMINOUS CONCRETE BINDER COURSE, SUPERPAVE, N50 TON	BITUMINOUS MATERIALS (PRIME COAT) TON	AGGREGATE (PRIME COAT) TON	AGGREGATE BASE COURSE, TYPE A, 12" SQ YD
STA. 8+93.50	TO STA. 10+25.00	56.0	32.0	14.11	0.1		56.0
STA. 10+25.00	TO STA. 13+75.00	336.0	110.5	84.67	1.1	2.0	336.0
STA. 13+75.00	TO STA. 16+15.00	360.0	85.1	90.72	1.0	1.5	360.0
STA. 16+15.00	TO STA. 17+76.00	197.0	57.5	49.64	0.6	1.1	197.0
STA. 17+76.00	TO STA. 18+55.00		23.7		0.1	0.6	
STA. 18+55.00	TO STA. 20+60.00	122.0	53.2	30.74	0.4	0.6	122.0
TOTAL		1,071	362	270	3.3	6	1,071

CONVERSION RATES
 ASPHALT: 112 LB/SQ YD IN
 AGGREGATE = 2.05 TON/CU YD
 0.004 TONS = GALLON

STORM SEWER SCHEDULE											
LOCATION		PRC FLAR END SEC 12 EA	CONCRETE COLLAR EACH	PRECAST CONCRETE BOX CULVERT 5 X 3 FOOT	INLETS, TY G-1 EA	INLET FILTERS EA	STORM SEWER, CL A, T 1 12" FOOT	END SECTIONS TO BE RELOCATED EA	REMOVE AND REINSTALL END SECTION EA	STORM SEWERS, PVC 12" (SPECIAL) FOOT	TRENCH BACKFILL CU YD
STA. 12+50	34' LT		1	8					1		
STA. 12+75	LT									6	
STA. 13+00	23' LT				1	1	11				1.1
STA. 13+00	34' LT										
STA. 13+50	23' LT				1	1	11				1.1
STA. 13+50	34' LT										
STA. 16+75	45' LT						22				0.8
STA. 16+85	23' LT				1	1					
STA. 16+87	28' LT						54				
STA. 17+40	-							1			
TOTAL		2	1	8	3	3	98	1	1	6	3.0

RIPRAP SCHEDULE		
LOCATION		STONE RIPRAP, CLASS B3 WITH FILTER FABRIC SQ YD
STA. 12+50.00	TO STA. 12+80.00	LT 20
TOTAL		20

STRIP REFLECTIVE CRACK CONTROL TREATMENT SCHEDULE		
LOCATION		STRIP REFLECTIVE CRACK CONTROL TREATMENT FOOT
STA. 8+94.00	TO STA. 20+60.00	LT 1,166
TOTAL		1,166

PERMANENT PAVEMENT MARKING SCHEDULE						
LOCATION		PAINT PAVEMENT MARKING - 4" WHITE FT	PAINT PAVEMENT MARKING - 4" YELLOW FT	PAINT PAVEMENT MARKING - 12" YELLOW FT	PAINT PAVEMENT MARKING - 8" WHITE FT	PAINT PAVEMENT MARKING - LETTERS AND SYMBOLS SQ FT
STA. 8+94.00	TO STA. 10+25.00	LT	262			
STA. 10+25.00	TO STA. 13+71.00	LT	1380.0	50.0		
STA. 13+71.00	TO STA. 15+96.00	LT	450.0		225.0	46.8
STA. 16+45.00	TO STA. 20+65.00	LT		1680.0	115.0	
STA. 8+94.00	TO STA. 20+60.00	RT	1166.0			
STA. 18+55.00	TO STA. 19+81.00	LT	126.0			
TOTAL			1292	3772	165	47

TEMPORARY PAVEMENT MARKING SCHEDULE			
LOCATION		SHORT TERM PAVEMENT MARKING FT	WORK ZONE PAVEMENT MARKING REMOVAL SQ FT
STA. 8+94.00	TO STA. 20+60.00	233.0	70.0
2 APPLICATIONS			
TOTAL		233	70

CURB AND GUTTER SCHEDULE				
LOCATION		COMBINATION CONCRETE CURB AND GUTTER, TYPE B-6.24 FOOT	COMBINATION CONCRETE CURB AND GUTTER, TYPE M-6.24 FOOT	
STA. 8+94.00	TO STA. 11+07.00	LT	216.00	
STA. 11+67.50	TO STA. 12+83.50	LT	126.00	
STA. 13+06.50	TO STA. 13+43.50	LT	37.00	
STA. 13+56.50	TO STA. 15+86.00	LT	229.50	
STA. 16+56.50	TO STA. 16+76.50	LT	22.00	
STA. 18+91.50	TO STA. 17+76.00	LT	84.50	
STA. 18+55.00	TO STA. 19+81.00	LT	126.00	
STA. 19+81.00	TO STA. 20+60.00	LT		80.00
TOTAL			841	80

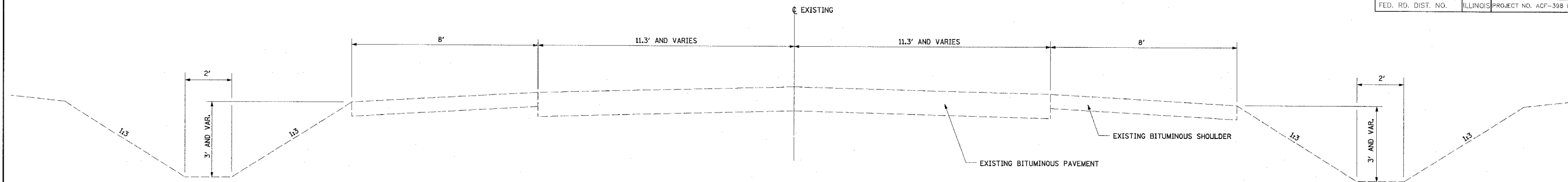

**EXISTING TYPICAL SECTION
STA. 8 + 93.5 TO STA. 20 + 60**

PAVEMENT DESIGN INFORMATION		
STRUCTURAL DESIGN TRAFFIC:	5400	YEAR: 2016
PV =	5346	SU = 27 MU = 27
ROAD/STREET CLASSIFICATION:	RURAL	CLASS: II
PERCENT OF STRUCTURAL DESIGN TRAFFIC IN DESIGN LANE:		
PV =	99%	SU = 0.5% MU = 0.5%
TRAFFIC FACTOR:	ACTUAL TF = 0.12	AC TYPE = 20
PG GRADE:	BINDER = 64-22	SURFACE = 70-22
SUBGRADE SUPPORTING RATING:		
	SSR = EST. \leq 3.0	

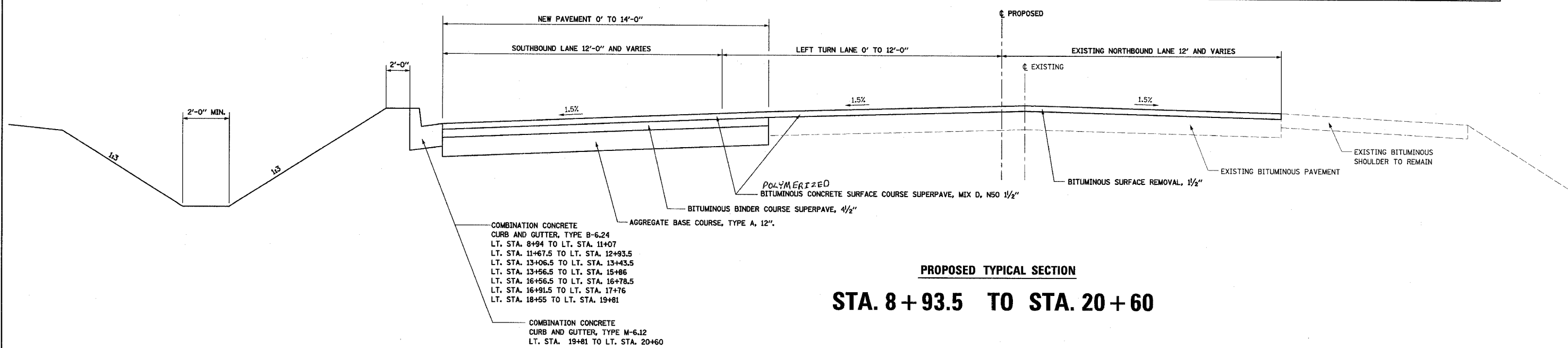

**PROPOSED TYPICAL SECTION
STA. 8 + 93.5 TO STA. 20 + 60**

COMBINATION CONCRETE CURB AND GUTTER, TYPE B-6.24
 LT. STA. 8+94 TO LT. STA. 11+07
 LT. STA. 11+67.5 TO LT. STA. 12+93.5
 LT. STA. 13+06.5 TO LT. STA. 13+43.5
 LT. STA. 13+56.5 TO LT. STA. 15+86
 LT. STA. 16+56.5 TO LT. STA. 16+78.5
 LT. STA. 16+91.5 TO LT. STA. 17+76
 LT. STA. 18+55 TO LT. STA. 19+81

COMBINATION CONCRETE CURB AND GUTTER, TYPE M-6.12
 LT. STA. 19+81 TO LT. STA. 20+60

BENCHMARKS				
BENCHMARK	DESCRIPTION	ELEVATION	STATION	OFFSET
TBM 11	IRON PIN	782.57	9+86.7	34.2' LT.
TBM 12	CHISELED "X" ON NORTH CAP BOLT OF FIRE HYDRANT	781.31	10+50	34' RT.
TBM 13	CHISELED "X" ON NORTH CAP BOLT OF FIRE HYDRANT	782.35	15+64	34' RT.
TBM 14	CHISELED "□" ON SOUTHEAST LIGHT POLE AT MIDDLE SCHOOL	782.85	12+21	139' LT.

STATUS OF UTILITIES					
STATION	OFFSET	OWNER	TYPE OF UTILITY	TYPE OF CONFLICT	DISPOSITION
9+00 TO 17+50	50' TO 55' LT.	VERIZON	TELEPHONE	EARTH EXCAVATION	CAUTION
15+60	LT. AND RT.	CITY OF WASHINGTON	WATER	EARTH EXCAVATION	CAUTION
15+70	LT. AND RT.	AMEREN CILCO	GAS	EARTH EXCAVATION	CAUTION
17+60	LT. AND RT.	McLEOD	CABLE	WIDENING	CAUTION
18+50	LT. AND RT.	CITY OF WASHINGTON	WATER	WIDENING	CAUTION

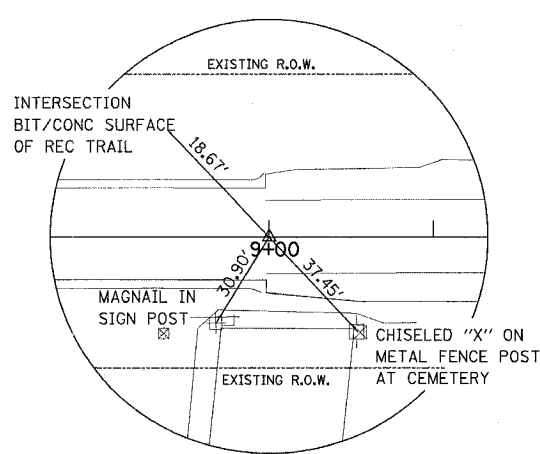
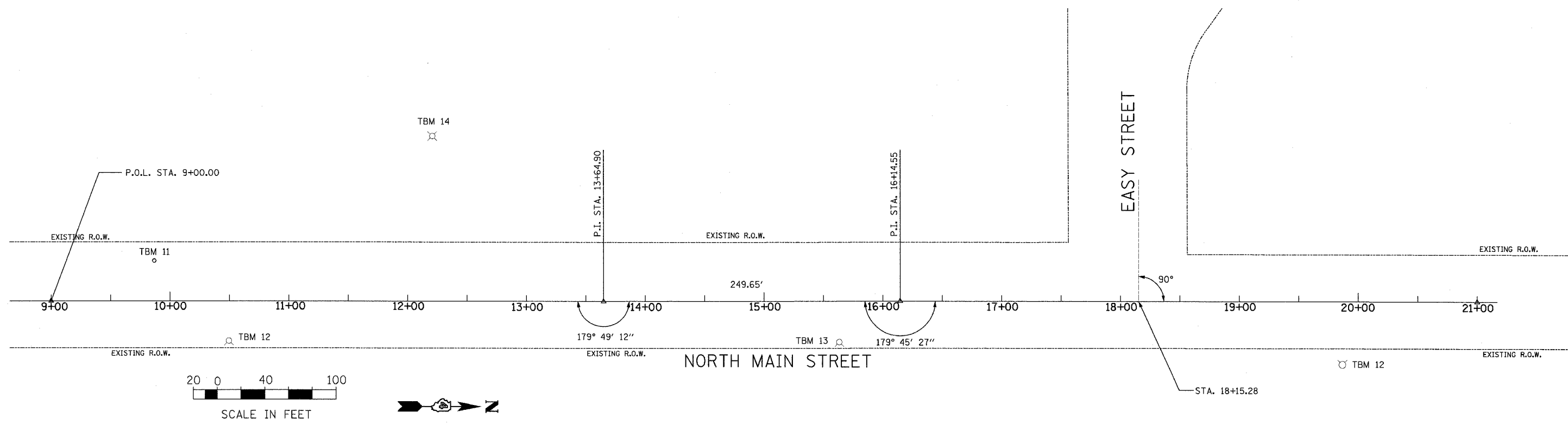

MAGNAIL
P.O.L. STA. 9+00.00
N. = 4140.04'
E. = 5817.23'

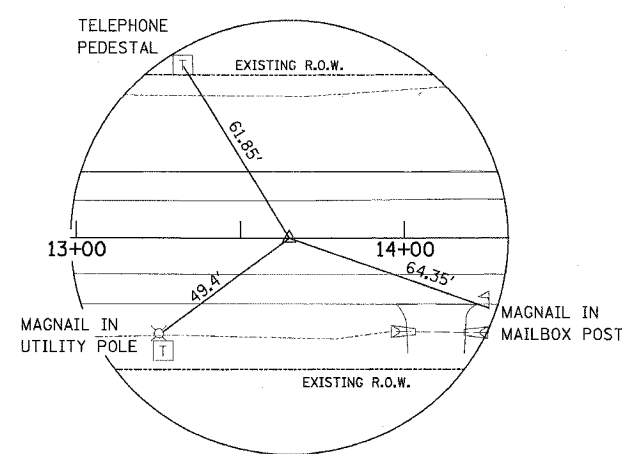

MAGNAIL
P.I. STA. 13+64.90
N. = 4604.93
E. = 5820.85

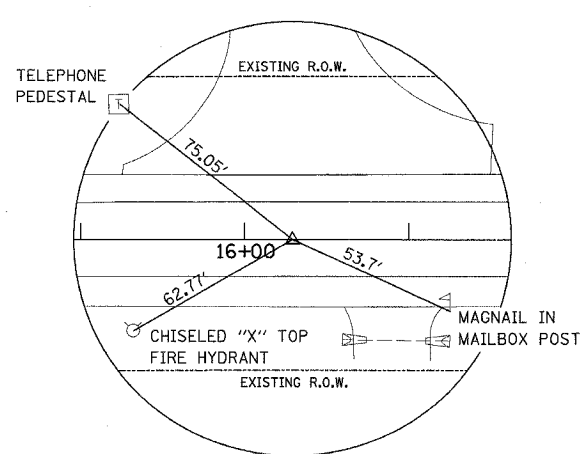

MAGNAIL
P.I. STA. 16+14.55
N. = 4854.57
E. = 5822.01

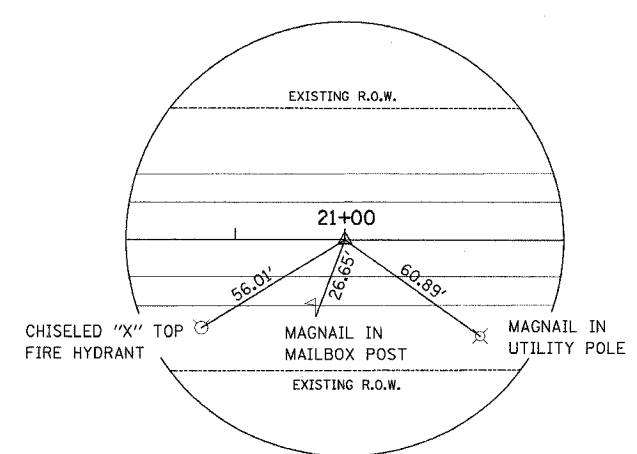

MAGNAIL
P.O.L. STA. 21+00.00
N. = 5340.00
E. = 5826.32

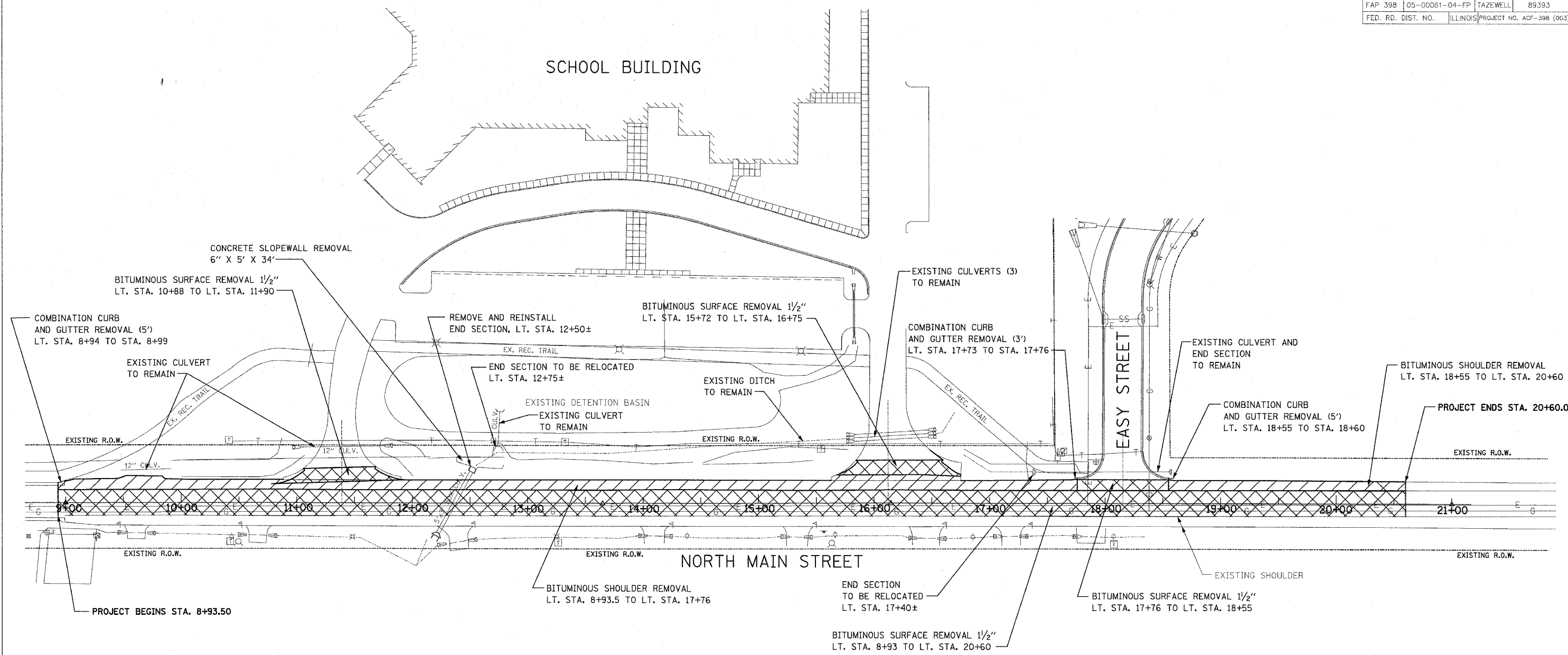

NOTE:
NO SANITARY SEWER WITHIN PROJECT LIMIT.

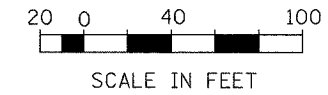

SHEET
OF
7
20

TEMPORARY EROSION CONTROL LEGEND

☒ INLET AND PIPE PROTECTION

F.A. RTE.	SECTION	COUNTY	CONTRACT NO.
FAP 398	05-00061-04-FP	TAZEWELL	89393
FED. RD. DIST. NO.	ILLINOIS PROJECT NO.	ACF-398 (003)	

NOTES:

- TRANSITION FROM 6" BARRIER CURB TO 4" MOUNTABLE CURB
LT. STA. 19+78 TO STA. 19+81
(INCLUDED IN 6" BARRIER CURB)
- TRANSITION FROM 6" BARRIER CURB TO 0" IN 3' AT END OF ENTRANCE/EXIT RADIUS TURNOUTS:
LT. STA. 11+07.0
LT. STA. 111+67.5
LT. STA. 15+86.0
LT. STA. 16+56.5

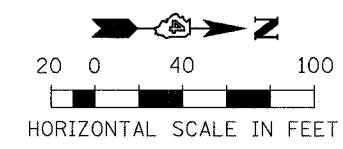
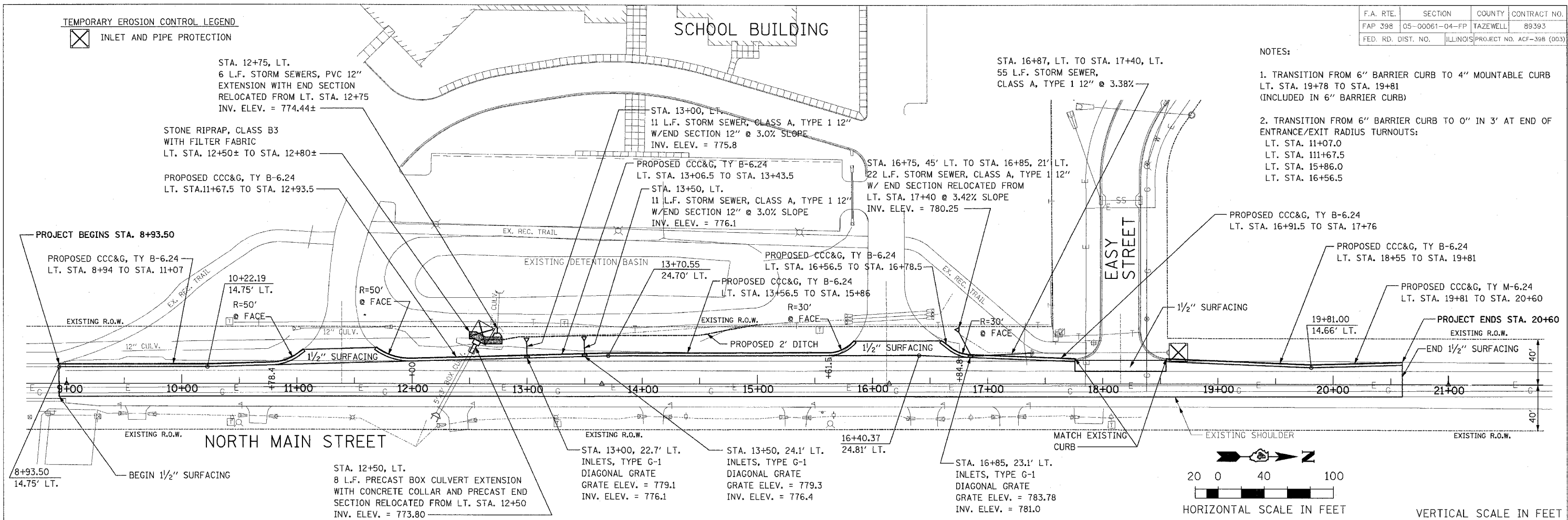

VERTICAL SCALE IN FEET

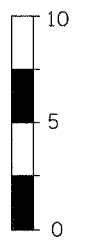
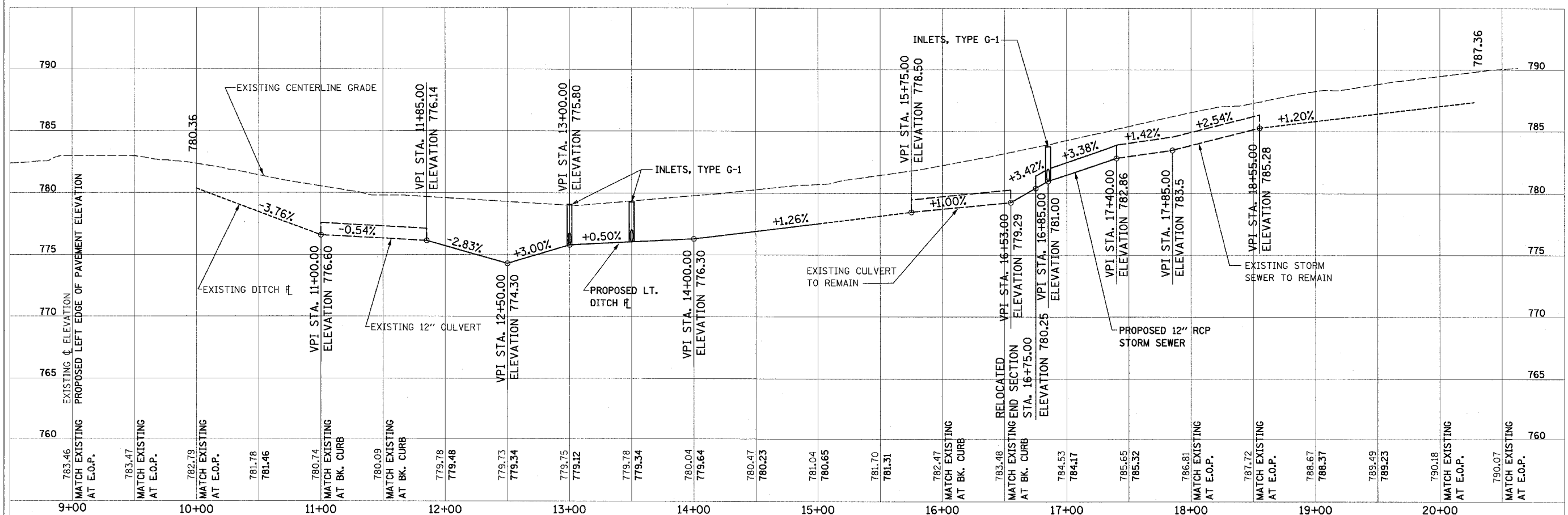

BTS CONSULTANTS
111 NE Jefferson Ave.
Peoria, Illinois 61602
PH: 309/678-8464
FAX: 309/678-8445
IL Design Firm Reg. No. 184-001518

NORTH MAIN STREET IMPROVEMENT

**ROADWAY AND DRAINAGE
PLAN AND PROFILE**

SURVEY	CHECKED	ISSUE DATE
DESIGN	APPROVED	PRELIM. DATE
DRAWN		PROJECT NO.

SHEET
8
OF
20

REVISED 03-10-06

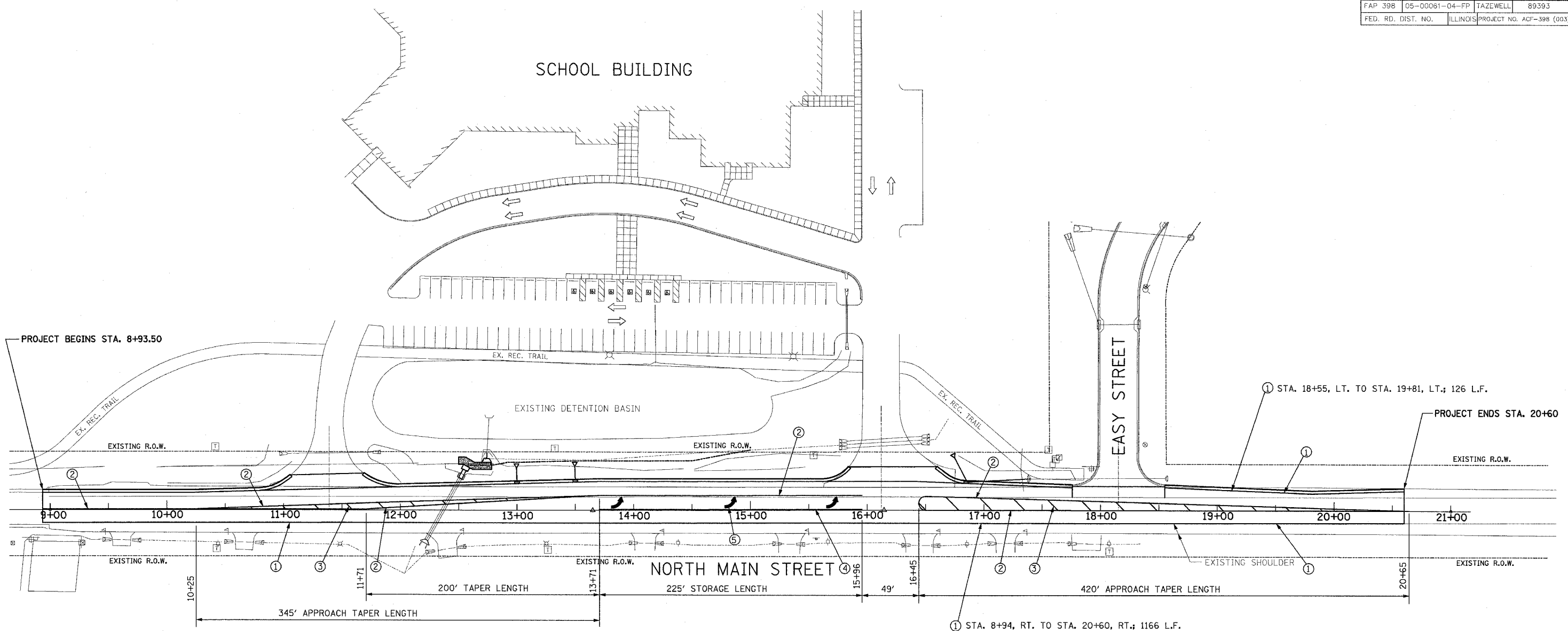

- ① 4" WHITE, PAINT
- ② 4" DOUBLE YELLOW, PAINT
- ③ 12" DIAGONAL YELLOW, PAINT @ 20' CENTERS
- ④ 8" WHITE, PAINT
- ⑤ LETTERS AND SYMBOLS, PAINT

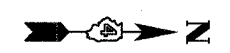
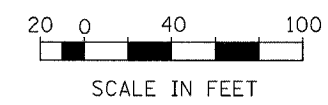

SHEET
9
OF
20

ST CONSULTANTS
111 NE Jefferson Ave.
Peoria, Illinois 61602
PH: (309) 675-8484
FAX: (309) 675-9445
IL Design Firm Reg. No. 184-001518

NORTH MAIN STREET IMPROVEMENT

PAVEMENT MARKING

SURVEY	CHECKED	ISSUE DATE
DESIGN	APPROVED	PRELIM. DATE
DRAWN	DLC	PROJECT NO.
		ILSD0003

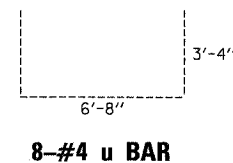
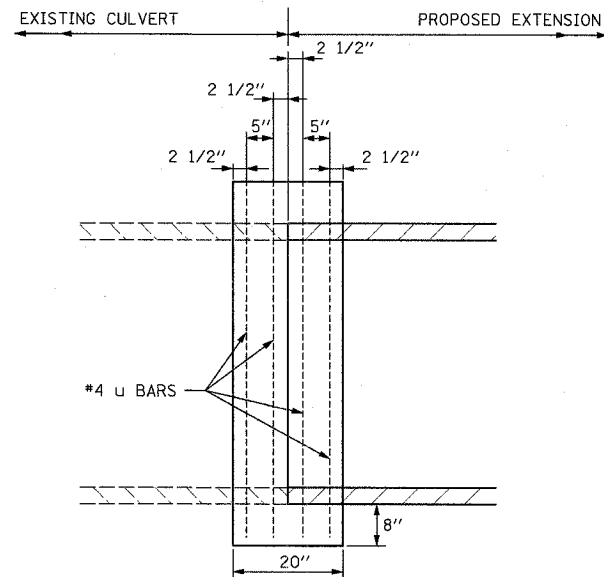

COLLAR FOR 5' X 3' BOX CULVERT
NOT TO SCALE

CLASS SI CONCRETE = 0.87 CU. YD.
REINFORCEMENT = 53.4 POUND

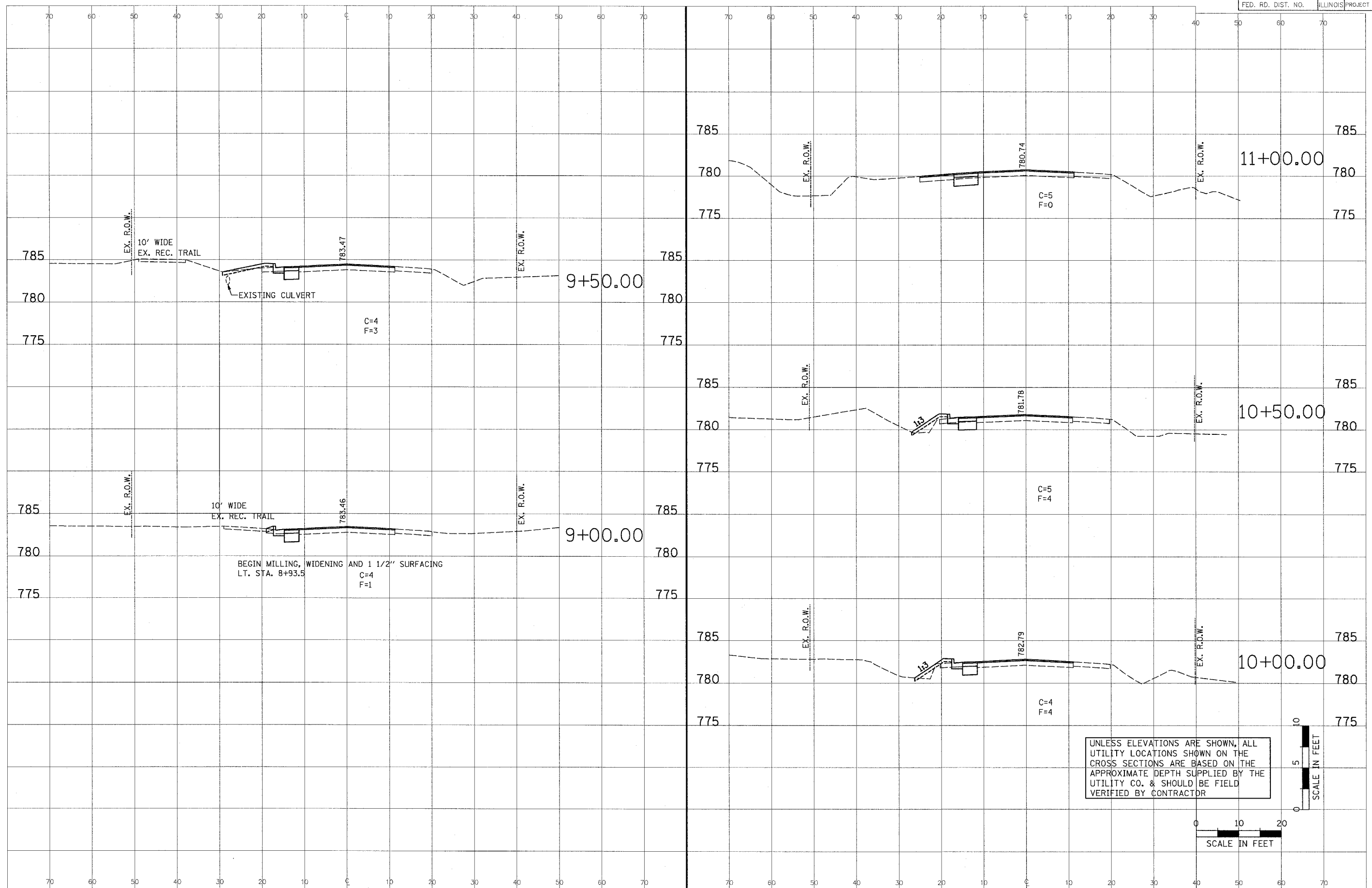

UNLESS ELEVATIONS ARE SHOWN, ALL UTILITY LOCATIONS SHOWN ON THE CROSS SECTIONS ARE BASED ON THE APPROXIMATE DEPTH SUPPLIED BY THE UTILITY CO. & SHOULD BE FIELD VERIFIED BY CONTRACTOR

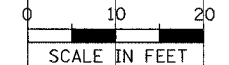
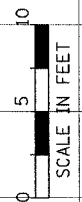

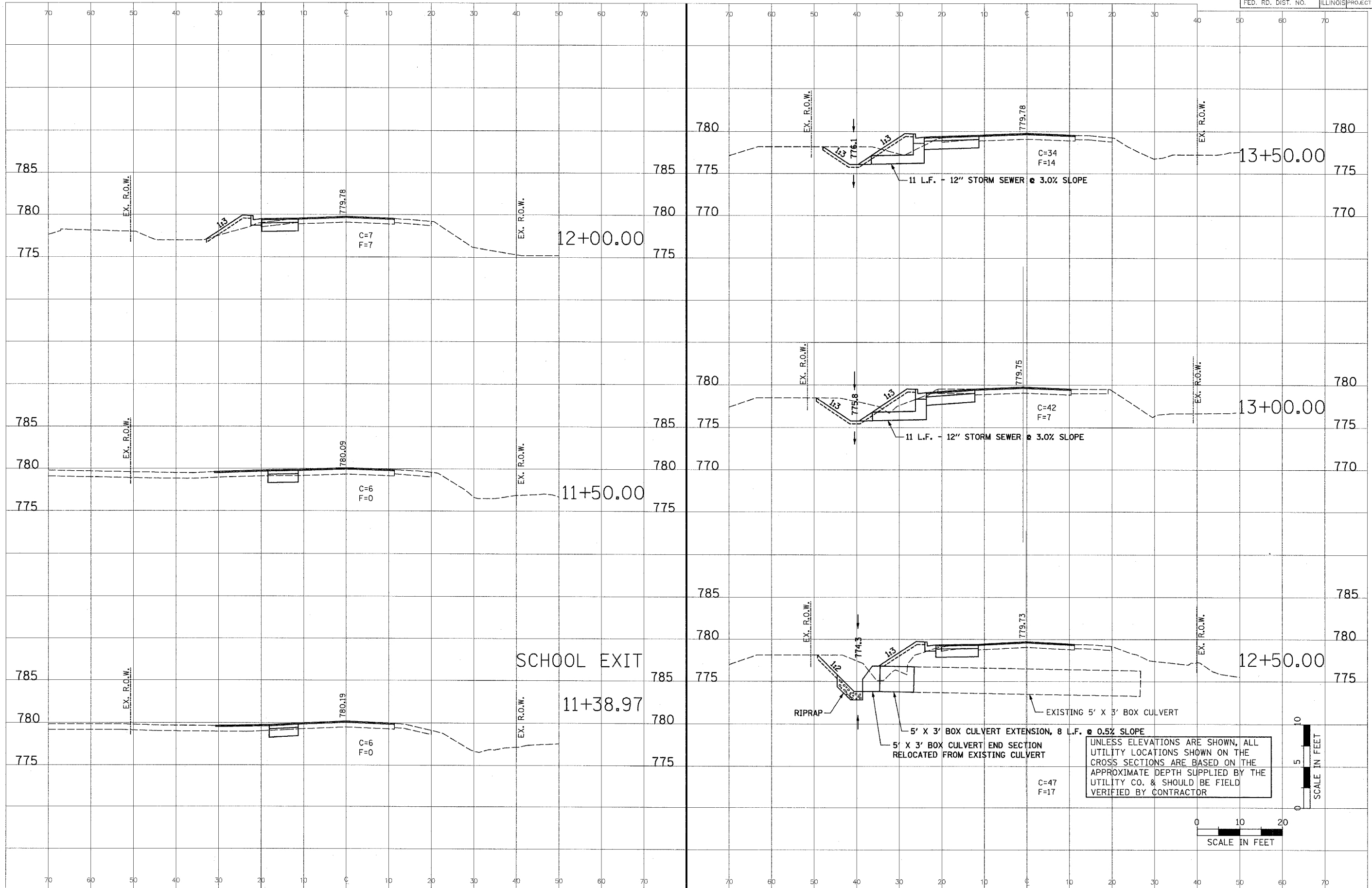

UNLESS ELEVATIONS ARE SHOWN, ALL UTILITY LOCATIONS SHOWN ON THE CROSS SECTIONS ARE BASED ON THE APPROXIMATE DEPTH SUPPLIED BY THE UTILITY CO. & SHOULD BE FIELD VERIFIED BY CONTRACTOR

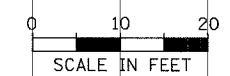

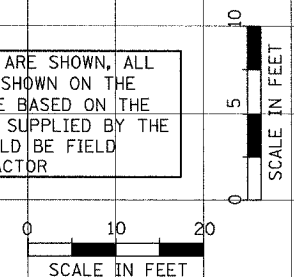
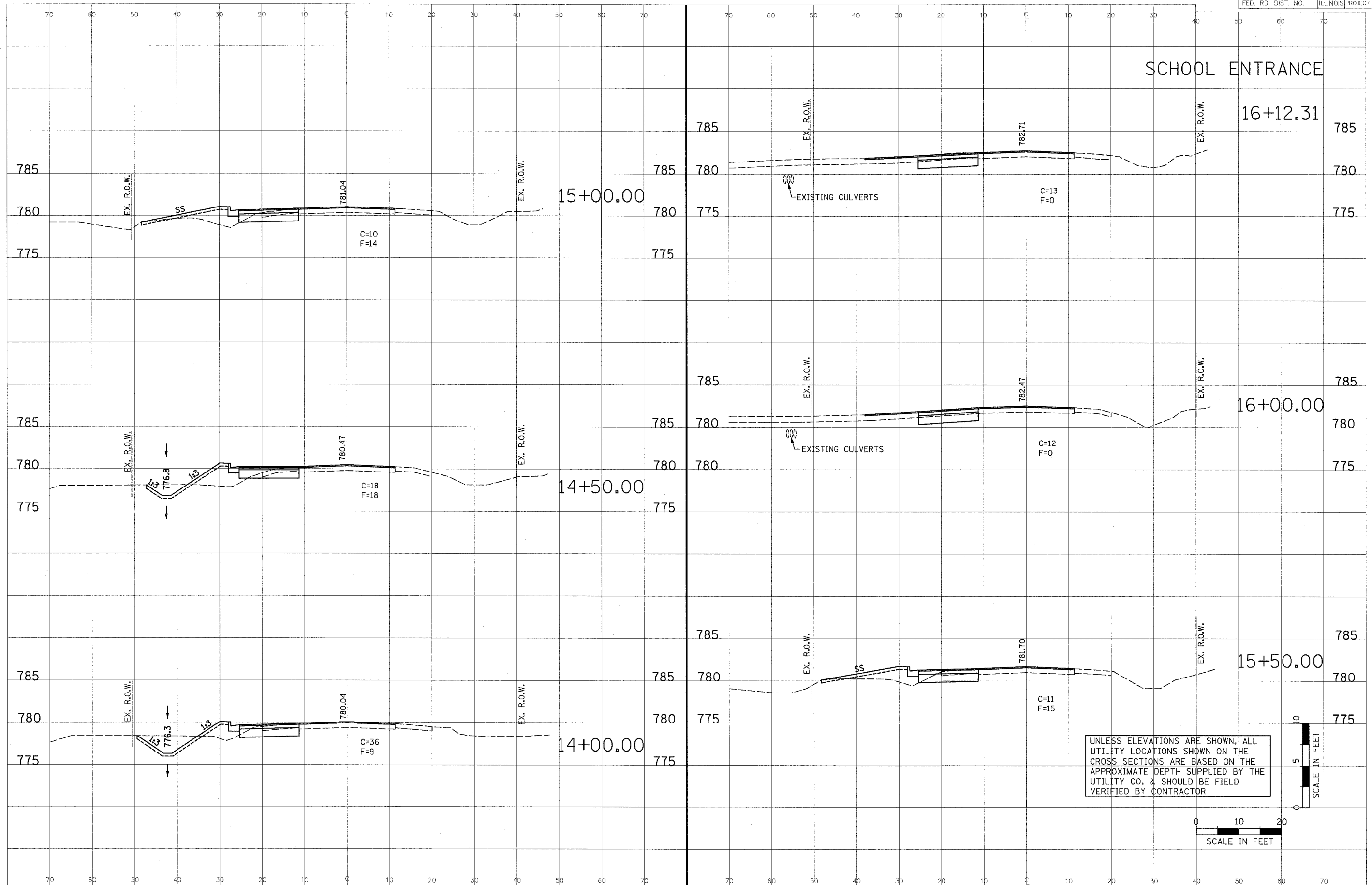

25 SHEETS OF 2/27/2006 10:12:29 AM

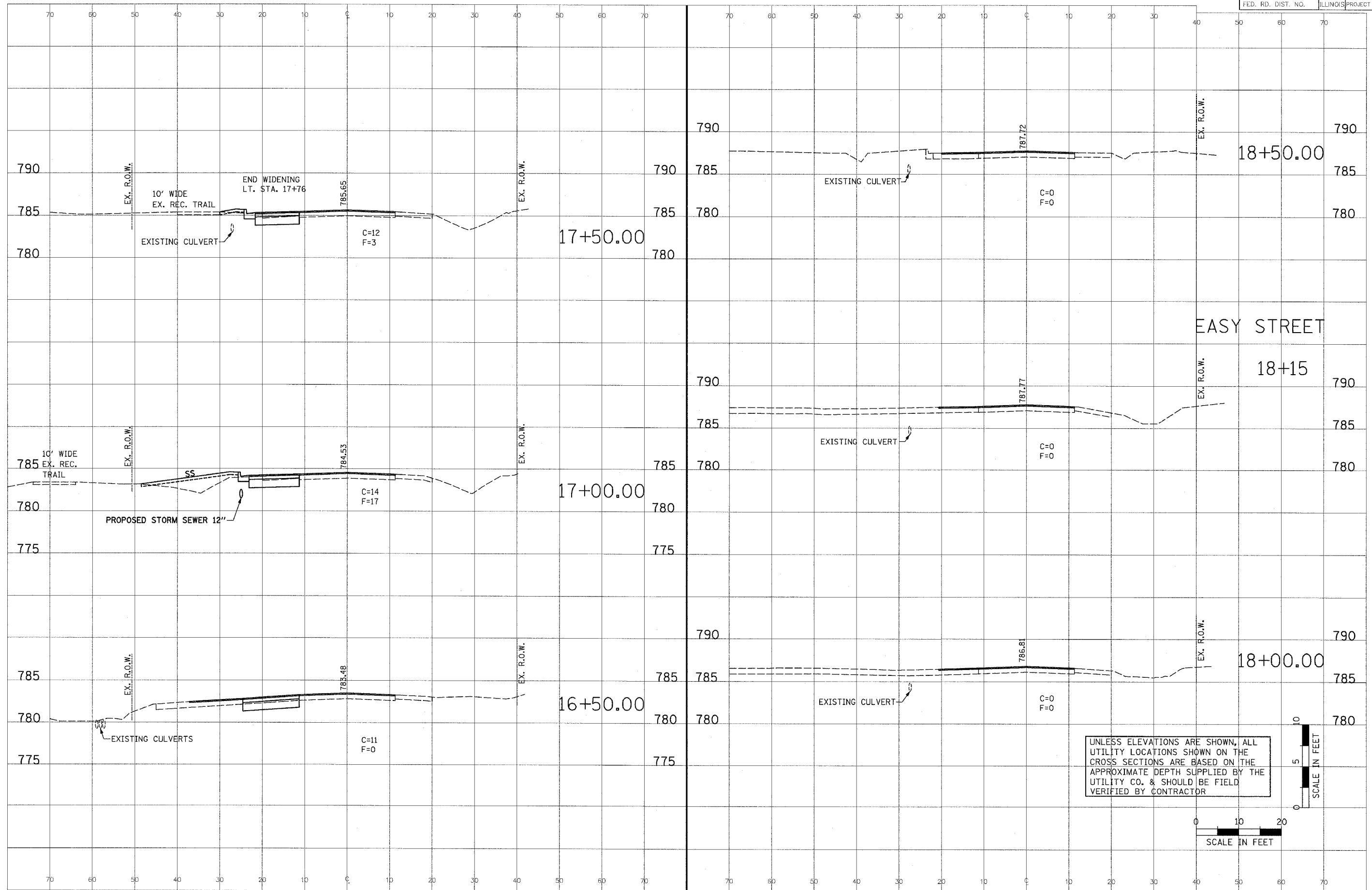

UNLESS ELEVATIONS ARE SHOWN, ALL UTILITY LOCATIONS SHOWN ON THE CROSS SECTIONS ARE BASED ON THE APPROXIMATE DEPTH SUPPLIED BY THE UTILITY CO. & SHOULD BE FIELD VERIFIED BY CONTRACTOR

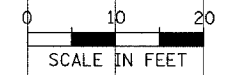
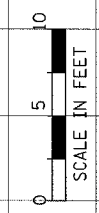

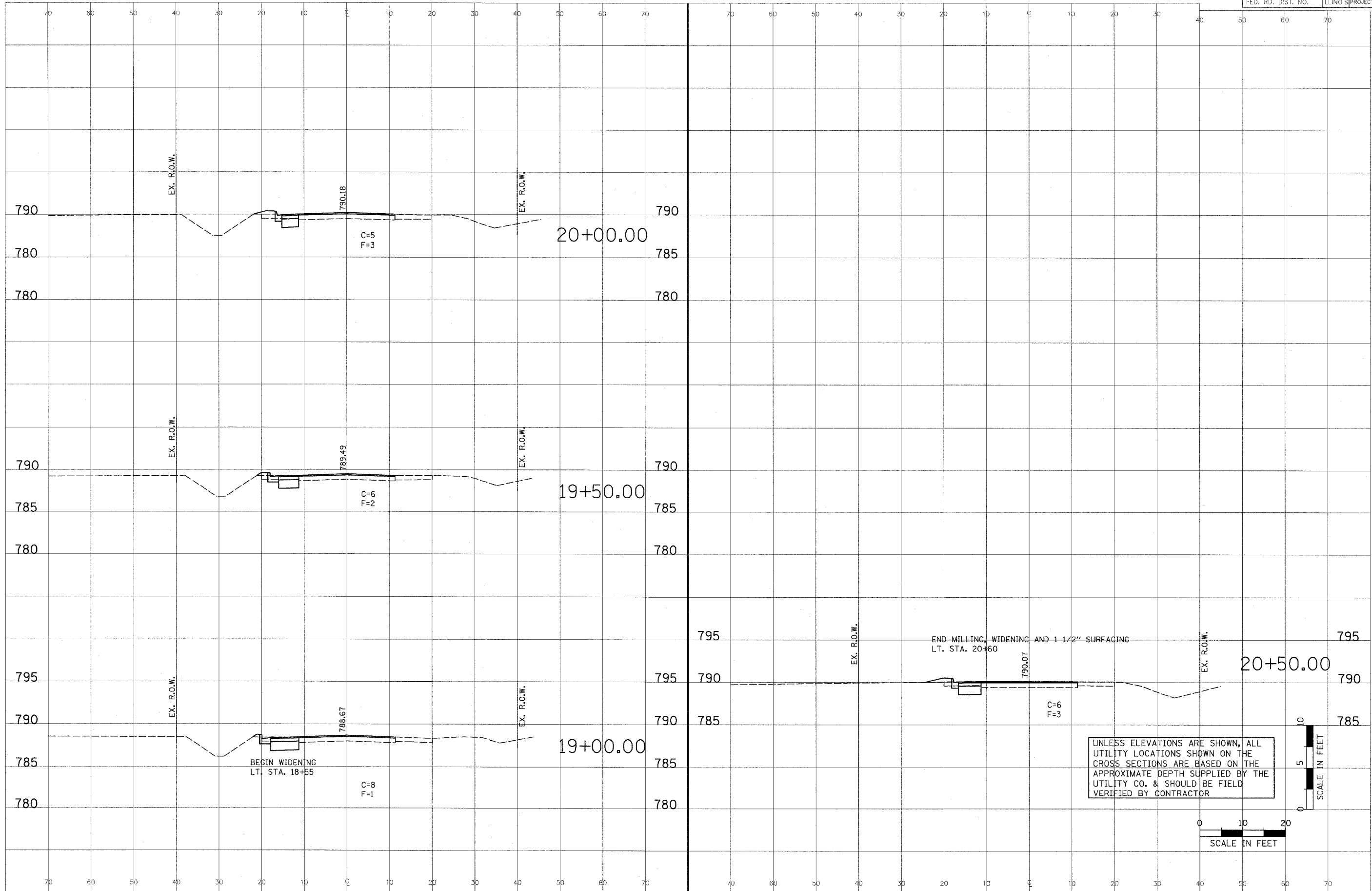

UNLESS ELEVATIONS ARE SHOWN, ALL UTILITY LOCATIONS SHOWN ON THE CROSS SECTIONS ARE BASED ON THE APPROXIMATE DEPTH SUPPLIED BY THE UTILITY CO. & SHOULD BE FIELD VERIFIED BY CONTRACTOR

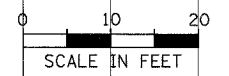
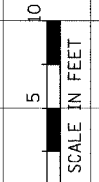

SHEET
OF
15
20



NORTH MAIN STREET IMPROVEMENT

**CROSS SECTIONS
STA. 19+00 TO STA. 20+50**

SURVEY	CHECKED	ISSUE DATE
DESIGN	APPROVED	PRELIM. DATE
DRAWN	DLC	PROJECT NO.
		ILSD0003

15 SHEETS (08) 2/22/2005 10:12:39 AM

89393

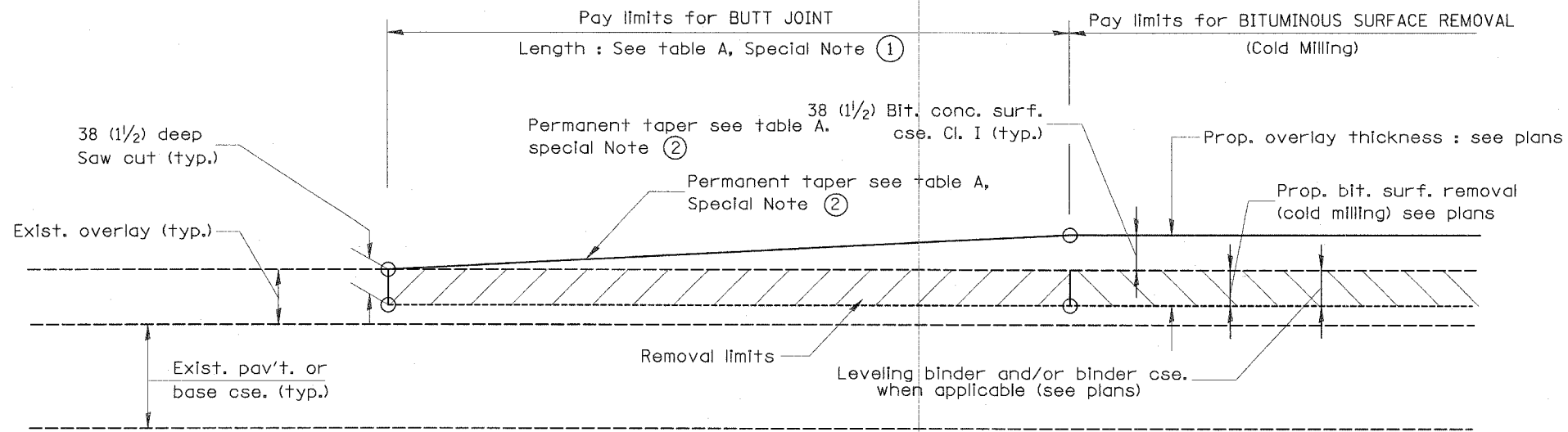

CASE 1 : WITH BITUMINOUS SURFACE REMOVAL (COLD MILLING)

TABLE A
(LENGTHS AND TAPER RATES)

SPECIAL NOTE NUMBER	ELEMENT	MAINLINE INTERSTATES & 4-LANE EXPRESSWAYS	ALL OTHERS
①	LENGTH OF BUTT JOINT	18.0 m(60')	9.0 m(30')
②	PERMANENT TAPER RATE	1:480	1:240
③	TEMPORARY RAMP TAPER RATE	1:80	1:40
④	TEMPORARY RAMP LENGTH	3.0 m(10')	1.5 m(5')

GENERAL NOTES

- The work shall be done in accordance with Article 406.18 and the Special Provision for Butt Joints.
- The pavement surface to be removed may be either bituminous or P.C. concrete. The work shall be performed in accordance with Article 440.03 and the Special Provisions for Butt Joints.
- The saw cut joints shall be primed just prior to the placing of bituminous material. The work will be in accordance with the applicable portions of Article 406.06.

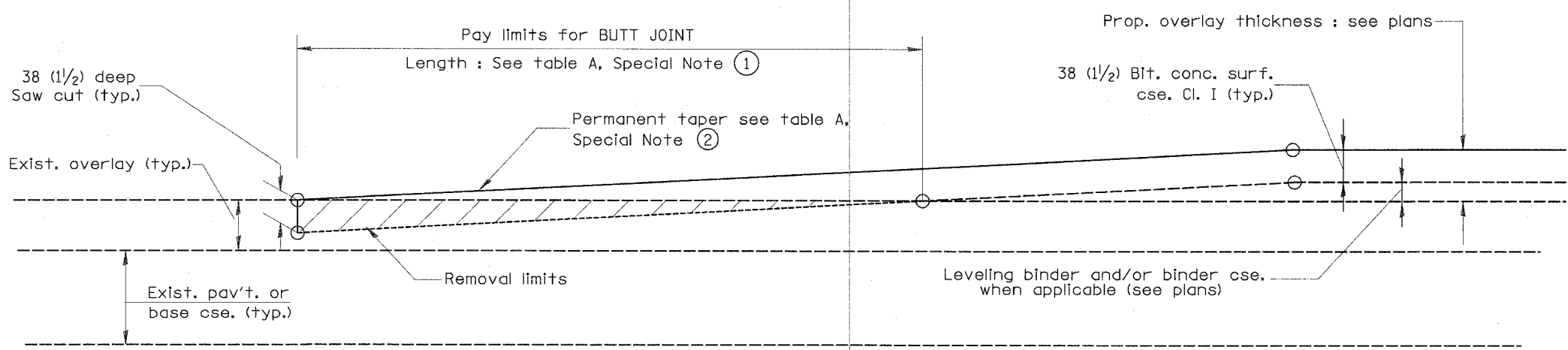

CASE 2 : NO BITUMINOUS SURFACE REMOVAL (COLD MILLING)

All dimensions are in millimeters (inches) unless otherwise noted.

ILLINOIS DEPARTMENT OF TRANSPORTATION
DISTRICT CADD STANDARD

DATE	REVISIONS	BY
1-1-97	RENUM. C-23,01, NEW REVISION BOX	T.P.
4-1-97	CORRECTION TO DEPTH	J.A.

BUTT JOINTS
CADD STD NO. 406101-D4 SHEET 1 OF 2
SCALE: NOT DRAWN TO SCALE DRAWN BY CADD
DATE **DATE** CHECKED BY

406101-D4 (1)

DESIGNER NOTES:
 1. Include District Special Provision for Butt Joints & for Bituminous Surface Removal (Cold Milling).
 2. The butt joints pay item includes the saw cut & temporary ramp. Payment for the Butt Joint applies whether or not the project features Bituminous Surface Removal (Cold Milling).

\$\$\$DATE\$\$\$

DGN-ONLY

F.A.U. RTE.	SECTION	COUNTY	TOTAL SHEETS	SHEET NO.
6734	05-00061-04-FP	TAZEWELL	20	17
STAL.		TO STA.		
FED. ROAD DIST. NO.		ILLINOIS	FED. AID PROJECT	

89393

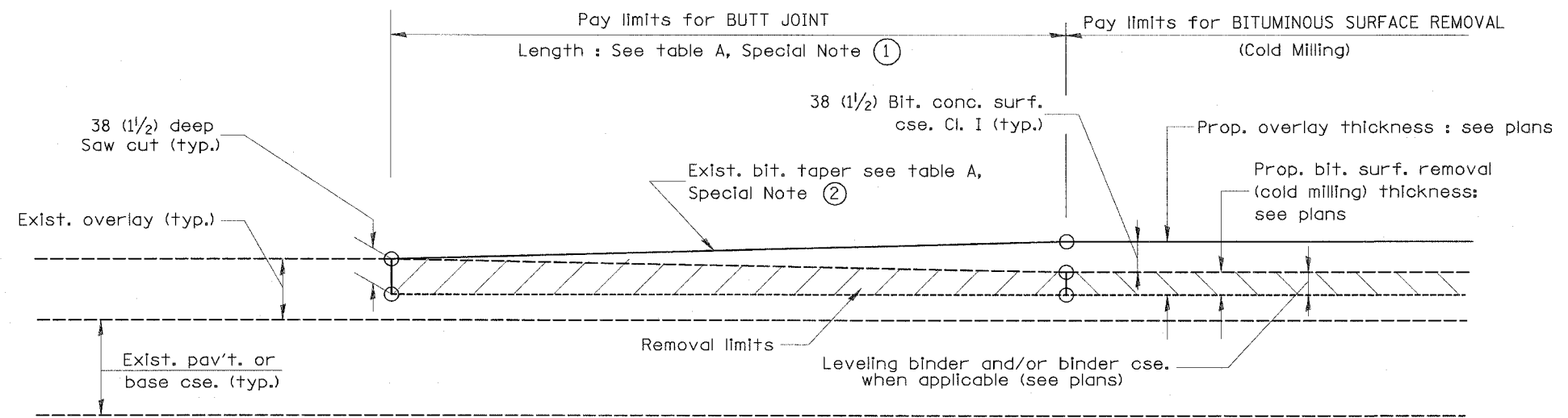

**CASE 3 : WITH BITUMINOUS SURFACE REMOVAL (COLD MILLING)
TIE-IN TO EXISTING BITUMINOUS TAPER**

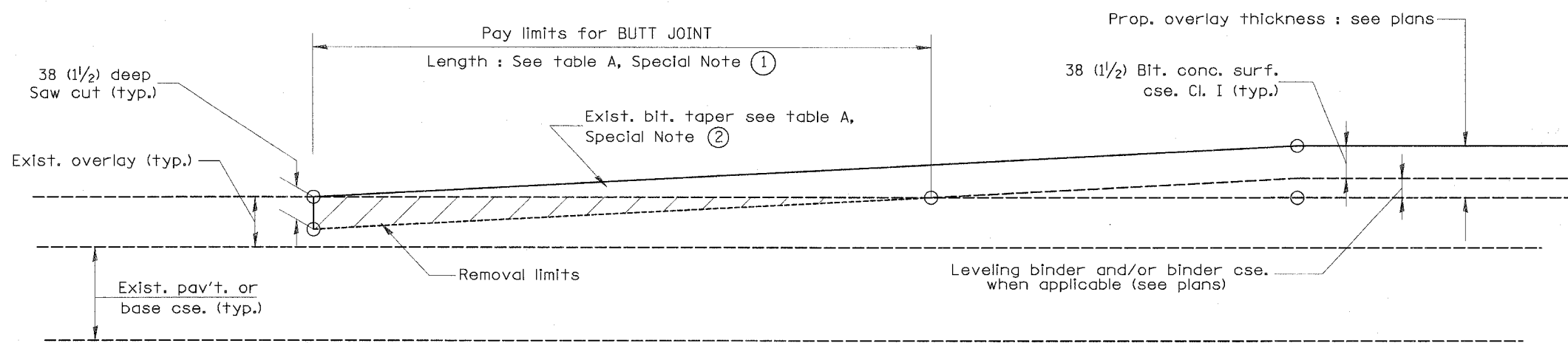

**CASE 4 : NO BITUMINOUS SURFACE REMOVAL (COLD MILLING)
TIE-IN TO EXISTING BITUMINOUS TAPER**

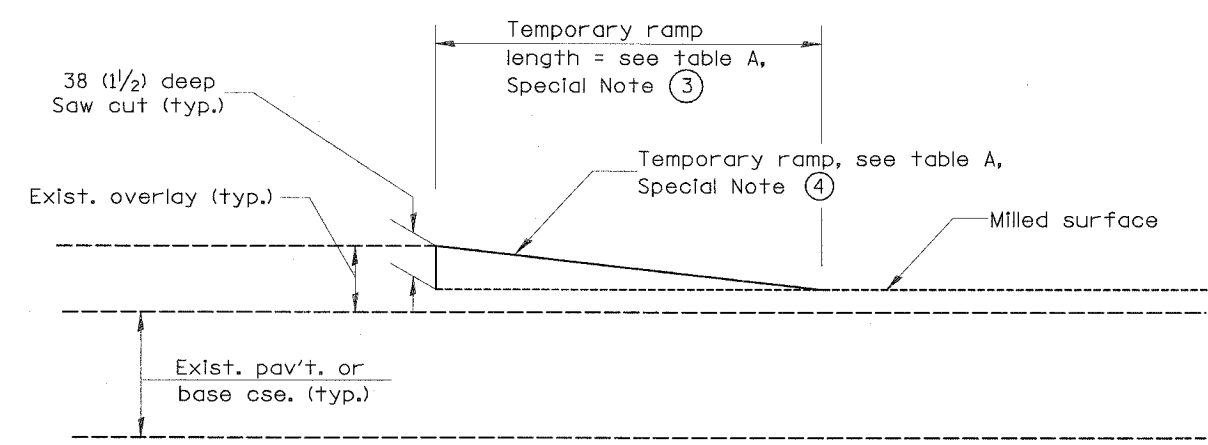

DETAIL TEMPORARY RAMP

All dimensions are in millimeters (Inches) unless otherwise noted.

ILLINOIS DEPARTMENT OF TRANSPORTATION	
DISTRICT CADD STANDARD	
BUTT JOINTS	
CADD STD NO. 406101-D4	SHEET 2 OF 2
SCALE: NOT DRAWN TO SCALE	DRAWN BY CADD
DATE **DATE**	CHECKED BY

406101-D4 (2)

\$\$\$DATE\$\$\$

DGN-ONLY

STD D4 01-01P 1/22/2008 8:24:42 AM

F.A.U. RTE.	SECTION	COUNTY	TOTAL SHEETS	SHEET NO.
6734	05-00061-04-FP	TAZEWELL	20	18
STA.	TO STA.			
FED. ROAD DIST. NO.	ILLINOIS	FED. AID PROJECT		

89393

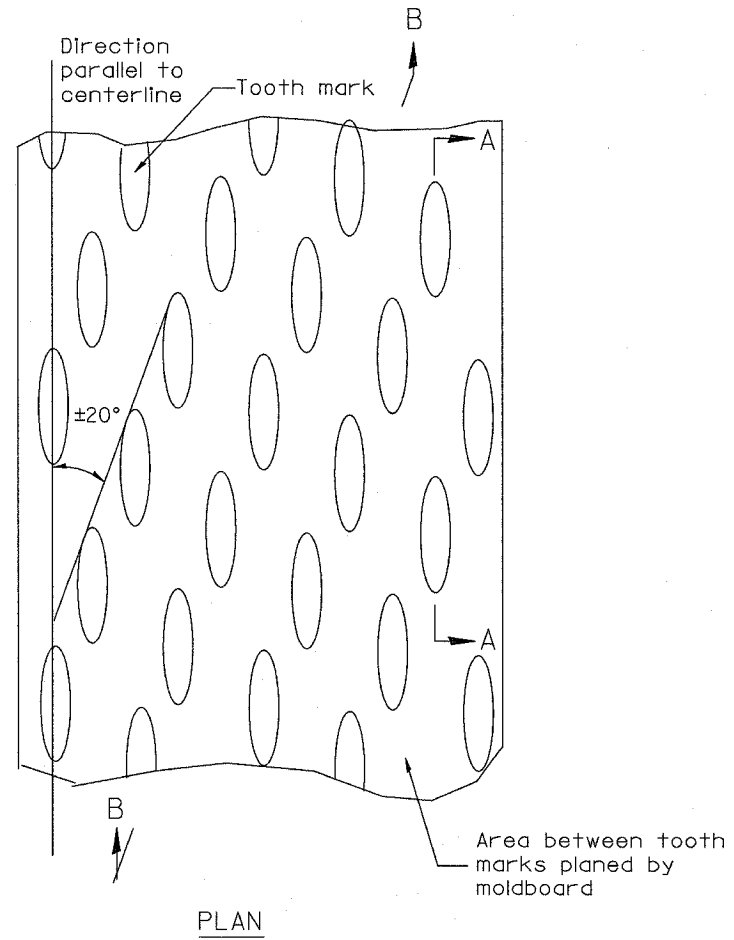

General notes:

1. Coldmilling shall consist of two processes: Cutting with carbide teeth mounted on a rotating drum, and planing with a moldboard mounted immediately behind the cutting drum.
2. Other similar patterns will be acceptable if they consist of a smooth, flat, planed surface interspersed with a pattern of discontinuous longitudinal striations.

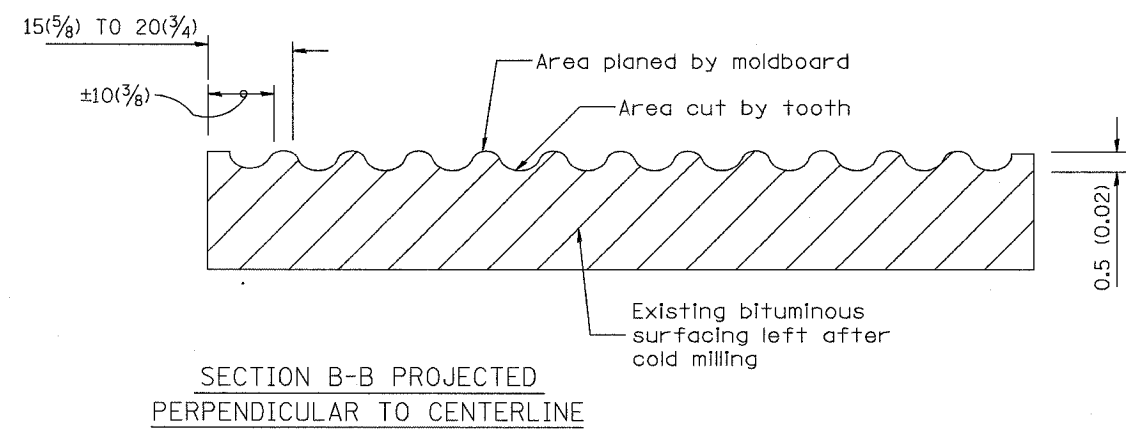
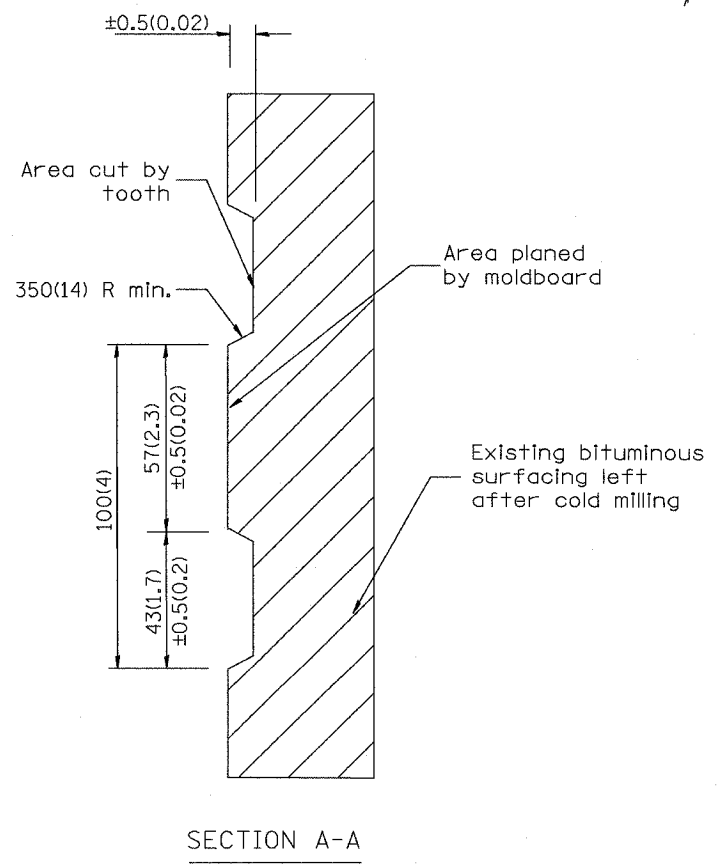

DESIGNER NOTE
1. INCLUDE DISTRICT SPECIAL PROVISION, IF APPLICABLE.

DATE

All dimensions are in millimeters (inches) unless otherwise noted.

ILLINOIS DEPARTMENT OF TRANSPORTATION
DISTRICT CADD STANDARD

DATE	REVISIONS	BY
1-1-97	RENUM. C-104.01, NEW REVISION BOX	T. P.
4-20-98	REMOVED MILLING DETAIL FROM STD.	J. A.
9-08-98	CORRECT NOTE LEADER PLACEMENT	R. W.

BITUMINOUS SURFACE REMOVAL (COLD MILLING)

CADD STD NO. 440001-D4
SCALE: NOT DRAWN TO SCALE
DRAWN BY CADD
DATE **DATE**
CHECKED BY

440001-D4

DGN-ONLY

STD 04 01 06P 2/27/2006 9:24:53 AM

F.A.U. RTE.	SECTION	COUNTY	TOTAL SHEETS	SHEET NO.
6734	05-00061-04-FP	TAZEWELL	20	18A
STA.	TO STA.			
FED. ROAD DIST. NO.	ILLINOIS	FED. AID PROJECT		

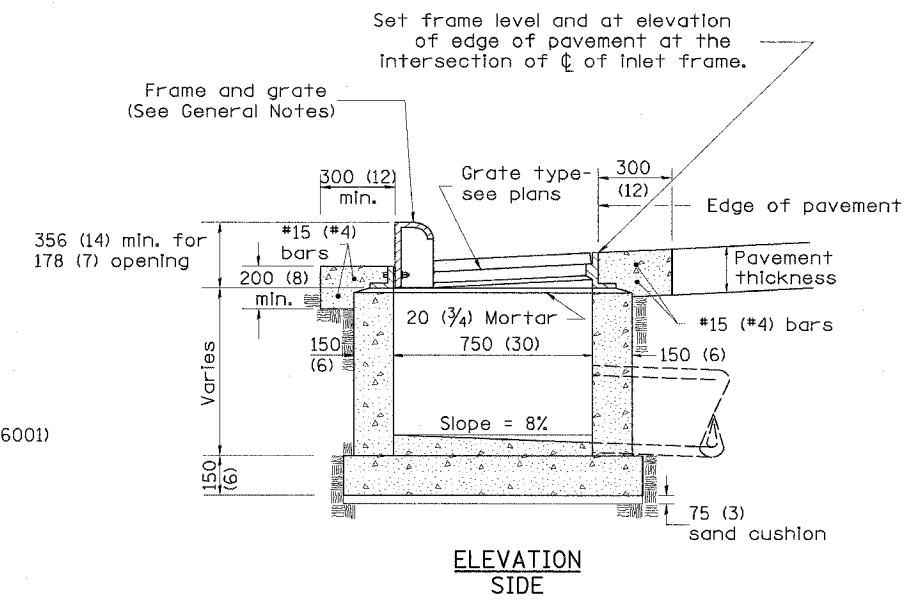
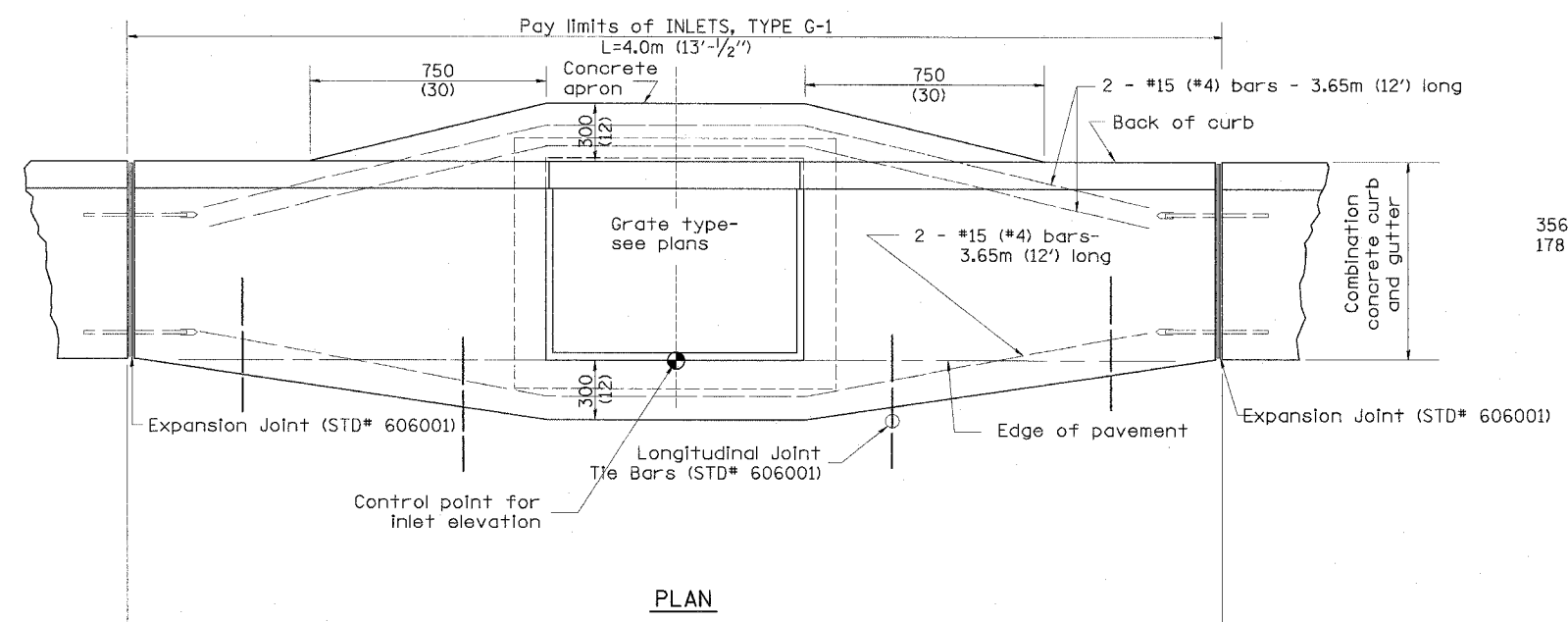

GENERAL NOTES

1. Inlet construction shall be in accordance with Section 602 of the Standard Specifications.
2. Combination Concrete Curb & Gutter shall be constructed in accordance with Section 606 of the Standard Specifications.
3. See District CADD Standard 604001-D4 for frame and grates.

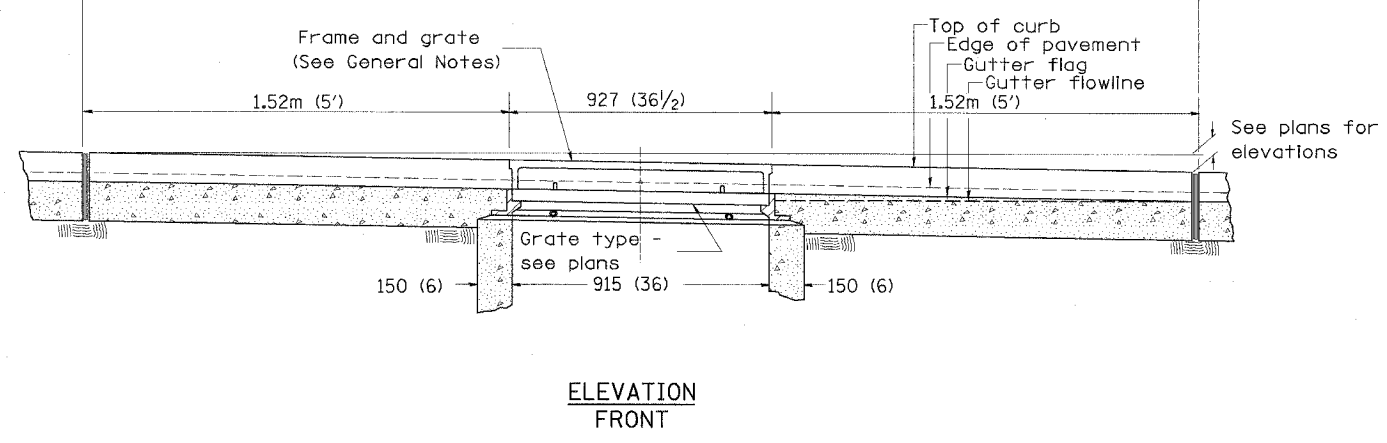

DESIGNER NOTES:
 1. Include State Standard 606001 for combination concrete curb and gutter details.
 2. Include State Standard 420001 for pavement joints.
 3. Include District CADD Standard for frame and grates and specify grate type in plans.
 4. Include District Special Provision. Pay item includes transitional c.c. & g., inlet and frame and grate. All work within pay limits.
 5. The designer should include pavement removal quantities when the apron requires pavement removal.

\$\$\$DATE\$\$\$

All dimensions are in millimeters (inches) unless otherwise noted.

ILLINOIS DEPARTMENT OF TRANSPORTATION
DISTRICT CADD STANDARD

INLETS, TYPE G-1

CADD STD NO. 602001-D4

SCALE NOT TO SCALE
DATE \$\$\$DATE\$\$\$
DRAWN BY CADD
CHECKED BY

DATE	REVISIONS	BY
1-1-97	RENUM. B-4.01, NEW REVISION BOX	T.P.
10-99	REVISION TO GENERAL NOTES	J.A.
2-00	REVISION TO DESIGNER NOTES	J.A.

DGN-ONLY

602001-D4

3/10/04 02:05:55 3/10/2008 10:35:11 AM

F.A.U. NO.	SECTION	COUNTY	TOTAL SHEETS	SHEET NO.
6734	05-00061-04-FP	TAZEWELL	20	188
STA.	TO STA.			
FED. ROAD DIST. NO.	ILLINOIS	FED. AID PROJECT		

DESIGNER NOTES:
 1. Include this standard with all Type G-1 and Type G-1, Special Drainage Structures.
 2. Specify grate types and flow directions in plans.
 3. These castings are included in the cost of the drainage structures as per District Special Provision.
 4. This drawing based upon "NEENAH" designs as follows: Inlet Frame: R-3246-A, Curb Box: R-3290, Reversible Diagonal Grate: R-3246-A, Vane Grates: R-3246-AL (flow left), R-3246-AL (flow right)

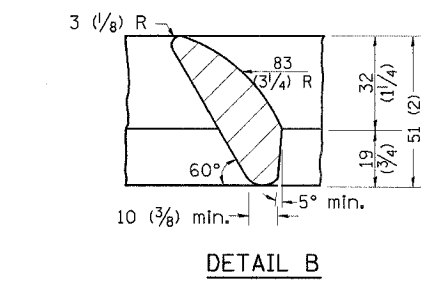
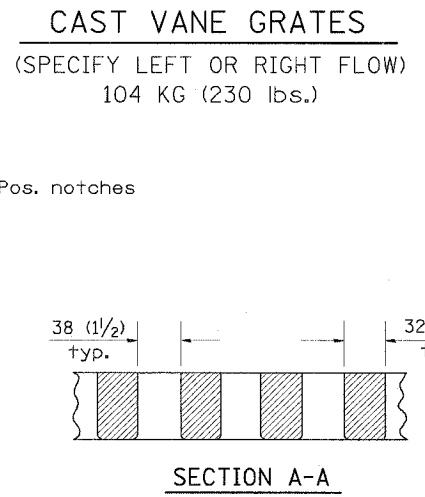
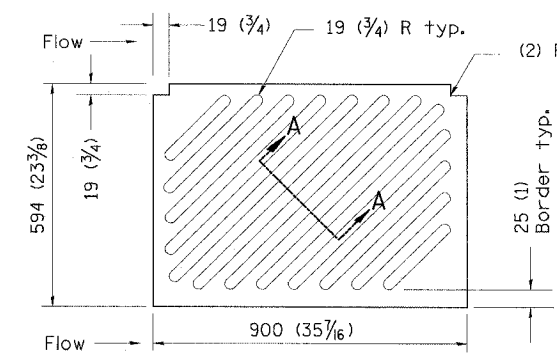
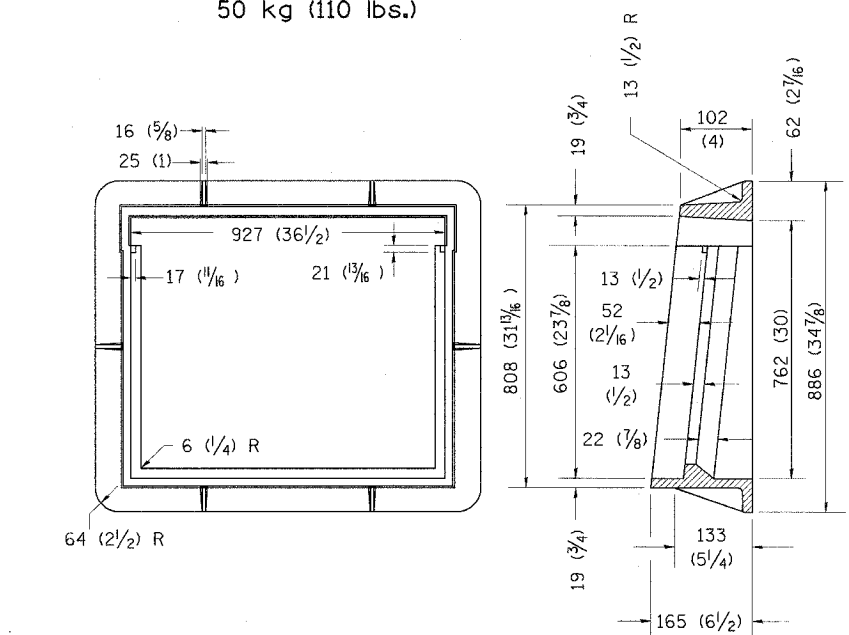
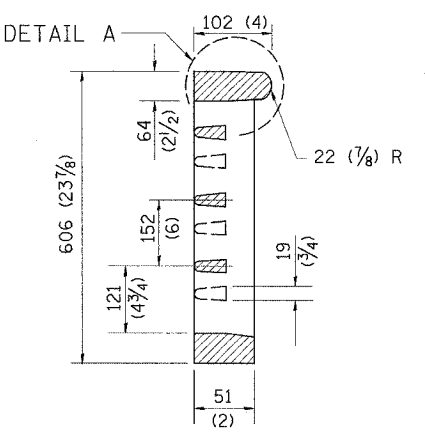
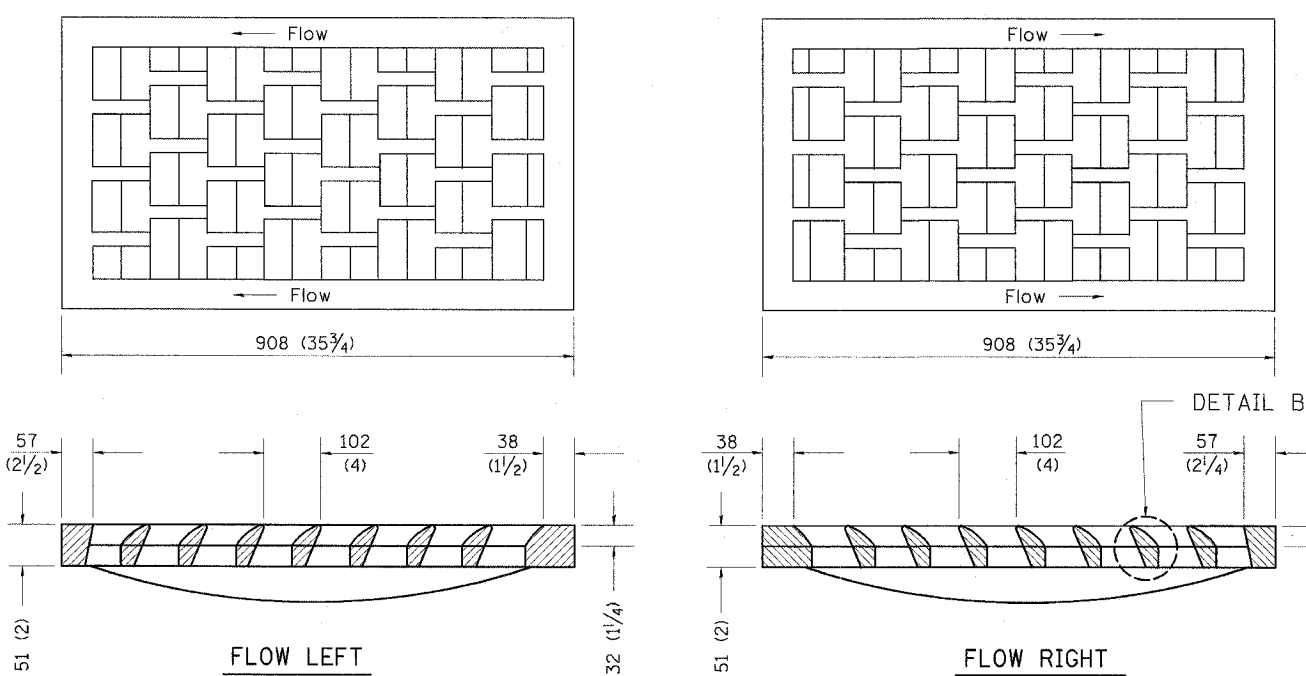
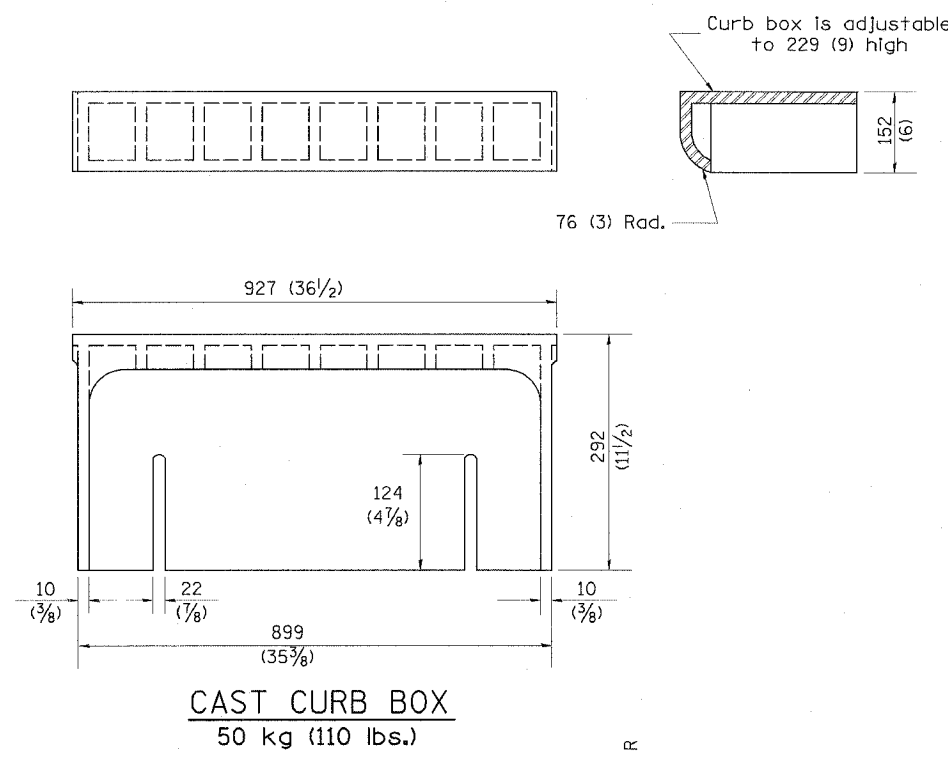

NOTE: Flow right shown

5 (3/8) R typ.

2° Draft angle

GENERAL NOTES

- The frame and grate shown on this drawing are for use with all TYPE G-1 and TYPE G-1, SPECIAL DRAINAGE STRUCTURES. See plans for grate type and flow direction.
- Flow direction: As viewed from street side.
- Material: cast gray iron.

DATE	REVISIONS	BY
1-1-97	RENUM. B-10.01, NEW REVISION BOX	T.P.

All dimensions are in millimeters (inches) unless otherwise noted.

ILLINOIS DEPARTMENT OF TRANSPORTATION
 DISTRICT CADD STANDARD
 FRAME AND GRATES FOR
 TYPE G-1 AND TYPE G-1, SPECIAL
 DRAINAGE STRUCTURES
 CADD STANDARD 604001-D4
 SCALE NOT TO SCALE
 DATE **DATE**
 DRAWN BY CADD
 CHECKED BY

F.A.U. RTE.	SECTION	COUNTY	TOTAL SHEETS	SHEET NO.
6734	05-00061-04-FP	TAZEWELL	20	19
STA.	TO STA.			
FED. ROAD DIST. NO.	ILLINOIS	FED. AID PROJECT		

89393

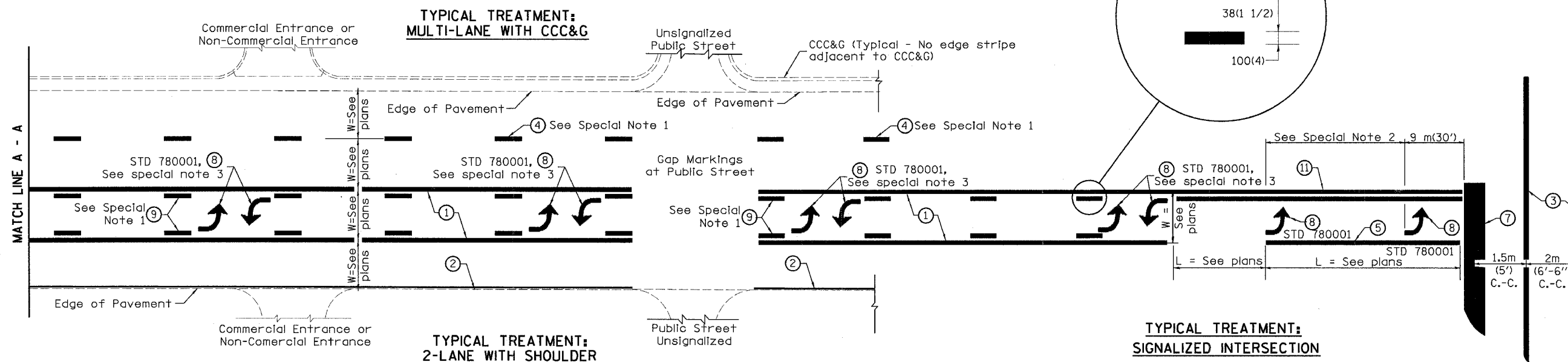

FLUSH PAVED MEDIAN: TWO-WAY LEFT TURN LANE WITH ONE-WAY LEFT TURN LANE AT SIGNALIZED INTERSECTION

TYPICAL PAVEMENT MARKING LEGEND

(Note: This is a District Standard Legend. Some elements may not apply to specific project.)

- ① 100(4) Solid (Yellow)
- ② 100(4) Solid (White)
- ③ 2-150(6) Crosswalk @ 2m (6'-6") min C.-C. (White)
2-200(8) Crosswalk @ 2m (6'-6") min C.-C. (White) (When traffic signals are present.)
- ④ 150(6) Skip-Dash (White) (See Special Note 1)
- ⑤ 200(8) Solid (White)
- ⑥ 300(12) Diagonal (White) (Item 6 is shown on Std. 780001)
- ⑦ 600(24) Stop Bar (White)
- ⑧ Letters & Arrows (See Std. 780001 and Special Notes 2 & 3)
- ⑨ 100(4) Skip-Dash (Yellow) (See Special Note 1)
- ⑩ 300(12) Diagonal (Yellow) (See Table A) (See Table A)
- ⑪ 100(4) Double Solid (Yellow) (See Table A)

SPECIAL NOTES

1. Skip-Dash markings will be centered between both ends of city blocks and shall be placed in alignment transversely across the pavement.
2. The following shall apply to arrows located in one-way left turn lanes:
 - A. A minimum of two (2) arrows is required.
 - B. The maximum spacing between arrows is 24 m (80').
 - C. Arrows shall be evenly spaced if three (3) or more are required.
3. The following shall apply to arrow pairs located in two-way left turn lanes:
 - A. A minimum of two (2) arrow pairs is required.
 - B. The maximum spacing between arrow pairs is 61 m (200').
 - C. Arrow pairs shall be evenly spaced if three (3) or more are required.
 - D. The spacing between BI Directional Left Turn Arrows is 10 m (33').

GENERAL NOTES

1. Refer to State Standard 780001 for additional Pavement Markings including letters & arrows.
2. See Plans for Pavement Markings adjacent to curbed islands and medians, and through lane reductions.

All dimensions are in millimeters (inches) unless otherwise noted.

ILLINOIS DEPARTMENT OF TRANSPORTATION
DISTRICT CADD STANDARD

TYPICAL PAVEMENT MARKINGS

DATE	REVISIONS	BY
1-1-97	RENUM. F-8.03, NEW REVISION BOX	T.P.
2-7-97	ADD BI DIRECTIONAL DIMENSION	J.A.
10-97	CORRECT BI DIRECTIONAL DIMENSION	J.A.
8-02	ADD CROSSWALK DMNS. WITH T.S.	M.A.

CADD STANDARD 780001-D4
SCALE: NOT DRAWN TO SCALE

SHEET 1 OF 2
DRAWN BY CADD
CHECKED BY

780001-D4 (1)

DESIGNER NOTES:
1. Include State Standard 780001 (Typical Pavement Markings)

\$\$\$DATE\$\$\$

DGN-ONLY

F.A.U. RTE.	SECTION	COUNTY	TOTAL SHEETS	SHEET NO.
6734	05-00061-04-FP	TAZEWELL	20	20
STA.	TO STA.			
FED. ROAD DIST. NO.	ILLINOIS	FED. AID PROJECT		

89393

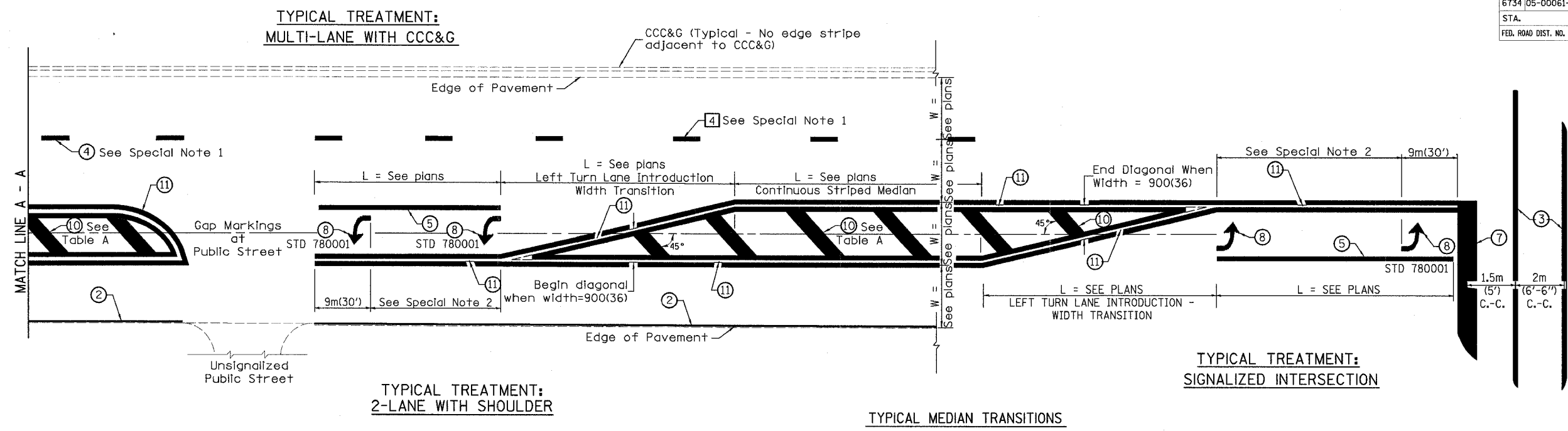

FLUSH PAVED MEDIAN: RESTRICTED LEFT TURN LANE

TABLE A
RECOMMENDED SPACING BETWEEN DIAGONAL LINES

SPEED LIMIT RANGE	CONTINUOUS	INTERSECTION CHANNELIZATION (Includes Width Transitions for Median and Left Turn Lane Introductions)
Less Than 50 km/h (30 mph)	15m (50')	5m (15')
50 - 70 km/h (30 - 45 mph)	23m (75')	6m (20')
Over 70 km/h (45 mph)	46m (150')	9m (30')

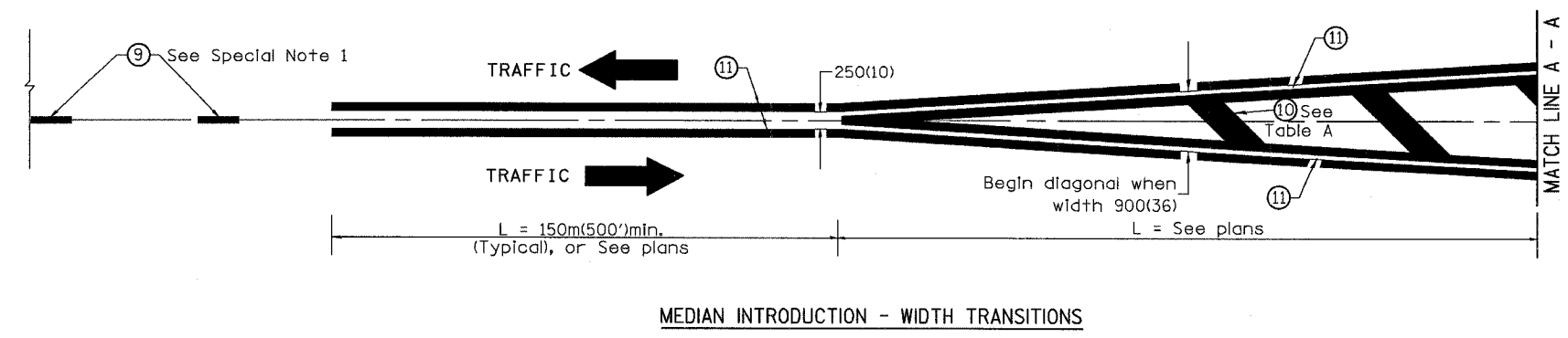

All dimensions are in millimeters (Inches) unless otherwise noted.

ILLINOIS DEPARTMENT OF TRANSPORTATION
DISTRICT CADD STANDARD

TYPICAL PAVEMENT MARKINGS

CADD STANDARD 780001-D4 SHEET 2 OF 2
SCALE: NOT DRAWN TO SCALE DRAWN BY CADD CHECKED BY

780001-D4 (2)

DATE

DGN-ONLY