

SOUTHWEST QUADRANT SIDEWALK DETAIL

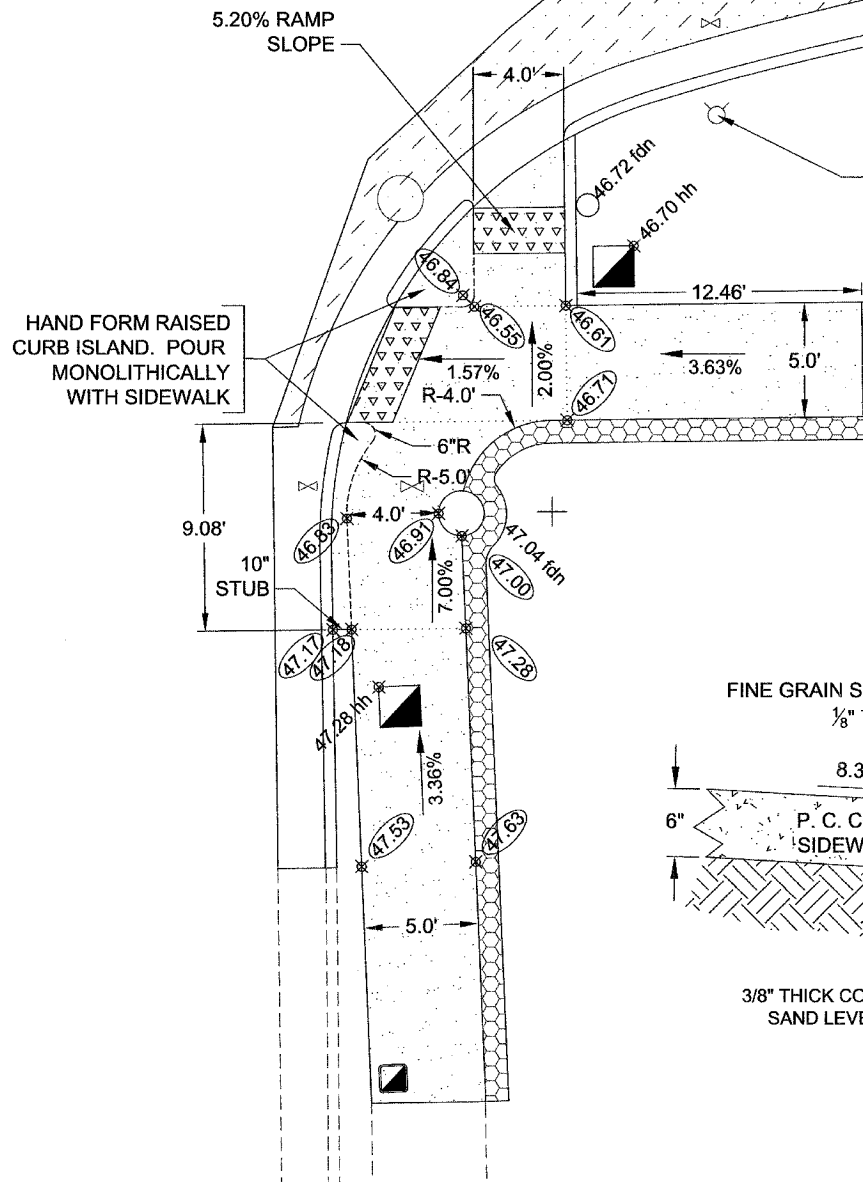

SOUTHEAST QUADRANT SIDEWALK DETAIL

BM A = 749.22 AT SE CORNER
NORTH RIM BOLT
ADD 700 TO ELEVATIONS

- INDICATES RAMP BREAK
- ⊗ XX.XX PROPOSED SPOT ELEVATION
- ▤ PROPOSED DETECTABLE WARNING SURFACE

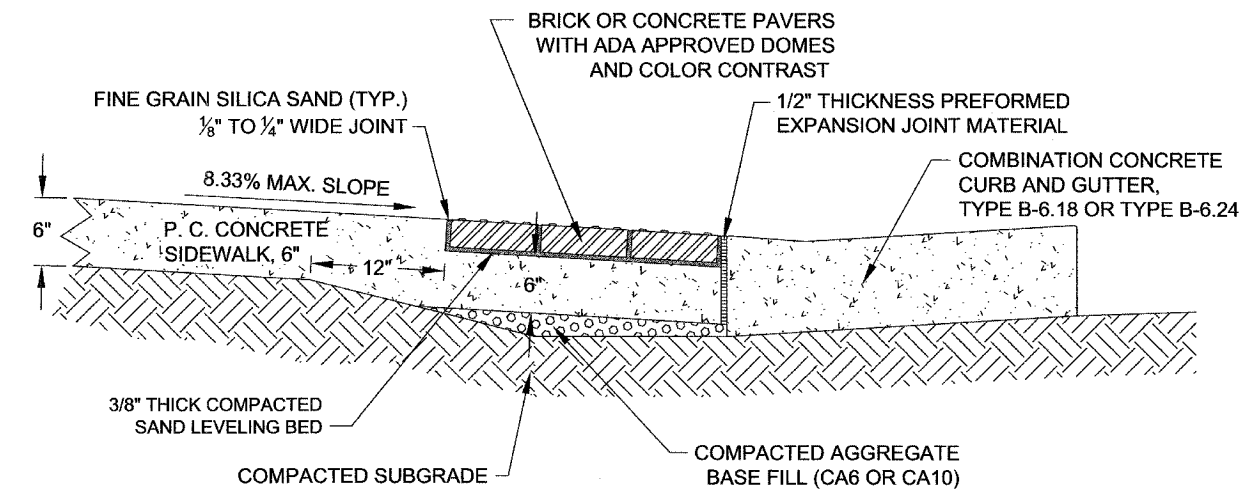

TYPICAL SECTION

GENERAL NOTES

SIDEWALK RAMPS SHALL BE CONSTRUCTED IN ACCORDANCE WITH ARTICLE 424 OF THE STANDARD SPECIFICATIONS.

SIDEWALK RAMPS AND CROSSWALKS WHICH ABUT STREETS SHALL BE PROVIDED WITH A 2 FOOT DETECTABLE WARNING SURFACE IN ACCORDANCE WITH THIS DETAIL AND HIGHWAY STANDARD 424001-03. IN CASE OF CONFLICT WITH THE STANDARD THIS DETAIL SHALL GOVERN THE INSTALLATION OF SIDEWALK RAMPS.

THE AREA OF DETECTABLE WARNING SURFACE PAVERS SHALL BE MEASURED SEPARATELY AND PAID FOR AT THE CONTRACT UNIT PRICE PER SQUARE FOOT FOR DETECTABLE WARNINGS.

DETAIL OF DETECTABLE WARNING SURFACE AND DEPRESSED BARRIER CURB AT SIDEWALK RAMPS

