



CITY OF URBANA
PUBLIC WORKS
ENGINEERING DIVISION

DRAWN BY: AJS
CHECKED BY: GLJ
DESIGNED BY: CES
CITY SECTION
95-00305-01 - PV

Philo Road Improvements
Stage Construction and
Maintenance of Traffic Plan

SHEET NO.
19
OF
62

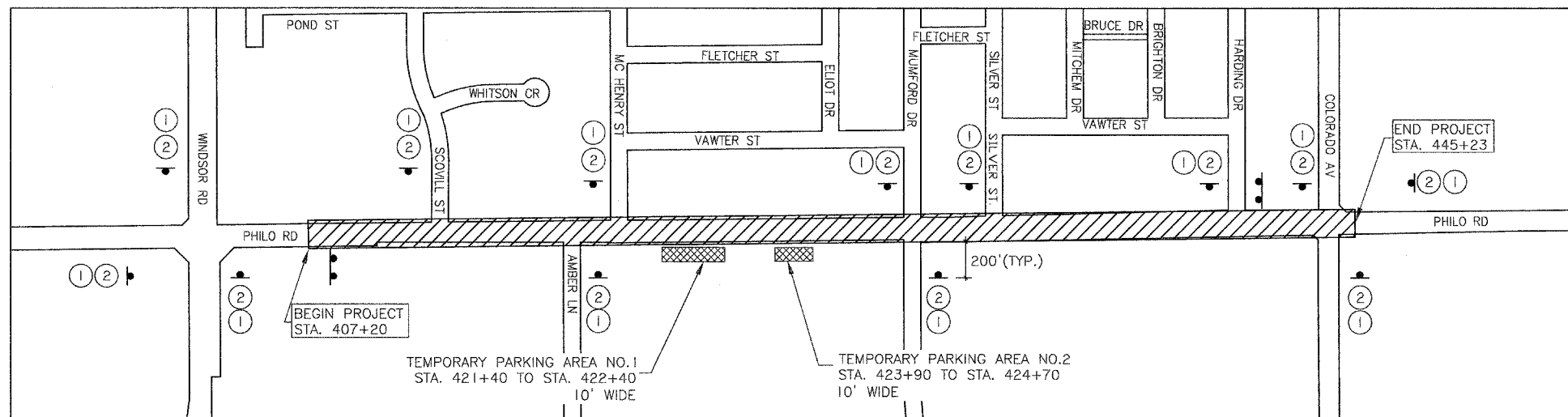

PROJECT OVERVIEW MAP
NOT TO SCALE

LEGEND

- WORK ZONE
 - TEMPORARY PARKING
 - SIGN ON PERMANENT SUPPORT
 - CHANGEABLE MESSAGE SIGN
- MESSAGE TO READ
"PHILO ROAD
CONSTRUCTION
BEGINS JUNE 12"

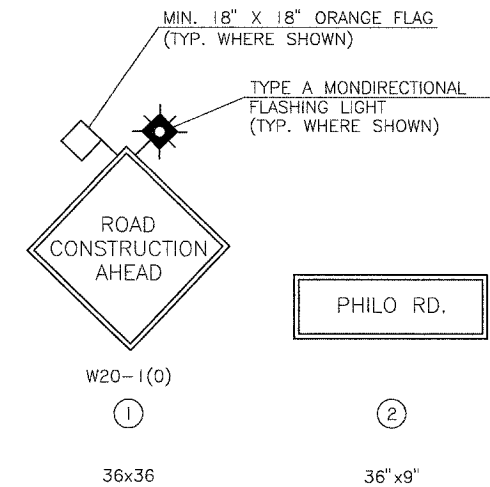

TRAFFIC CONTROL GENERAL NOTES

1. TRAFFIC CONTROL AND PROTECTION AS DETAILED HEREIN WILL BE PAID FOR AT THE CONTRACT LUMP SUM PRICE FOR "TRAFFIC CONTROL COMPLETE".
2. TRAFFIC CONTROL SHALL BE IN ACCORDANCE WITH THE APPLICABLE ARTICLES OF THE STANDARD SPECIFICATIONS, THE APPLICABLE GUIDELINES CONTAINED IN THE "MANUAL ON UNIFORM TRAFFIC CONTROL DEVICES FOR STREETS AND HIGHWAYS", THE SPECIAL PROVISIONS, THESE PLANS AND HIGHWAY STANDARDS 701006, 701311, 701501, 701606, 701701, 701801, AND 702001.
3. CHANGEABLE MESSAGE SIGNS SHALL BE INSTALLED AND OPERATIONAL FIVE DAYS PRIOR TO THE START OF ROAD CLOSURE TO ALERT THE PUBLIC OF THE UPCOMING START OF CONSTRUCTION. THE CONTRACTOR SHALL INSPECT THE MESSAGE SIGNS BY 8:00 A.M. EACH DAY TO ENSURE THAT THE SIGNS ARE FULLY OPERATIONAL AND IN PROPER WORKING ORDER. THE SIGNS SHALL BE REMOVED AT THE START OF CONSTRUCTION. [PAYMENT FOR CHANGEABLE MESSAGE SIGNS AND DAILY INSPECTION OF THE SIGNS SHALL BE INCLUDED IN THE COST OF "TRAFFIC CONTROL COMPLETE" WITH NO ADDITIONAL COMPENSATION ALLOWED.
4. THE CONTRACTOR SHALL MAINTAIN ACCESS TO ANY COMMERCIAL AND PRIVATE ENTRANCES WITHIN THE PROJECT LIMITS. ACCESS SHALL BE MAINTAINED BY CONSTRUCTING ENTRANCES IN HALF WIDTHS OR OTHER MEANS APPROVED BY THE ENGINEER. A QUANTITY OF "AGGREGATE FOR TEMPORARY ACCESS" HAS BEEN INCLUDED IN THE CONTRACT FOR ENTRANCE ACCESS.
5. TRAFFIC CONTROL DEVICES SHALL REMAIN IN PLACE UNTIL ALL SECTIONS OF THE ROADWAY ARE SUBSTANTIALLY COMPLETE. TRAFFIC CONTROL DEVICES SHALL BE REMOVED AS DIRECTED BY THE ENGINEER.
6. AT THE LOCATIONS SHOW ON THE OVERVIEW MAP THE CONTRACTOR MAY CONSTRUCT TEMPORARY PARKING AREAS TO PROVIDE TEMPORARY PARKING WHILE THE PRIVATE ENTRANCES ARE CLOSED FOR CONSTRUCTION. THIS WORK SHALL BE COORDINATED WITH THE ENGINEER.
7. PROPER DRAINAGE SHALL BE MAINTAINED AT ALL TIMES WITHIN THE PROJECT LIMITS. IT WILL BE NECESSARY TO LIMIT CONSTRUCTION OF THE PCC BASE COURSE AND CONCRETE CURB AND GUTTER AT THE LOW POINTS OF THE VERTICAL CURVES TO AVOID SURFACE PONDING ON PHILO ROAD. THE CONTRACTOR SHALL BE RESPONSIBLE FOR COORDINATING THIS WORK AND ANY CONSTRUCTION TECHNIQUES NECESSARY TO ENSURE PROPER DRAINAGE IS MAINTAINED AT ALL TIMES. [THE COST OF ALL LABOR, EQUIPMENT AND MATERIALS TO MAINTAIN PROPER DRAINAGE WILL NOT BE PAID FOR SEPARATELY BUT SHALL BE INCLUDED IN THE COST OF THE MISCELLANEOUS PAY ITEMS INVOLVED.
8. THE CONTRACTOR SHALL BE RESPONSIBLE FOR PROVIDING TRAFFIC CONTROL SURVEILLANCE FOR THIS PROJECT. THE CONTRACTOR SHALL INSPECT AND MAINTAIN ALL TRAFFIC CONTROL DEVICES AT ALL TIMES INCLUDING NIGHTTIME, WEEKENDS, WINTER SHUT-DOWN PERIOD AND ANY TIME WORKERS ARE NOT PRESENT. THIS WORK SHALL BE PERFORMED IN ACCORDANCE WITH THE SPECIAL PROVISIONS. [THE COST OF ALL LABOR AND MATERIALS FOR THE SURVEILLANCE AND MAINTENANCE OF TRAFFIC CONTROL DEVICES SHALL BE INCLUDED IN THE COST OF "TRAFFIC CONTROL COMPLETE".

TRAFFIC CONTROL STANDARDS

THE FOLLOWING TRAFFIC CONTROL STANDARDS ARE THE MINIMUM REQUIREMENTS FOR THE TRAFFIC CONTROL FOR THIS PROJECT.

STANDARD	APPLICATION
701006	WHERE VEHICLES, EQUIPMENT, WORKERS OR THEIR ACTIVITIES WILL ENCR OACH IN THE AREA 15' TO 2' FROM THE EDGE OF PAVEMENT.
701311	WHERE ANY VEHICLE, EQUIPMENT, WORKERS OR THEIR ACTIVITIES REQUIRE A CONTINUOUS MOVING OPERATION WHERE THE AVERAGE SPEED IS GREATER THAN 3 MPH.
701501	WHERE AT ANYTIME ANY VEHICLE, EQUIPMENT, WORKER OR THEIR ACTIVITIES ENCR OACH ON THE PAVEMENT REQUIRING CLOSURE OF ONE TRAFFIC LANE.
701606	WHERE AT ANYTIME ANY VEHICLE, EQUIPMENT, WORKER OR THEIR ACTIVITIES ENCR OACH ON THE PAVEMENT REQUIRING THE CLOSURE OF ONE OR MORE TRAFFIC LANES.
701701	WHERE AT ANYTIME ANY VEHICLE, EQUIPMENT, WORKER OR THEIR ACTIVITIES ENCR OACH ON THE PAVEMENT WITHIN THE VICINITY OF AN INTERSECTION.
701801	WHERE AT ANYTIME PEDESTRIAN TRAFFIC MUST BE REROUTED.
702001	ALL TRAFFIC CONTROL DEVICES