

F.A.S. RTE.	SECTION	COUNTY	TOTAL SHEETS	SHEET NO.
567	04-00027-01-PV	MASON	79	27
STA.		TO STA.		
FED. ROAD DIST. NO.		ILLINOIS FED. AID PROJECT		

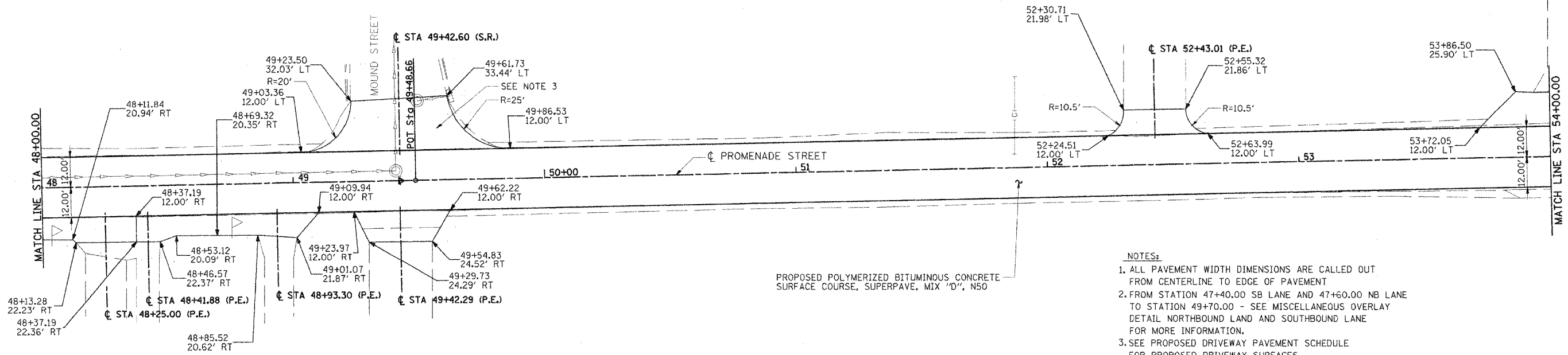

PLAN	REVIEWED	DATE
	NOTED	
	BY	
	NO.	



1. ALL PAVEMENT WIDTH DIMENSIONS ARE CALLED OUT FROM CENTERLINE TO EDGE OF PAVEMENT
2. FROM STATION 47+40.00 SB LANE AND 47+60.00 NB LANE TO STATION 49+70.00 - SEE MISCELLANEOUS OVERLAY DETAIL NORTHBOUND LANE AND SOUTHBOUND LANE FOR MORE INFORMATION.
3. SEE PROPOSED DRIVEWAY PAVEMENT SCHEDULE FOR PROPOSED DRIVEWAY SURFACES
4. SEE MISCELLANEOUS DETAIL - SIDE ROADS, ENTRANCES, AND MAILBOX TURNOUTS FOR SIDE ROAD, MAILBOX, AND ENTRANCE CONSTRUCTION

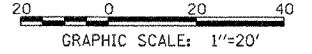

PROFILE	REVIEWED	DATE
	NOTED	
	BY	
	NO.	

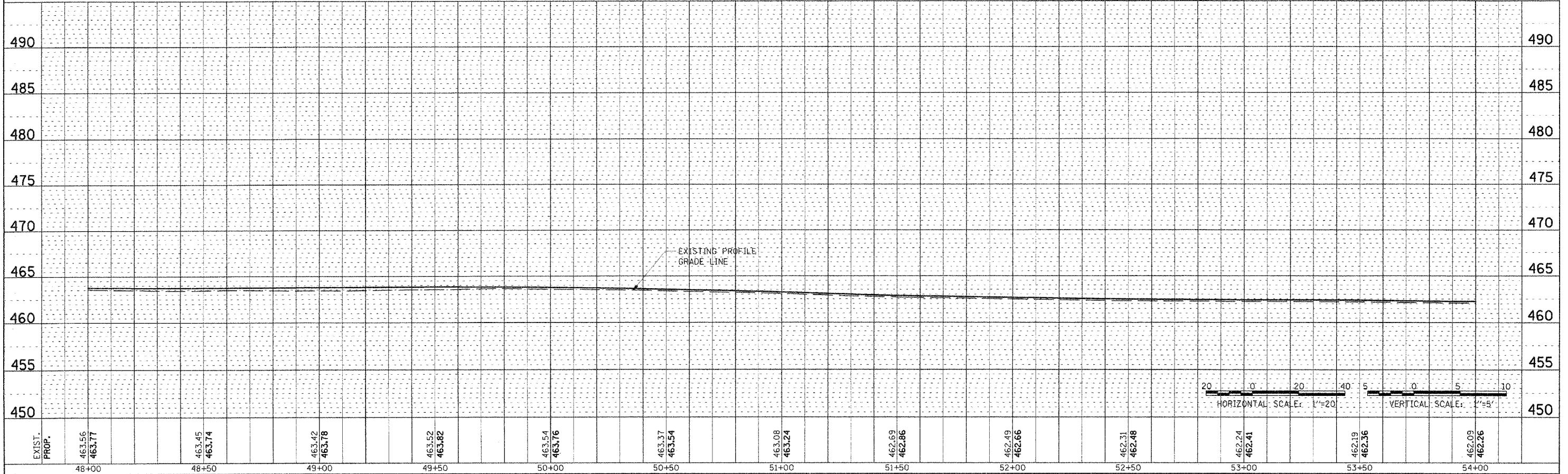

LAYOUT	NET	8/01/05
DRAWN	TCJ	1/24/06
REVIEWED	RXC	2/03/06