

F.A.S. RTE.	SECTION	COUNTY	TOTAL SHEETS	SHEET NO.
567	04-00027-01-PV	MASON	79	29
STA.		TO STA.		
FED. ROAD DIST. NO.	ILLINOIS	FED. AID PROJECT		

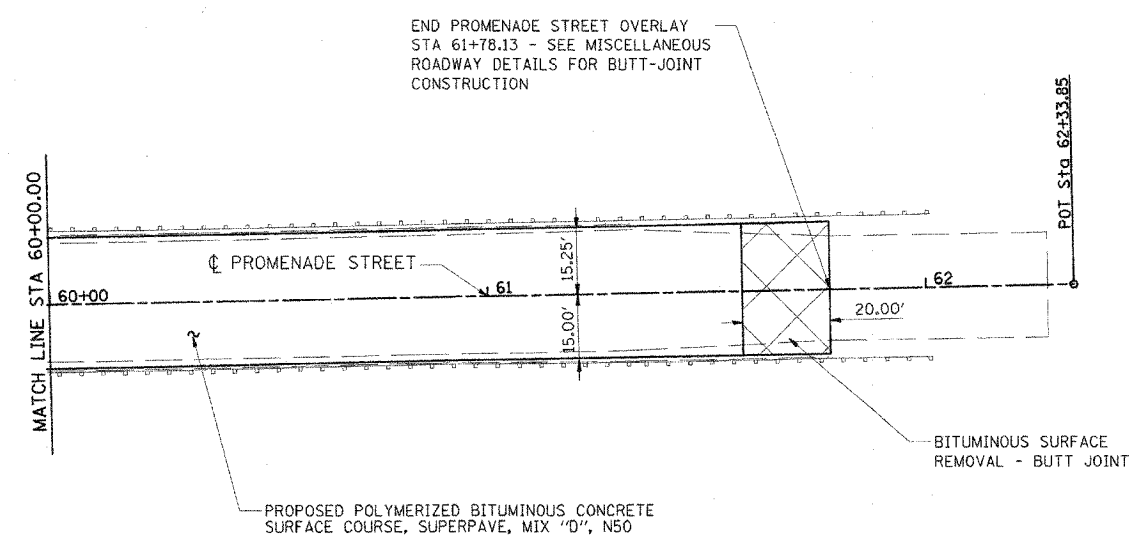

NOTES:
 1. ALL PAVEMENT WIDTH DIMENSIONS ARE CALLED OUT FROM CENTERLINE TO EDGE OF PAVEMENT

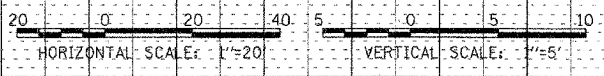
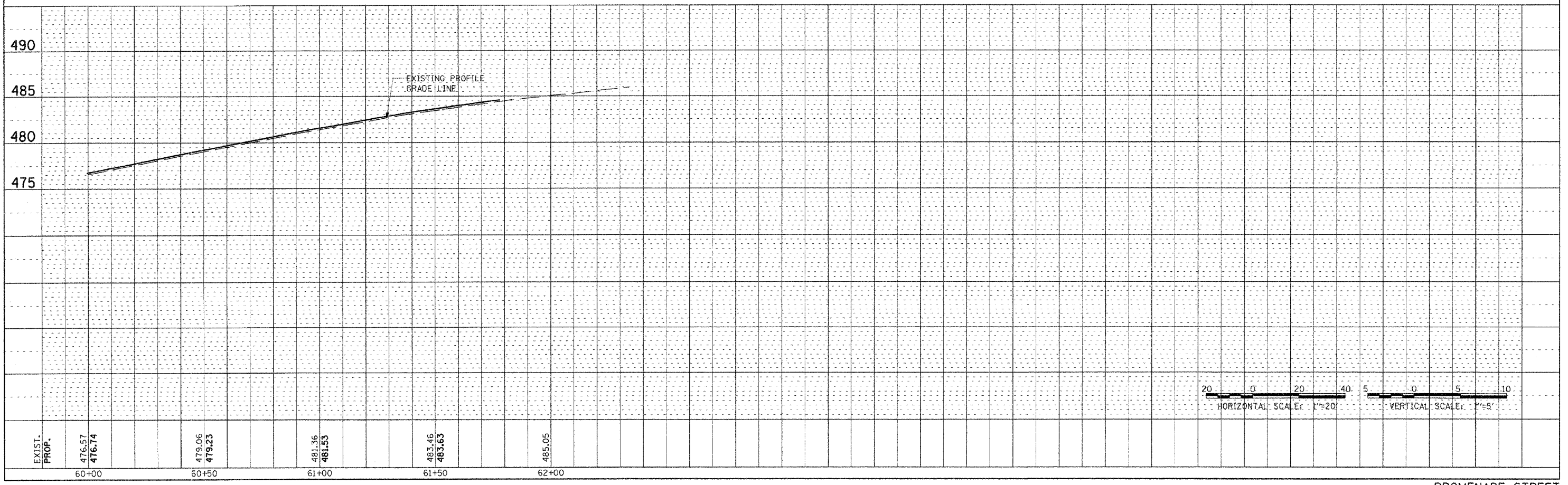
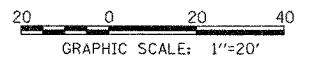

PLAN	DESIGNED	DATE
	BY	
	CHECKED	
	DATE	
	BY	
	CHECKED	
	DATE	
	BY	
	CHECKED	
	DATE	

PROFILE	DESIGNED	DATE
	BY	
	CHECKED	
	DATE	
	BY	
	CHECKED	
	DATE	
	BY	
	CHECKED	
	DATE	

LAYOUT	KET	8/04/05
DRAWN	JLW	8/10/05
REVIEWED	RXC	11/7/05
EXIST. PROP.		
476.57	476.74	
479.06	479.23	
481.36	481.53	
483.46	483.63	
485.05		

12/04/05 AM
 02/02/2006, 10:04 AM
 9/1/05