

F.A.S. RTE.	SECTION	COUNTY	TOTAL SHEETS	SHEET NO.
567	04-00027-01-PV	MASON	79	38
STA.		TO STA.		
FED. ROAD DIST. NO.		ILLINOIS FED. AID PROJECT		

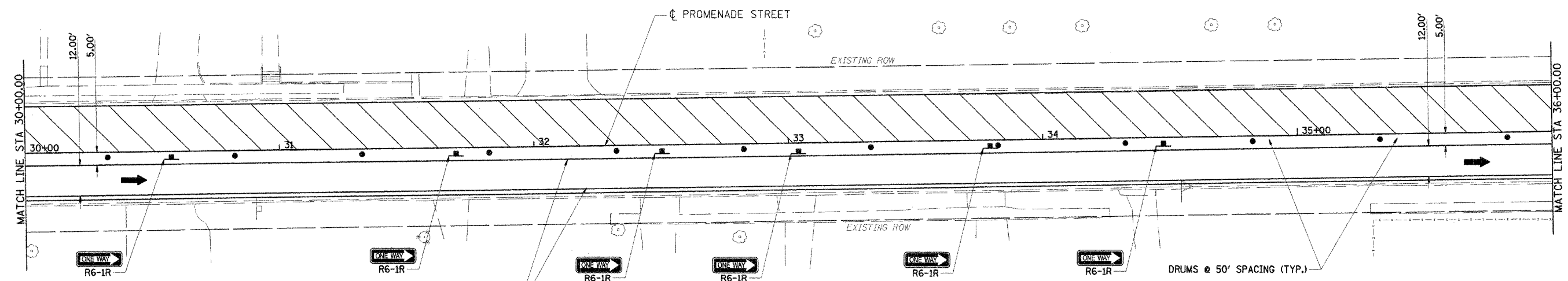

- LEGEND**
- WORK ZONE
 - TRAFFIC MOVEMENT
 - TYPE III BARRICADE
 - DRUMS OR TYPE II BARRICADES

TEMPORARY PAINT PAVEMENT MARKING LINE - 4"

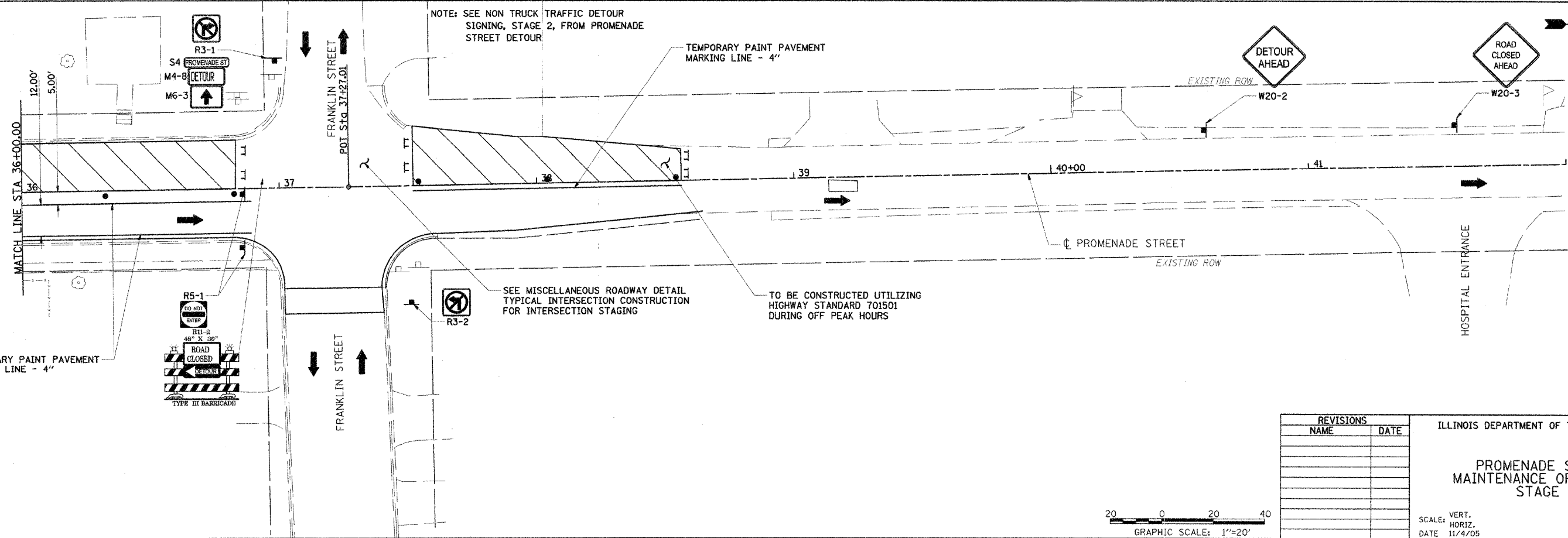
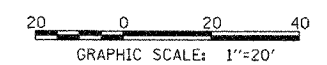

NOTE: SEE NON TRUCK TRAFFIC DETOUR SIGNING, STAGE 2, FROM PROMENADE STREET DETOUR

TEMPORARY PAINT PAVEMENT MARKING LINE - 4"

SEE MISCELLANEOUS ROADWAY DETAIL TYPICAL INTERSECTION CONSTRUCTION FOR INTERSECTION STAGING

TO BE CONSTRUCTED UTILIZING HIGHWAY STANDARD 701501 DURING OFF PEAK HOURS

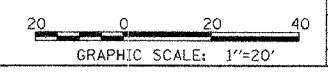

REVISIONS	
NAME	DATE

ILLINOIS DEPARTMENT OF TRANSPORTATION

PROMENADE STREET MAINTENANCE OF TRAFFIC STAGE 2

SCALE: VERT. 1"=20'
HORIZ. 1"=20'
DATE 11/4/05

DRAWN BY JLW
CHECKED BY RXC

STA 30+00 TO STA 42+00

0:57:24 AM 8/19/07 AM
20:05:28 8/19/07 AM
8/19/07 AM

LAYOUT	KET	8/04/05
DRAWN	TCJ	1/26/06
REVIEWED	RXC	2/03/06