

FA ROUTE	SECTION	COUNTY	TOTAL SHEETS	SHEET NO.
04-0021-01-PV		SANGAMON	79	42
STA.	TO STA.			
FED. ROAD DIST. NO. ILLINOIS	FED. AID PROJECT			

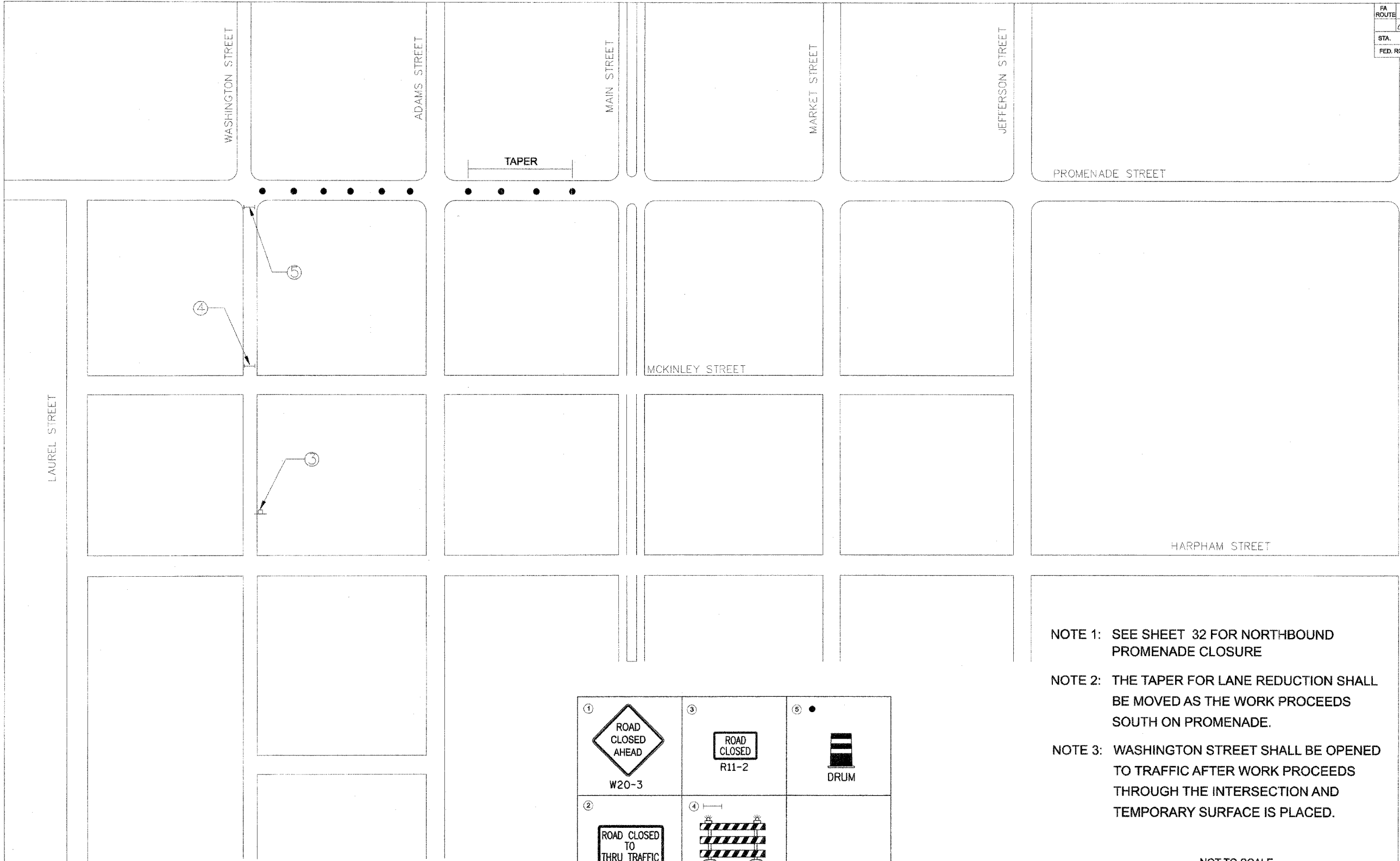

- NOTE 1: SEE SHEET 32 FOR NORTHBOUND PROMENADE CLOSURE
- NOTE 2: THE TAPER FOR LANE REDUCTION SHALL BE MOVED AS THE WORK PROCEEDS SOUTH ON PROMENADE.
- NOTE 3: WASHINGTON STREET SHALL BE OPENED TO TRAFFIC AFTER WORK PROCEEDS THROUGH THE INTERSECTION AND TEMPORARY SURFACE IS PLACED.

① ROAD CLOSED AHEAD W20-3	③ ROAD CLOSED R11-2	⑤ ● DRUM
② ROAD CLOSED TO THRU TRAFFIC R-11-4	④ TYPE III BARRICADE W/ FLASHING LIGHT	

NOT TO SCALE

REVISIONS	
NAME	DATE

ILLINOIS DEPARTMENT OF TRANSPORTATION

**PROMENADE STREET (C.H. 20)
STORM SEWER
PROMENADE LANE CLOSURE**

SCALE: VERT. _____
HORIZ. _____
DATE 11/18/05

DRAWN BY JLA
CHECKED BY RXC

02/07/2006, 04:09 PM \$FILE\$

LAYOUT	JLA	11/18/05
DRAWN	ECJ	11/27/05
REVIEWED	REC	12/03/05

US 136