

F.A.S. RTE.	SECTION	COUNTY	TOTAL SHEETS	SHEET NO.
567	04-00027-01-PV	MASON	79	56
STA.		TO STA.		
FED. ROAD DIST. NO.	ILLINOIS	FED. AID PROJECT		

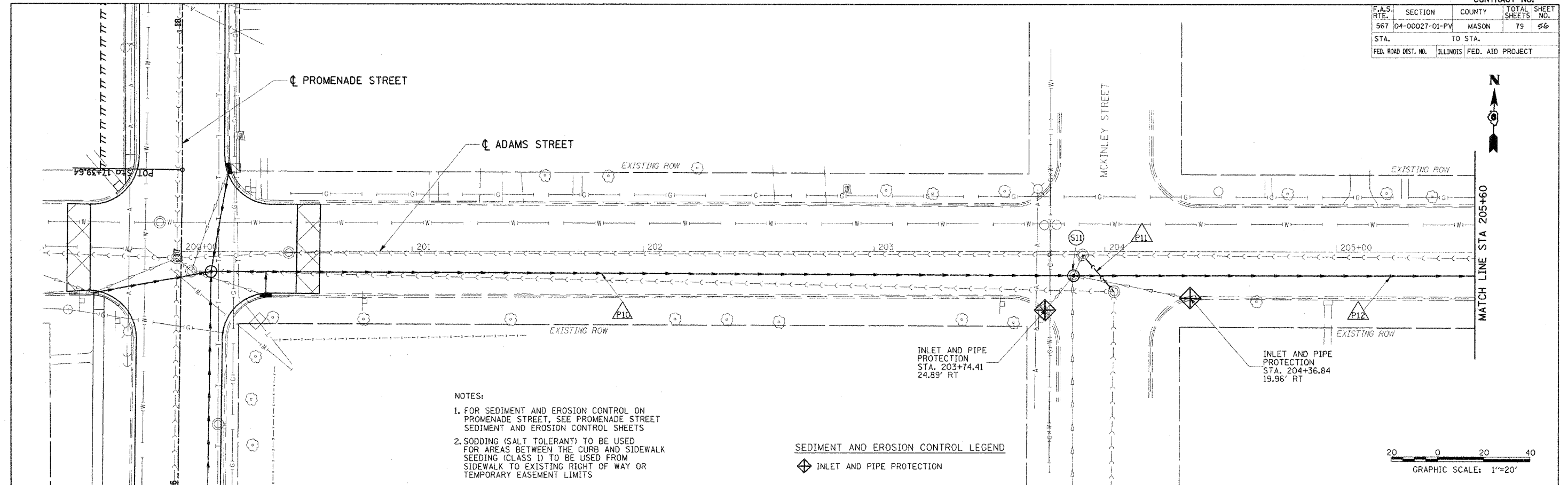

- NOTES:
1. FOR SEDIMENT AND EROSION CONTROL ON PROMENADE STREET, SEE PROMENADE STREET SEDIMENT AND EROSION CONTROL SHEETS
 2. SODDING (SALT TOLERANT) TO BE USED FOR AREAS BETWEEN THE CURB AND SIDEWALK SEEDING (CLASS I) TO BE USED FROM SIDEWALK TO EXISTING RIGHT OF WAY OR TEMPORARY EASEMENT LIMITS

SEDIMENT AND EROSION CONTROL LEGEND

◆ INLET AND PIPE PROTECTION

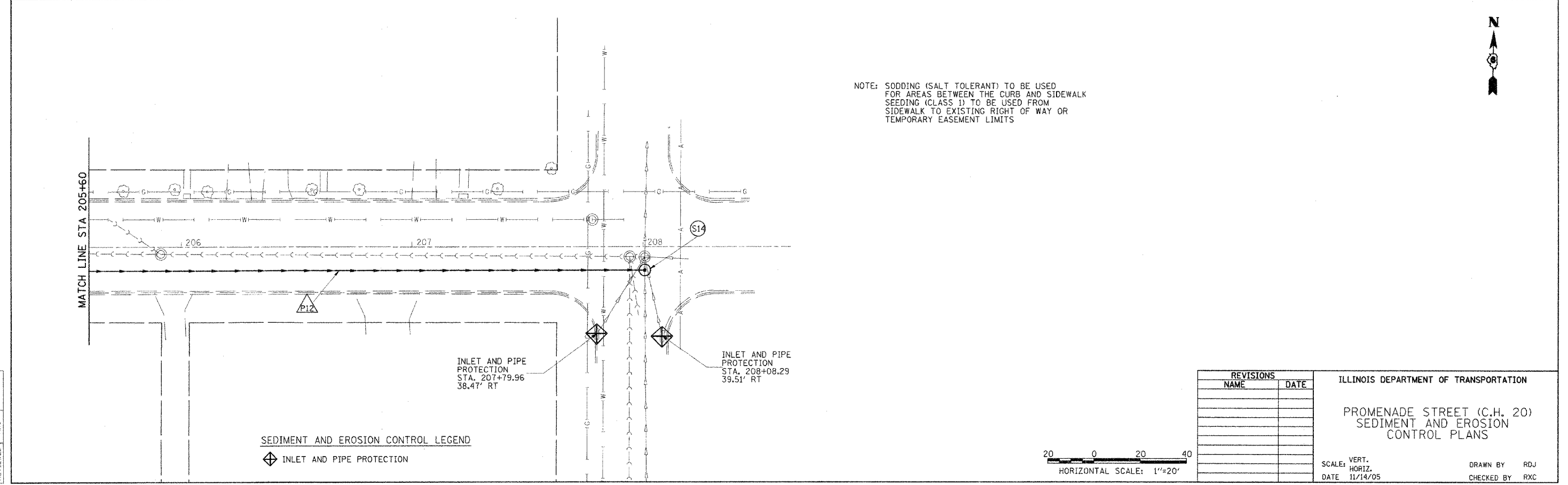
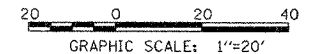

- NOTE: SODDING (SALT TOLERANT) TO BE USED FOR AREAS BETWEEN THE CURB AND SIDEWALK SEEDING (CLASS I) TO BE USED FROM SIDEWALK TO EXISTING RIGHT OF WAY OR TEMPORARY EASEMENT LIMITS

SEDIMENT AND EROSION CONTROL LEGEND

◆ INLET AND PIPE PROTECTION

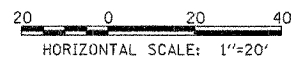

REVISIONS	
NAME	DATE

ILLINOIS DEPARTMENT OF TRANSPORTATION

PROMENADE STREET (C.H. 20)
SEDIMENT AND EROSION
CONTROL PLANS

SCALE: VERT. _____
HORIZ. _____
DATE 11/14/05

DRAWN BY RDJ
CHECKED BY RXC

3:45:49 PM	8/24/05	831.35 PM
#FILE#	KET	B/04/05
	RDJ	11/14/05
	RXC	11/18/05