

F.A.S. RTE.	SECTION	COUNTY	TOTAL SHEETS	SHEET NO.
567	04-00027-01-PV	MASON	79	64
STA.	TO STA.			
FED. ROAD DIST. NO.	ILLINOIS	FED. AID PROJECT		

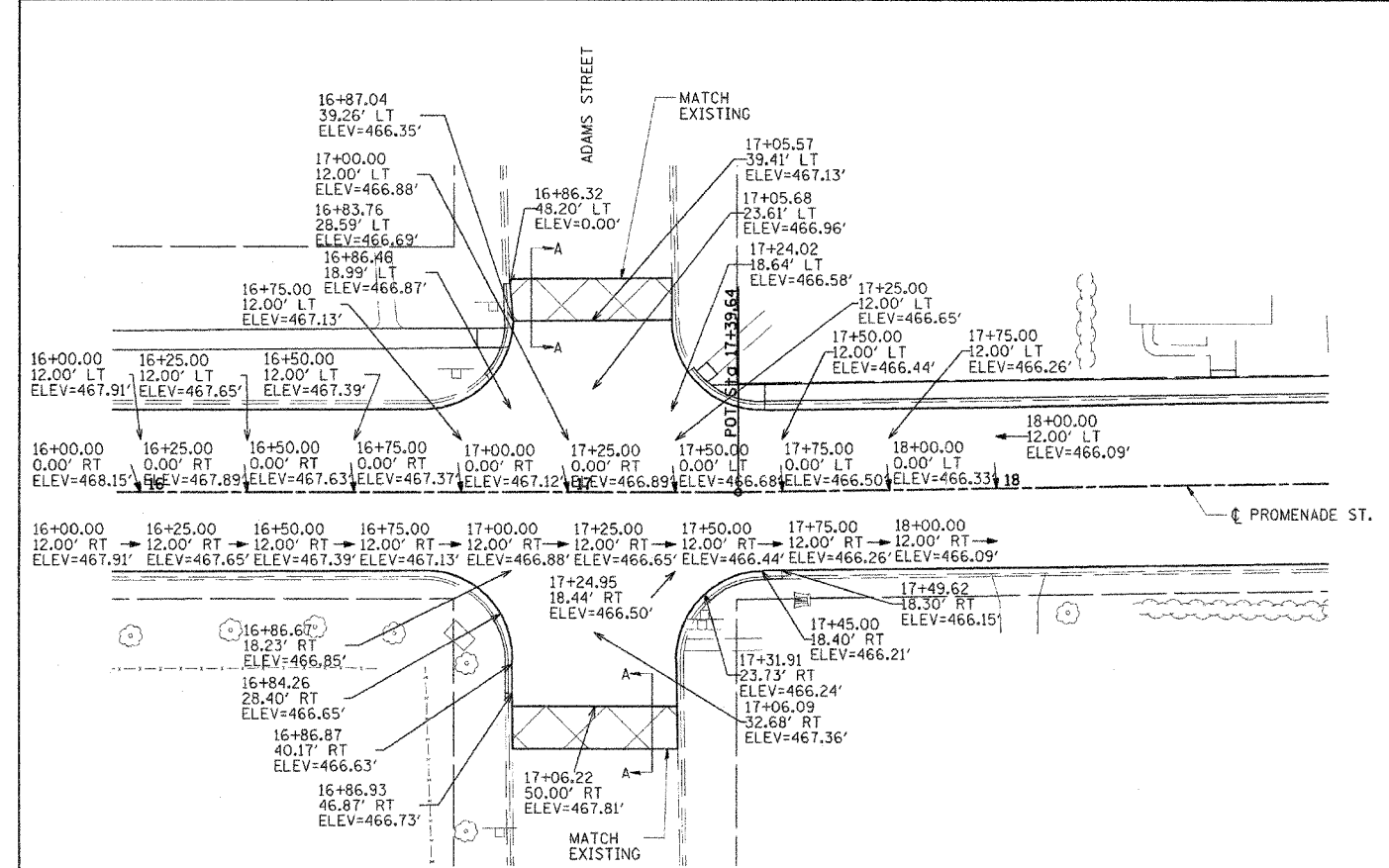

ELEVATION PLAN

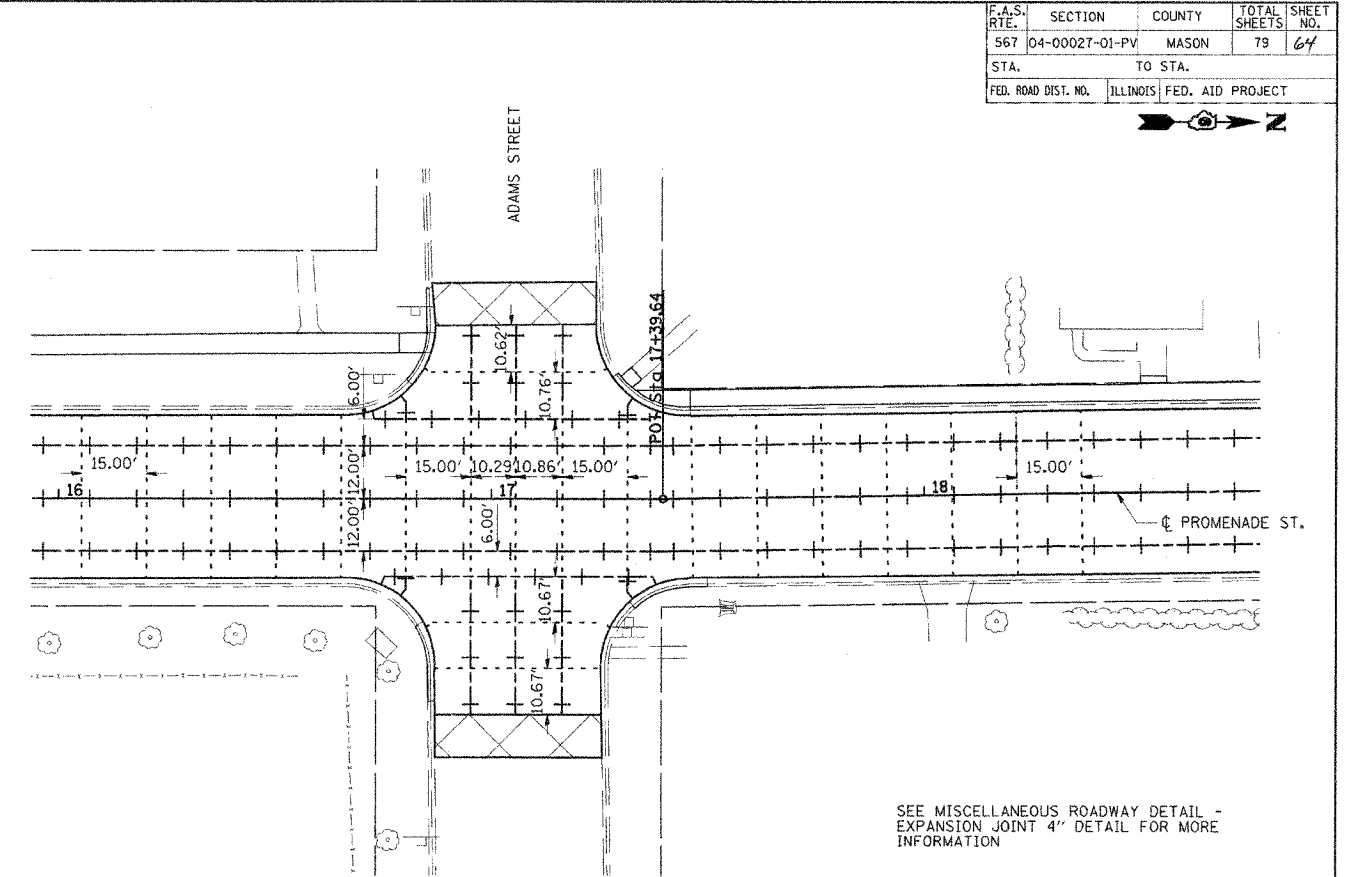

JOINTING PLAN

SEE MISCELLANEOUS ROADWAY DETAIL - EXPANSION JOINT 4" DETAIL FOR MORE INFORMATION

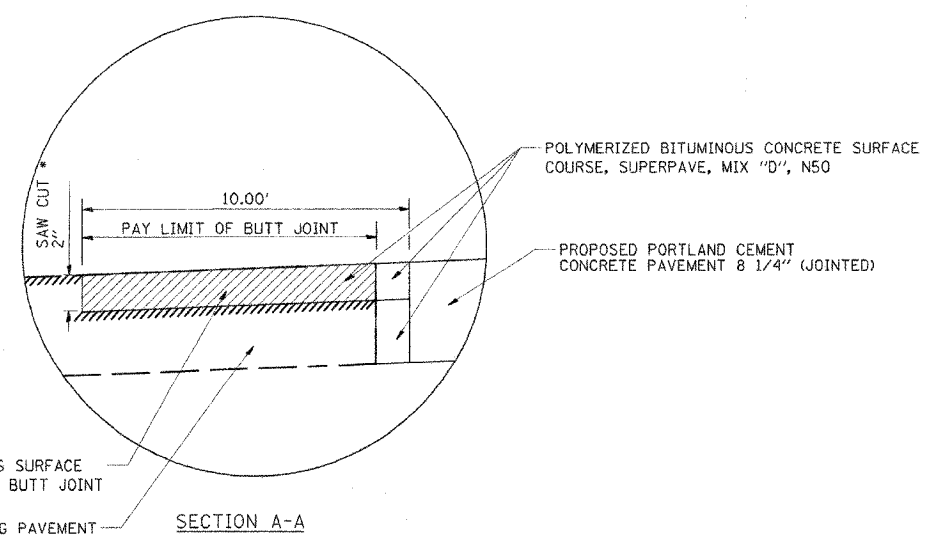

BUTT JOINT DETAIL

\* SAW CUT TO BE INCLUDED IN COST OF BITUMINOUS SURFACE REMOVAL - BUTT JOINT

LEGEND

- +--- LONGITUDINAL CONSTRUCTION JOINT
- DOWELED TRANSVERSE CONTRACTION JOINT

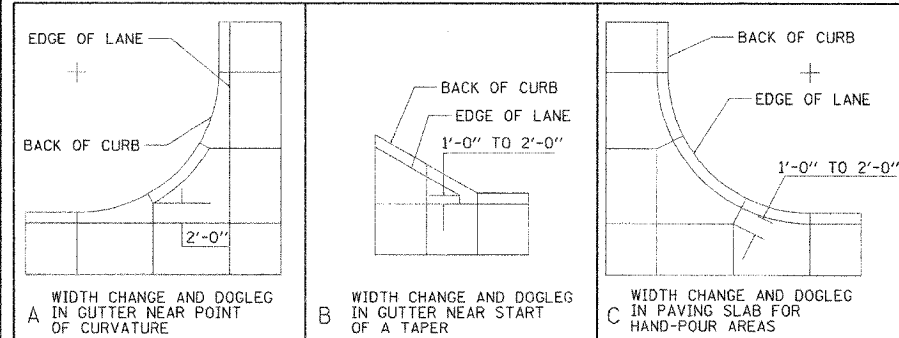

REVISIONS	
NAME	DATE

NOT TO SCALE  
 ILLINOIS DEPARTMENT OF TRANSPORTATION  
 PROMENADE STREET (C.H. 20)  
 JOINTING, ELEVATION AND  
 BUTT JOINT DETAIL  
 SCALE: VERT. 1"=10'  
 HORIZ. 1"=40'  
 DATE 11/8/05  
 DRAWN BY JLW  
 CHECKED BY RXC

3:35:15 PM  
 02/01/2006 02:35 PM  
 #FILED  
 LAYOUT KET R/04/05  
 DRAWN TCI 1/24/06  
 REVIEWED RXC 2/03/06