

F.A.S. RTE.	SECTION	COUNTY	TOTAL SHEETS	SHEET NO.
567	04-00027-01-PV	MASON	79	66
STA.		TO STA.		
FED. ROAD DIST. NO.		ILLINOIS	FED. AID PROJECT	

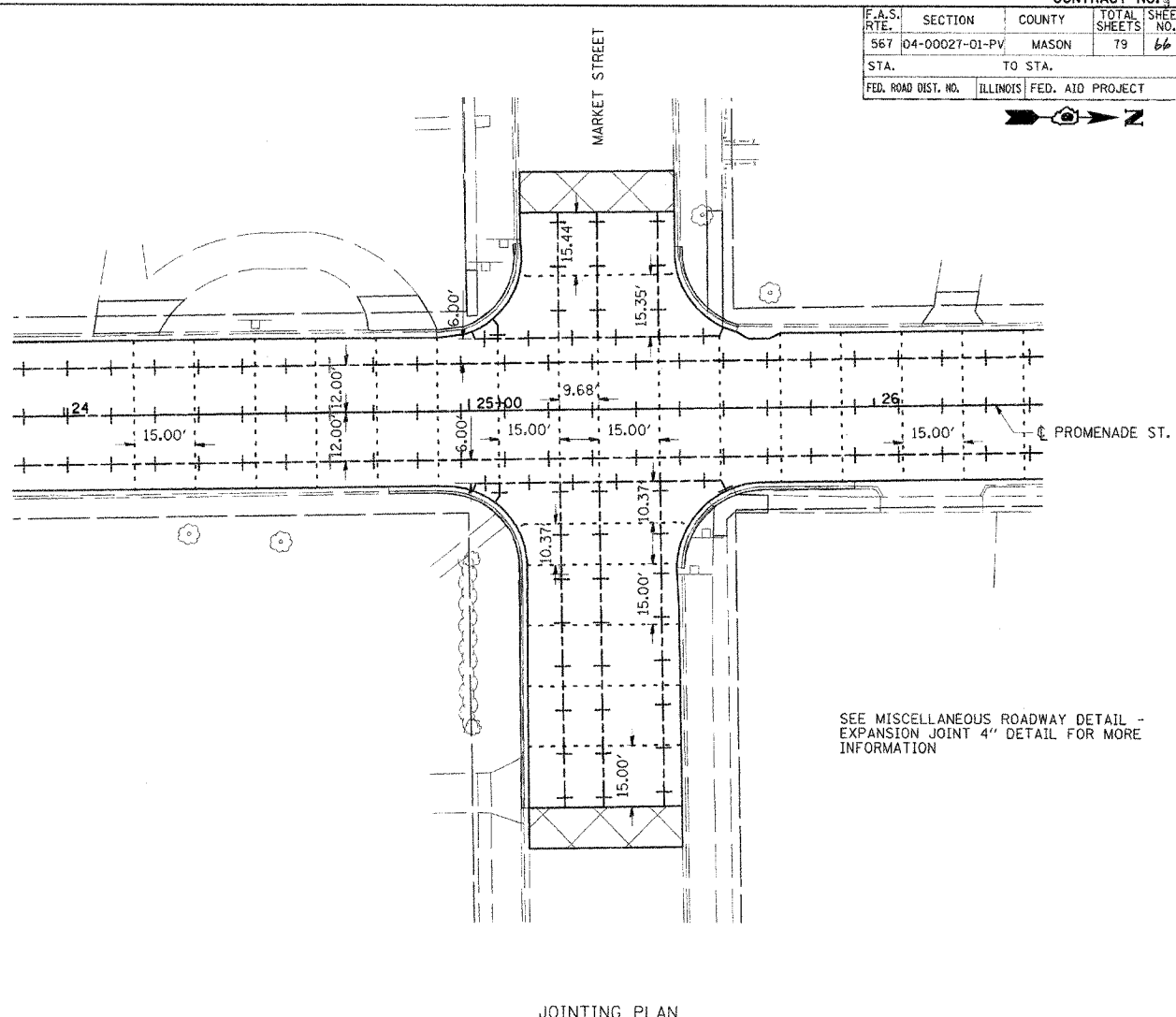

SEE MISCELLANEOUS ROADWAY DETAIL - EXPANSION JOINT 4" DETAIL FOR MORE INFORMATION

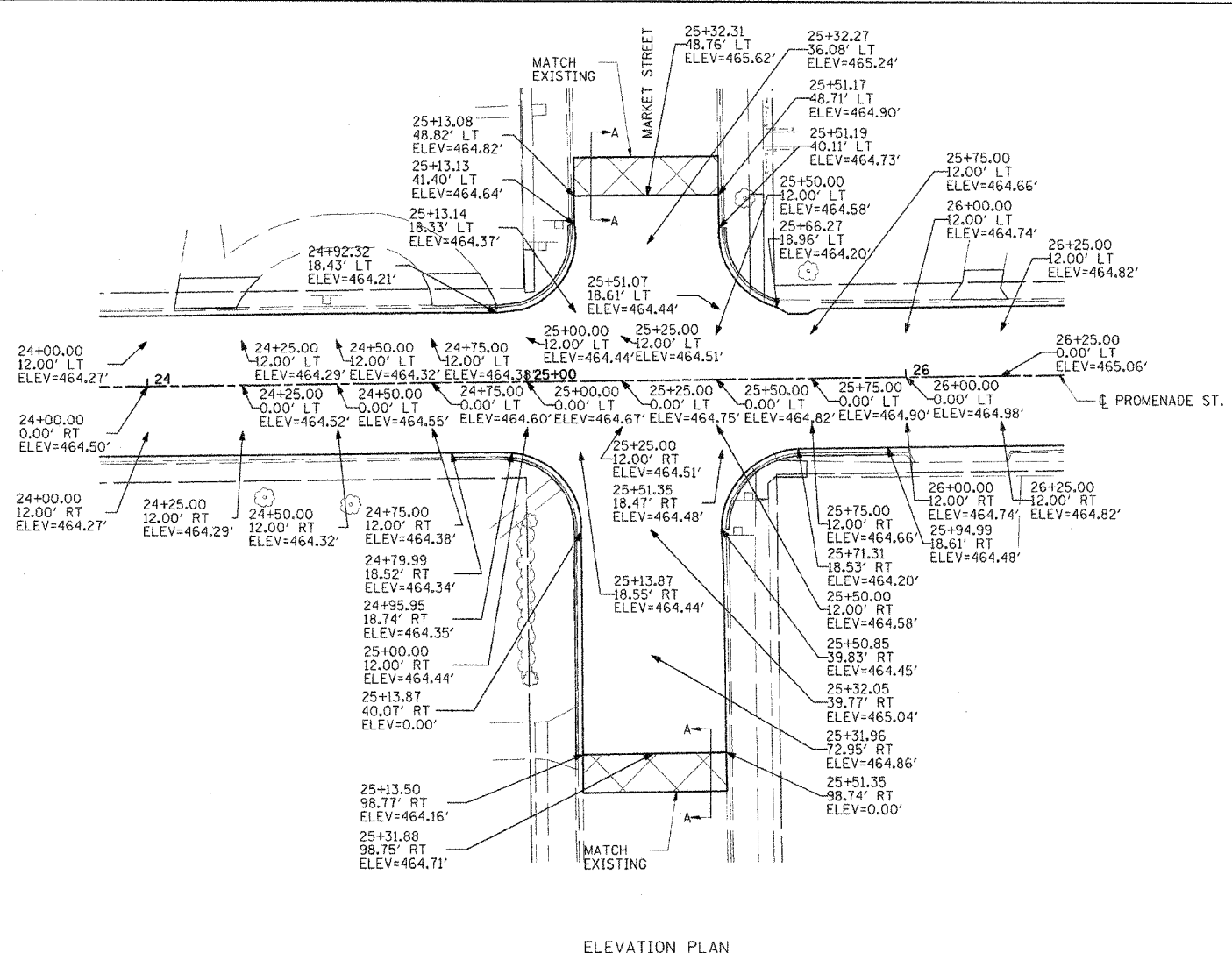
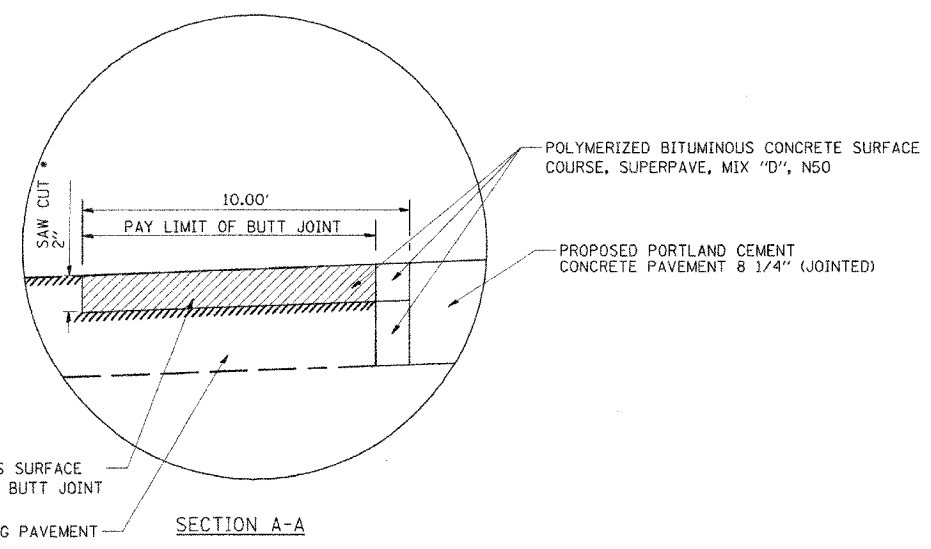

\* SAW CUT TO BE INCLUDED IN COST OF BITUMINOUS SURFACE REMOVAL - BUTT JOINT

- LEGEND**
- +--- LONGITUDINAL CONSTRUCTION JOINT
  - DOWELED TRANSVERSE CONTRACTION JOINT

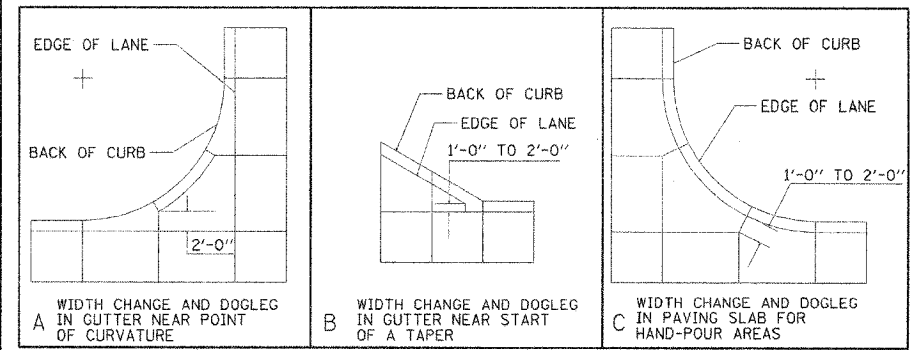

REVISIONS	
NAME	DATE

ILLINOIS DEPARTMENT OF TRANSPORTATION

PROMENADE STREET (C.H. 20)  
JOINTING, ELEVATION AND  
BUTT JOINT DETAIL

SCALE: VERT. 1"=4'  
HORIZ. 1"=20'  
DATE 11/8/05

DRAWN BY JLW  
CHECKED BY RXC

31-351107.PLT  
 02/12/11 2:06PM  
 8/1/05 PM  
 02/12/11 2:06PM  
 8/1/05 PM  
 02/12/11 2:06PM  
 8/1/05 PM