

F.A.E. RTE.	SECTION	COUNTY	TOTAL SHEETS	SHEET NO.
	18Z & 18Y, RS 28Z	MARION	222	104
STA.	TO STA.			
DOT DIST. NO. 7	ILLINOIS FED. AID PROJECT			
CONTRACT NO. 94700				

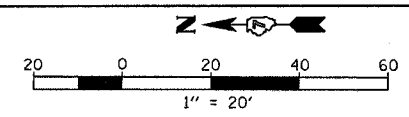

* SEAL BOTH ENDS OF CASING WATER TIGHT. CASING PIPE TO HAVE MINIMUM YIELD STRENGTH OF 35,000 PSI. WALL THICKNESS TO BE A MINIMUM OF 0.875" FOR COATED PIPE AND 0.938" FOR UNPROTECTED PIPE.

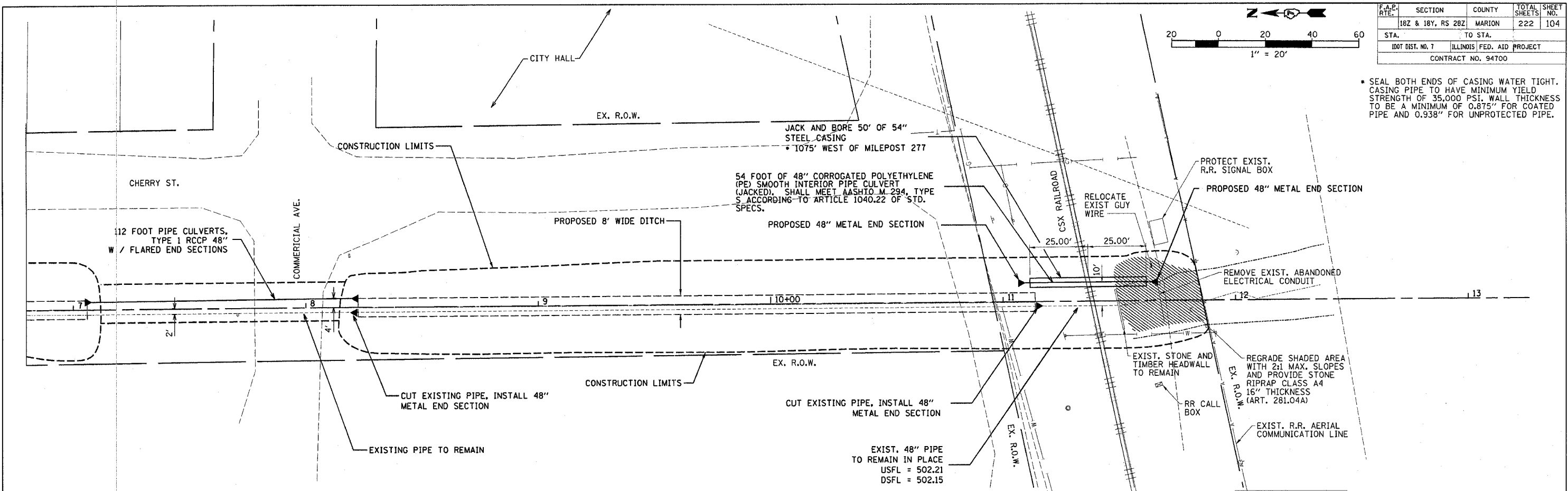

WATERWAY INFORMATION

2 48" CULVERTS UNDER COMMERCIAL AVE. STA. 478+04 OFF. 561' LT									
FLOOD	FREQ. YRS.	Q C.F.S.	OPENING SQ. FT.		NAT. H.W.E.	HEAD - FT.		HEADWATER EL.	
			EXIST.	PROP.		EXIST.	PROP.	EXIST.	PROP.
DESIGN	50		12.57	25.14					
BASE	100		12.57	25.14					
OVERTOPPING									
MAX. CALC.	500		12.57	25.14					

WATERWAY INFORMATION

2 48" CULVERTS UNDER CSX RAILROAD STA. 477+72 OFF. 904' LT									
FLOOD	FREQ. YRS.	Q C.F.S.	OPENING SQ. FT.		NAT. H.W.E.	HEAD - FT.		HEADWATER EL.	
			EXIST.	PROP.		EXIST.	PROP.	EXIST.	PROP.
DESIGN	50	54	12.57	25.14	504.39	3.50	1.08	507.89	505.47
BASE	100	60	12.57	25.14	504.40	4.27	1.29	508.67	505.69
OVERTOPPING									
MAX. CALC.	500	74	12.57	25.14	504.72	5.74	1.43	510.46	506.15

PLAN
 SURVEYED BY: _____ DATE: _____
 DESIGNED BY: _____
 CHECKED BY: _____
 IN CHARGE BY: _____
 NO. OF WAYS CHECKED: _____
 ADD FILE NAME: _____

PROFILE
 SURVEYED BY: _____ DATE: _____
 DESIGNED BY: _____
 CHECKED BY: _____
 IN CHARGE BY: _____
 NO. OF WAYS CHECKED: _____
 STRUCTURE NOTATION: _____

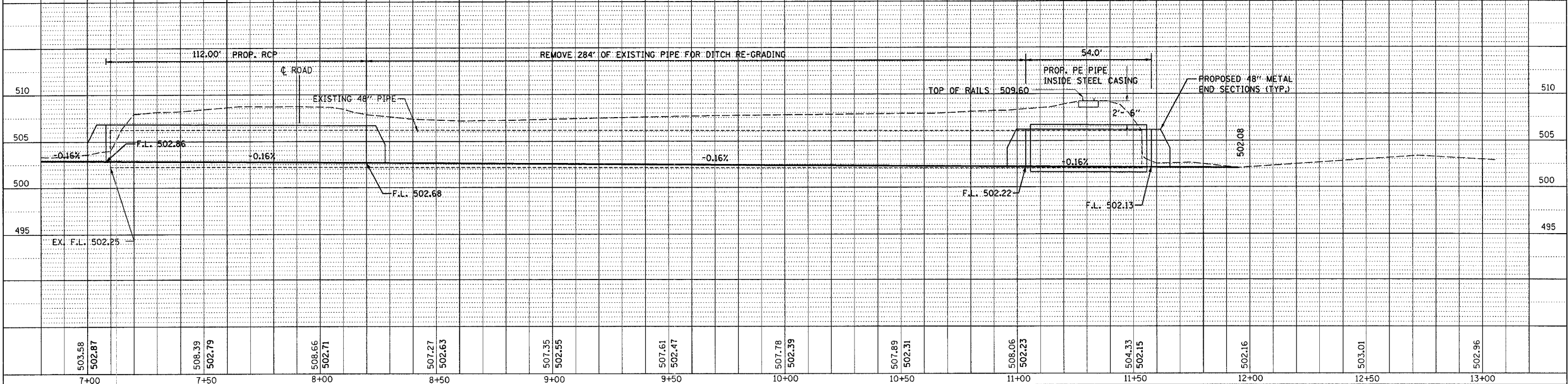

Revised 3/28/06