

F.A.P. NO.	SECTION	COUNTY	TOTAL SHEETS
327	182 & 187, RS 282	MARION	222
STA.	TO STA.		106
DOT DIST. NO. 7	ILLINOIS FED. AID PROJECT		
CONTRACT NO. 94700			

WATERWAY INFORMATION									
3 24" CULVERT UNDER CSX RAILROAD STA. 503+17 OFF. 1254' LT									
FLOOD	FREQ. YRS.	Q C.F.S.	OPENING SQ. FT.		NAT. H.W.E.	HEAD - FT.		HEADWATER EL.	
			EXIST.	PROP.		EXIST.	PROP.	EXIST.	PROP.
DESIGN	50	37	3.14	12.57	504.42	3.51	0.70	507.93	505.12
BASE	100	41	3.14	12.57	504.49		0.88	N/A	505.37
OVERTOPPING									
MAX. CALC.	500	49	3.14	12.57	505.61		0.93	N/A	505.54

* SEAL BOTH ENDS OF CASINGS WATER TIGHT. CASING PIPE TO HAVE MINIMUM YIELD STRENGTH OF 35,000 PSI. WALL THICKNESS TO BE A MINIMUM OF .375" FOR COATED PIPE AND .438" FOR UNPROTECTED PIPE.

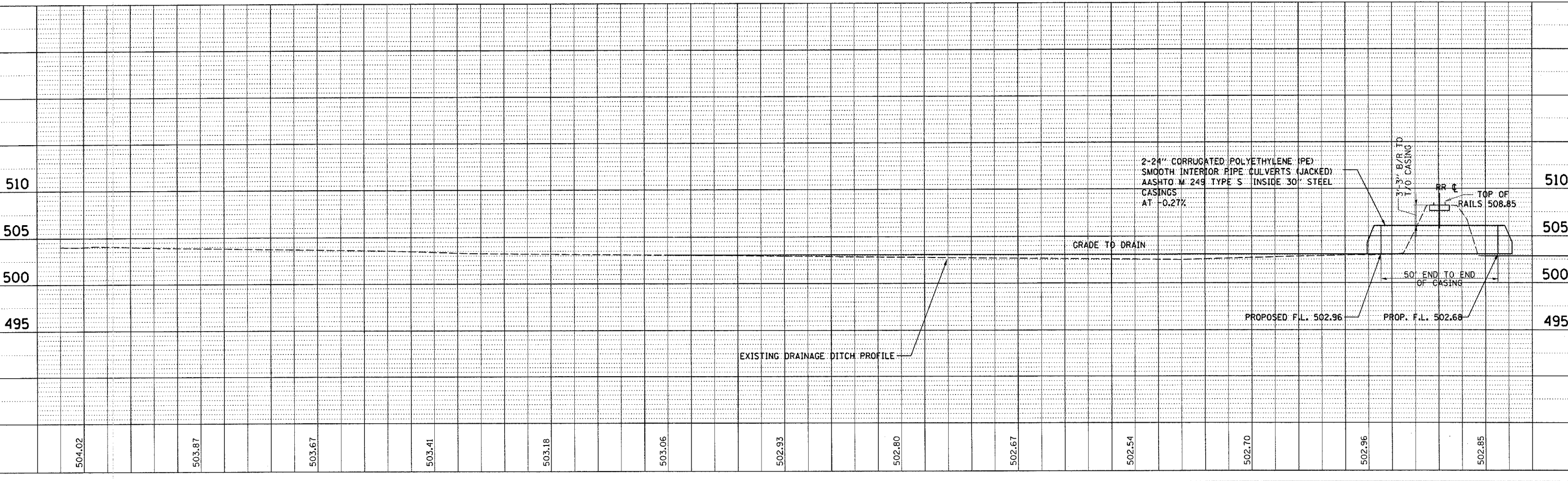
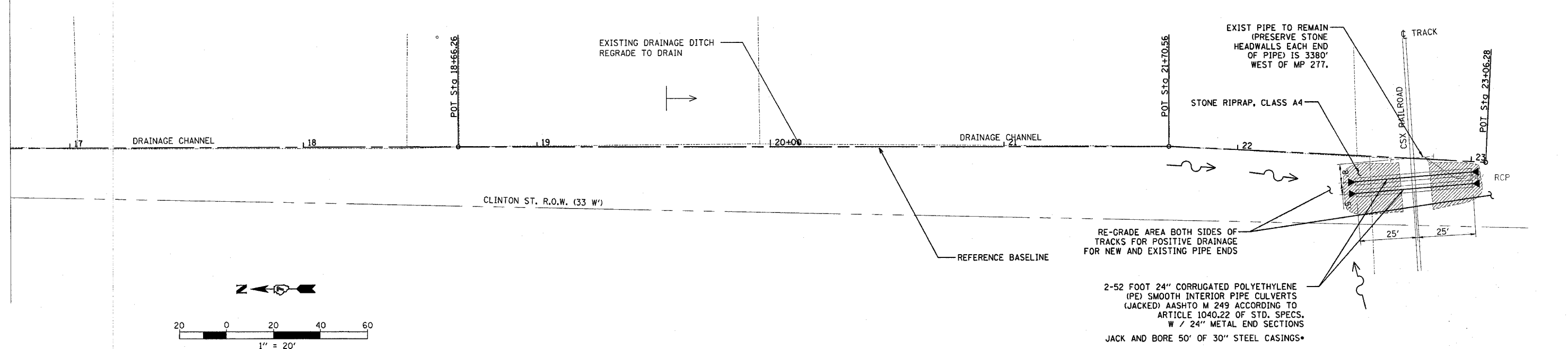

Revised 3/28/06

DATE: _____
BY: _____
SUPERVISOR: _____
CHECKED: _____
NO. _____

DATE: _____
BY: _____
SUPERVISOR: _____
CHECKED: _____
NO. _____