

ORIGINAL SURVEY	SURVEYED	BY	DATE
NOTE BOOK	PLOTTED		
NO.	TEMPLATE		
	AREAS CHECKED		

FINAL SURVEY	SURVEYED	BY	DATE
NOTE BOOK	PLOTTED		
NO.	TEMPLATE		
	AREAS CHECKED		

F.A.P. RTE.	SECTION	COUNTY	TOTAL SHEETS	SHEET NO.
327	182 & 18Y, RS 28Z	MARION	222	148
STA.	TO STA.			
FED. ROAD DIST. NO.	ILLINOIS	FED. AID PROJECT		

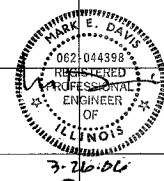
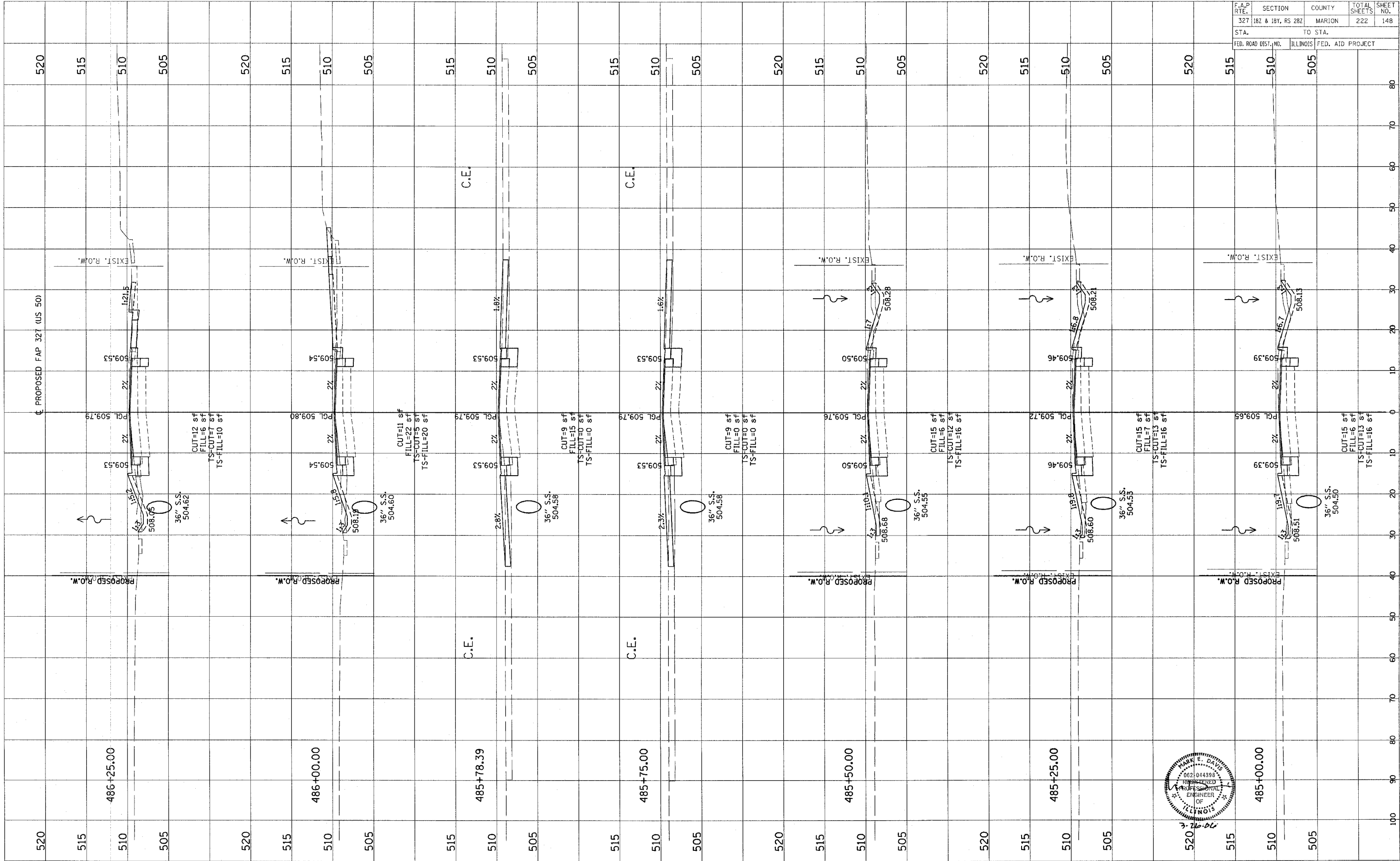

CONTRACT NO. 94700

Revised 3/28/06